



# Tangerine

Batumi

An aerial satellite photograph of the coastal city of Batumi and the inland town of Tseretse. The city of Batumi is densely packed with buildings and is situated along the coast of the Black Sea. The town of Tseretse is located inland, surrounded by green hills and fields. A white line with an orange arrowhead points from the label 'TANGERINE' to a specific location in Tseretse. The word 'BATUMI' is written in large white letters across the city, and 'TANGERINE' is written in large white letters below the town. The word 'NAPR' is repeated in small white letters across the landscape.

BATUMI

TANGERINE



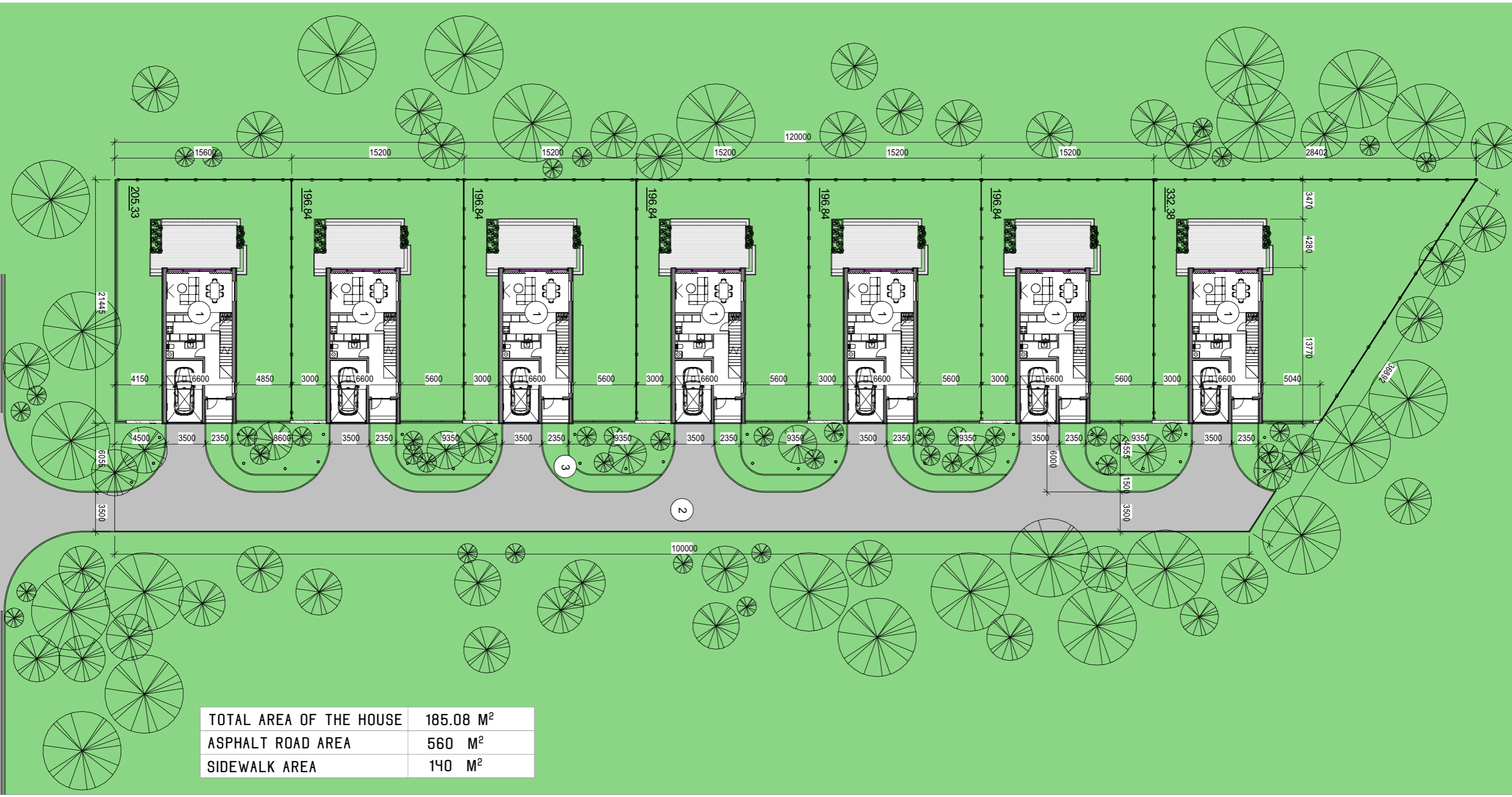

TOTAL AREA OF THE HOUSE	185.08 M <sup>2</sup>
ASPHALT ROAD AREA	560 M <sup>2</sup>
SIDEWALK AREA	140 M <sup>2</sup>









30







