

# PARTS LIST

**MODEL 1000-1  
BEGINNING WITH  
#96-06-15115-1**

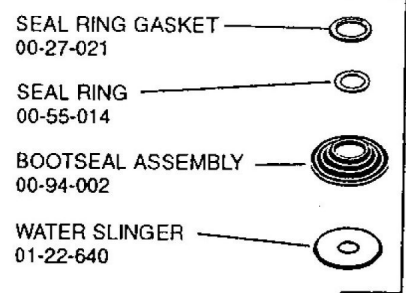

**SEAL KIT  
00-94-073**

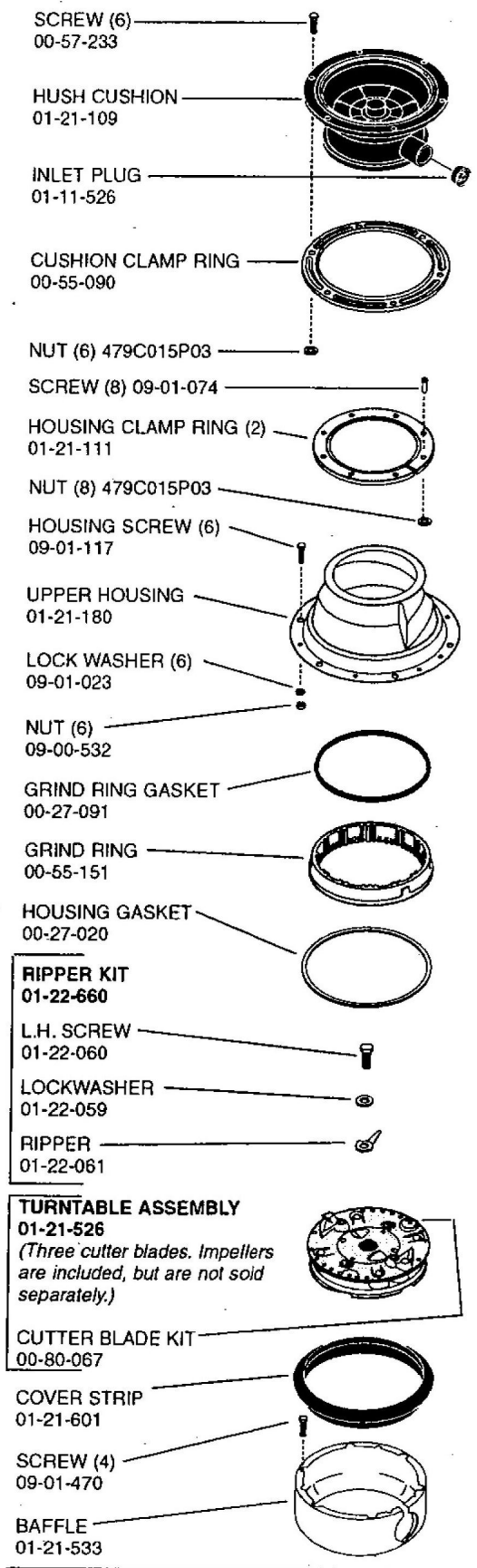
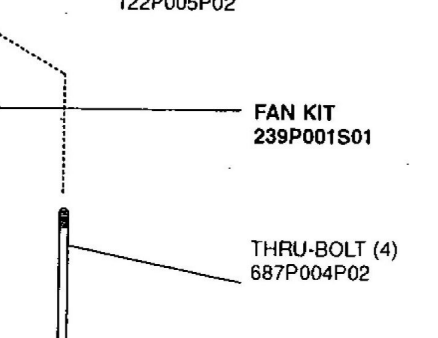
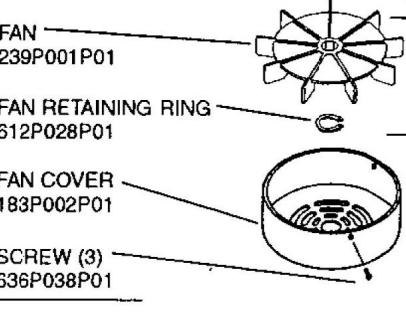
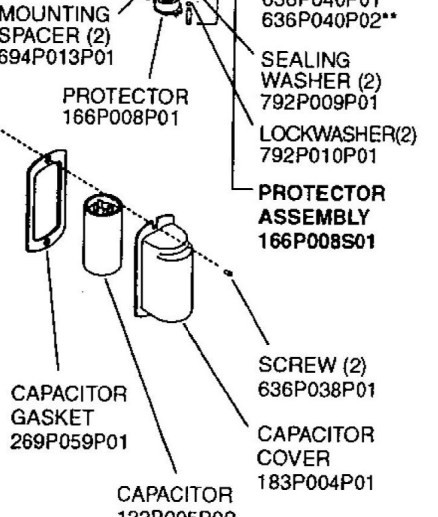
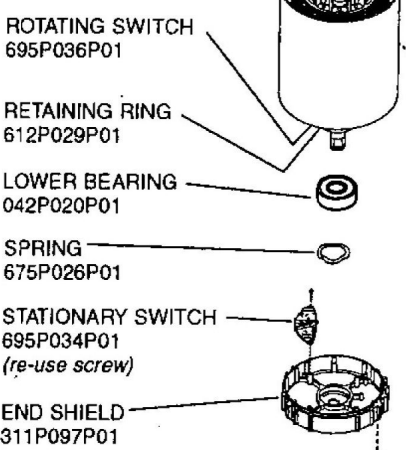
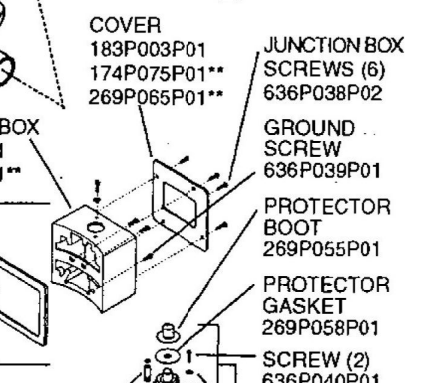
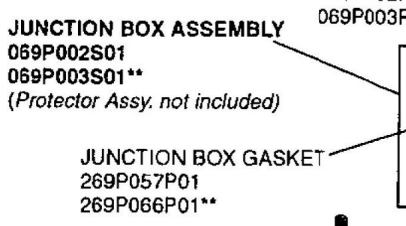
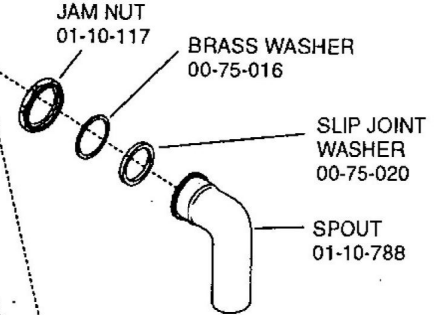
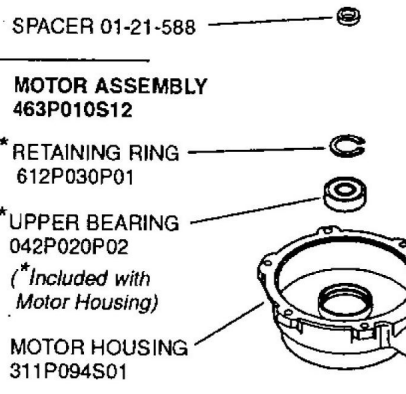

**NUMBERED PARTS AVAILABLE SEPARATELY** \*\*For stamped steel box effective 2/14/00

# PARTS LIST

**MODEL 1000-3  
BEGINNING WITH  
#96-06-15117-1**

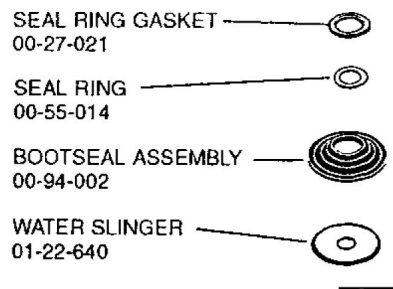
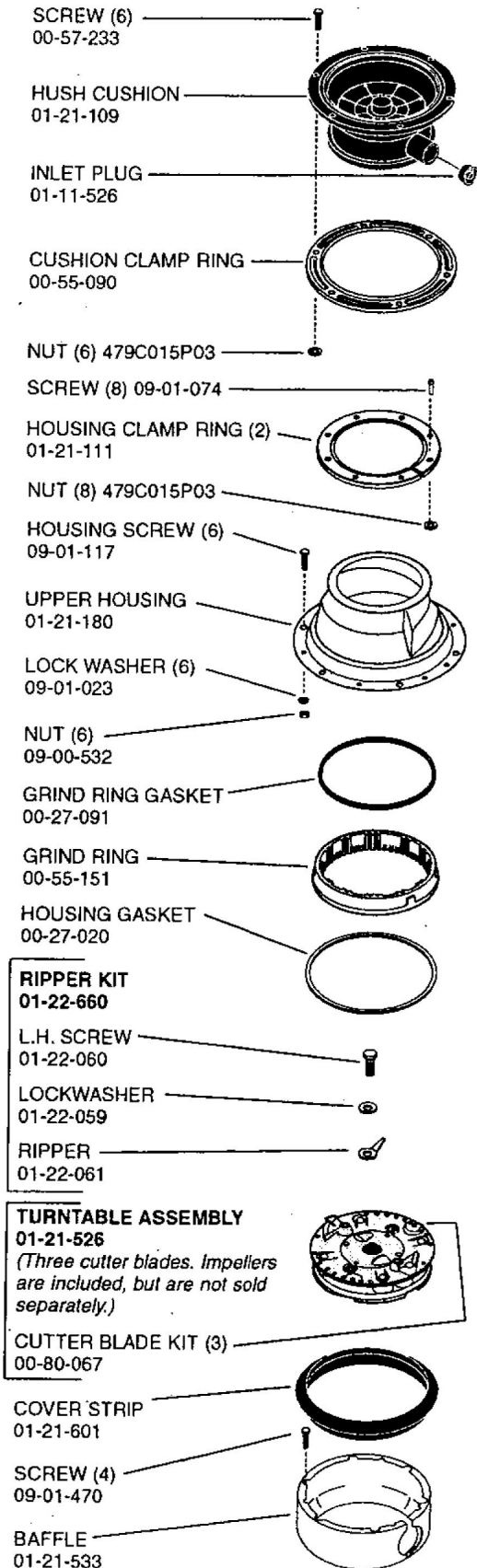

**SEAL KIT  
00-94-073**

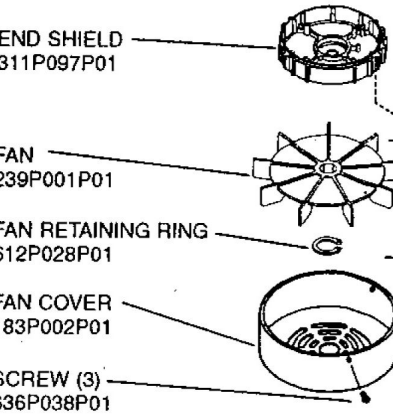
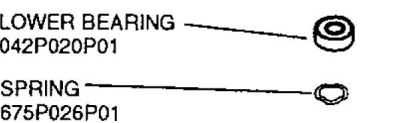
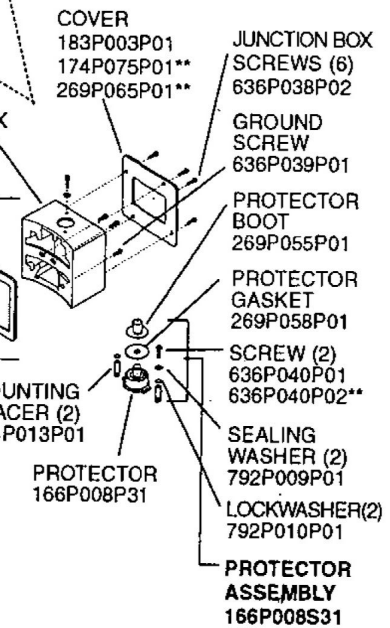
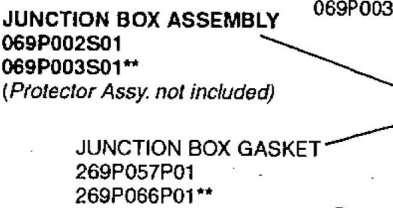
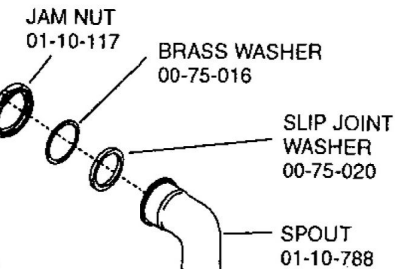
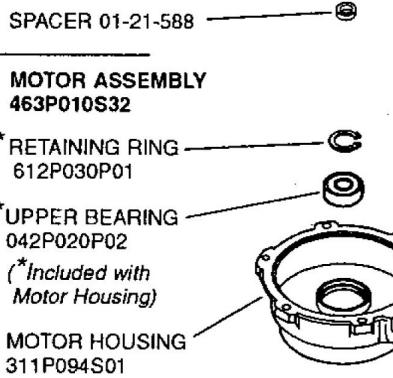

**FAN KIT  
239P001S01**

THRU-BOLT (4)  
687P004P01

**NUMBERED PARTS AVAILABLE SEPARATELY** \*\*For stamped steel box effective 2/10/00

WKC-1318-E  
REV 05/01

# PARTS LIST

## MODEL 1500-1 BEGINNING WITH #96-10-15163-1

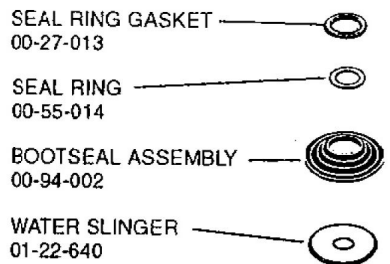
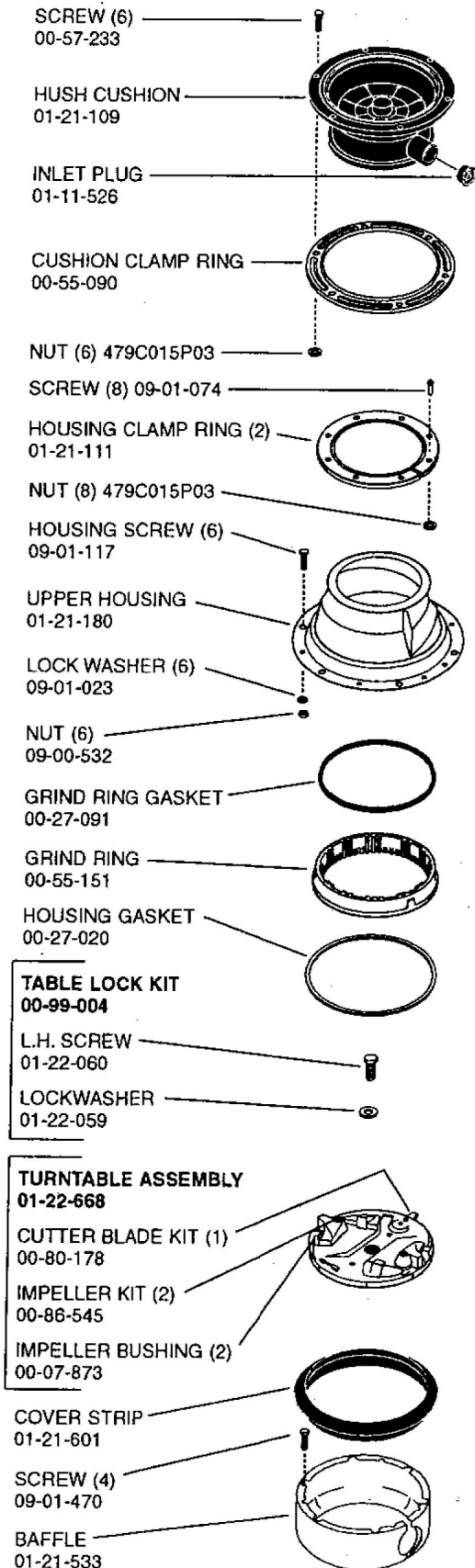

### SEAL KIT 00-94-014

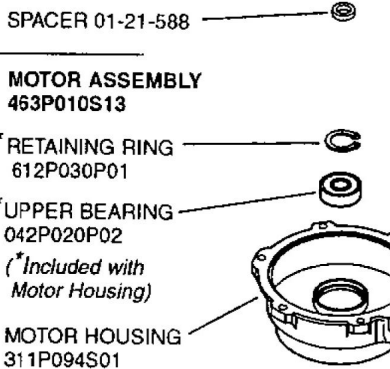

### JUNCTION BOX ASSEMBLY 069P002S01 069P003S01\*\* (Protector Assy. not included)

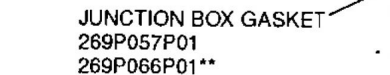

### ROTATING SWITCH 695P036P01

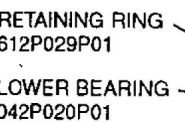

### STATIONARY SWITCH 695P034P01 (re-use screw)

### END SHIELD 311P097P01

### FAN 239P001P01

### FAN RETAINING RING 612P028P01

### FAN COVER 183P002P01

### SCREW (3) 636P038P01

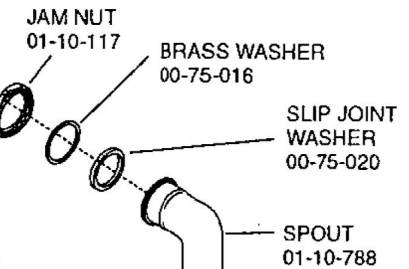

### COVER 183P003P01 174P075P01\*\* 269P065P01\*\*

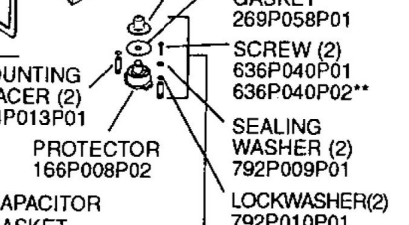
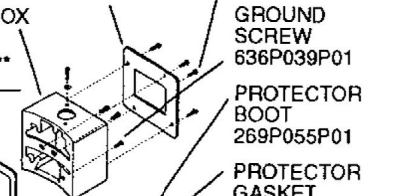

### PROTECTOR ASSEMBLY 166P008S02



### CAPACITOR GASKET 269P059P01

### CAPACITOR GASKET 269P060P01

### FAN KIT 239P001S01

### THRU-BOLT (4) 687P004P03

BERED PARTS AVAILABLE SEPARATELY \*\*For stamped steel box effective 5/22/00

WKC-1318-H  
REV 05/01

# PARTS LIST

**MODEL 1500-3  
BEGINNING WITH  
#96-10-15057-1**

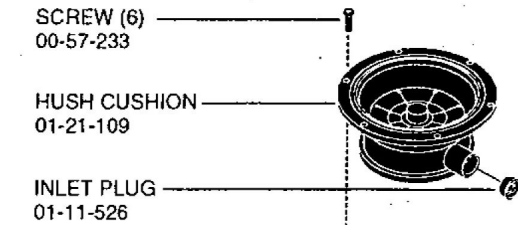

SCREW (6)  
00-57-233

HUSH CUSHION  
01-21-109

INLET PLUG  
01-11-526

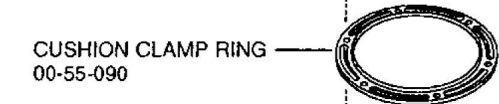

CUSHION CLAMP RING  
00-55-090

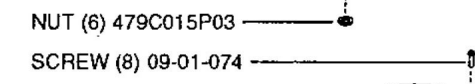

NUT (6) 479C015P03

SCREW (8) 09-01-074

HOUSING CLAMP RING (2)  
01-21-111

NUT (8) 479C015P03

HOUSING SCREW (6)  
09-01-117

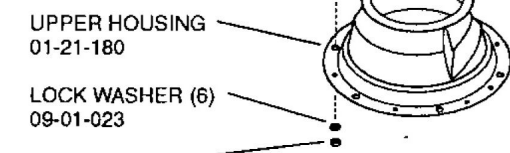

UPPER HOUSING  
01-21-180

LOCK WASHER (6)  
09-01-023

NUT (6)  
09-00-532

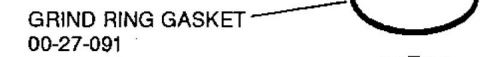

GRIND RING GASKET  
00-27-091

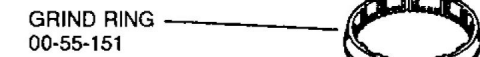

GRIND RING  
00-55-151

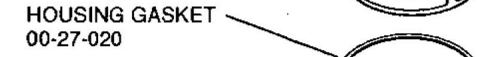

HOUSING GASKET  
00-27-020

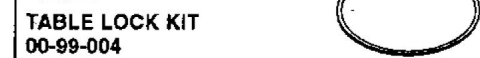

**TABLE LOCK KIT  
00-99-004**

L.H. SCREW  
01-22-060

LOCKWASHER  
01-22-059



**TURNTABLE ASSEMBLY  
01-22-668**

CUTTER BLADE KIT (1)  
00-80-178

IMPELLER KIT (2)  
00-86-545

IMPELLER BUSHING (2)  
00-07-873



COVER STRIP  
01-21-601



SCREW (4)  
09-01-470

BAFFLE  
01-21-533

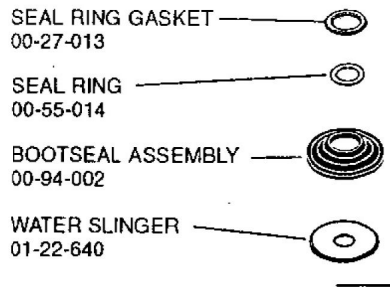

SEAL RING GASKET  
00-27-013

SEAL RING  
00-55-014

BOOTSEAL ASSEMBLY  
00-94-002

WATER SLINGER  
01-22-640

SEAL KIT  
00-94-014

SPACER 01-21-588

**MOTOR ASSEMBLY  
463P010S33**

\*RETAINING RING  
612P030P01

\*UPPER BEARING  
042P020P02  
(\*Included with  
Motor Housing)

MOTOR HOUSING  
311P094S01

JAM NUT  
01-10-117

BRASS WASHER  
00-75-016

SLIP JOINT  
WASHER  
00-75-020

SPOUT  
01-10-788

**JUNCTION BOX ASSEMBLY  
069P002S01  
069P003S01\*\*  
(Protector Assy. not included)**

JUNCTION BOX GASKET  
269P057P01  
269P066P01\*\*

JUNCTION BOX  
069P002P01  
069P003P01\*\*

COVER  
183P003P01  
174P075P01\*\*  
269P065P01\*\*

JUNCTION BOX  
SCREWS (6)  
636P038P02

GROUND  
SCREW  
636P039P01

PROTECTOR  
BOOT  
269P055P01

PROTECTOR  
GASKET  
269P058P01

SCREW (2)  
636P040P01  
636P040P02\*\*

SEALING  
WASHER (2)  
792P009P01

LOCKWASHER(2)  
792P010P01

**PROTECTOR  
ASSEMBLY  
166P008S32**

MOUNTING  
SPACER (2)  
694P013P01

PROTECTOR  
166P008P32

LOWER BEARING  
042P020P01

SPRING  
675P026P01

END SHIELD  
311P097P01

FAN  
239P001P01

FAN RETAINING RING  
612P028P01

FAN COVER  
183P002P01

SCREW (3)  
636P038P01

**FAN KIT  
239P001S01**

THRU-BOLT (4)  
687P004P02

NUMBERED PARTS AVAILABLE SEPARATELY \*\*For stamped steel box effective (pending)

# PARTS LIST

MODELS 2000-1/2000-3

2000-1: BEGINNING WITH #96-05-15084-1

2000-3: BEGINNING WITH #96-06-15464-1

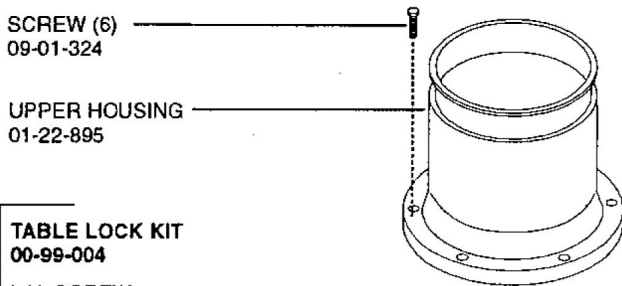
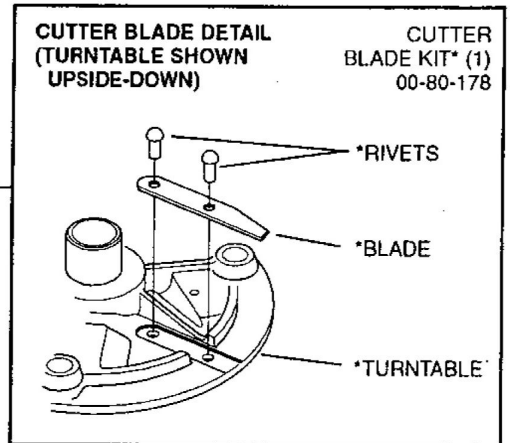
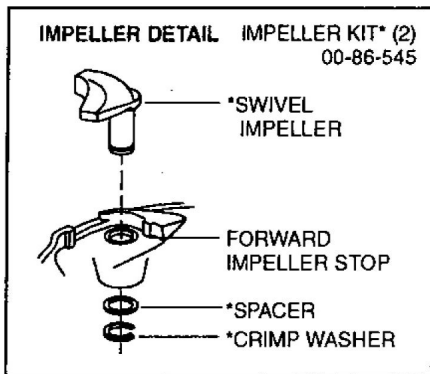

TABLE LOCK KIT  
00-99-004

L.H. SCREW  
01-22-060

LOCKWASHER  
01-22-059

TURNTABLE ASSEMBLY  
01-22-645  
(INCLUDES IMPELLER KIT  
AND CUTTER BLADE KIT)



WATER SLINGER  
01-22-856

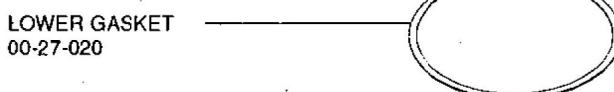
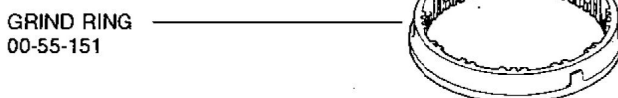

# PARTS LIST

**MODELS 2000-1/2000-3**  
**2000-1: BEGINNING WITH #96-05-15084-1**  
**2000-3: BEGINNING WITH #96-06-15464-1**

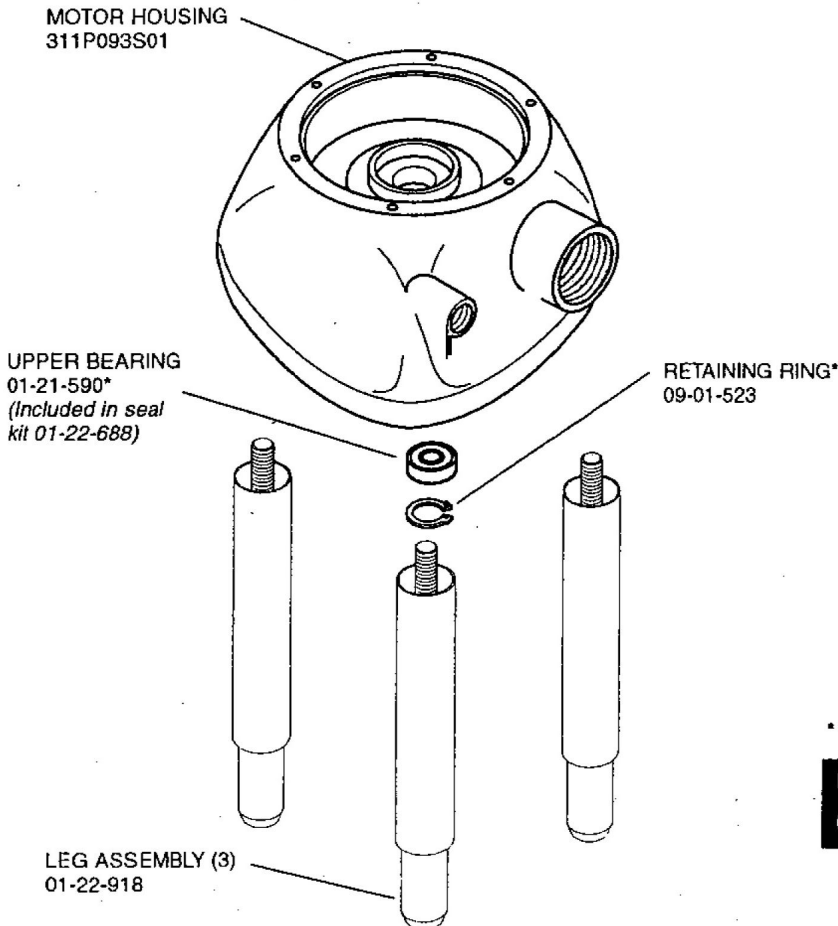
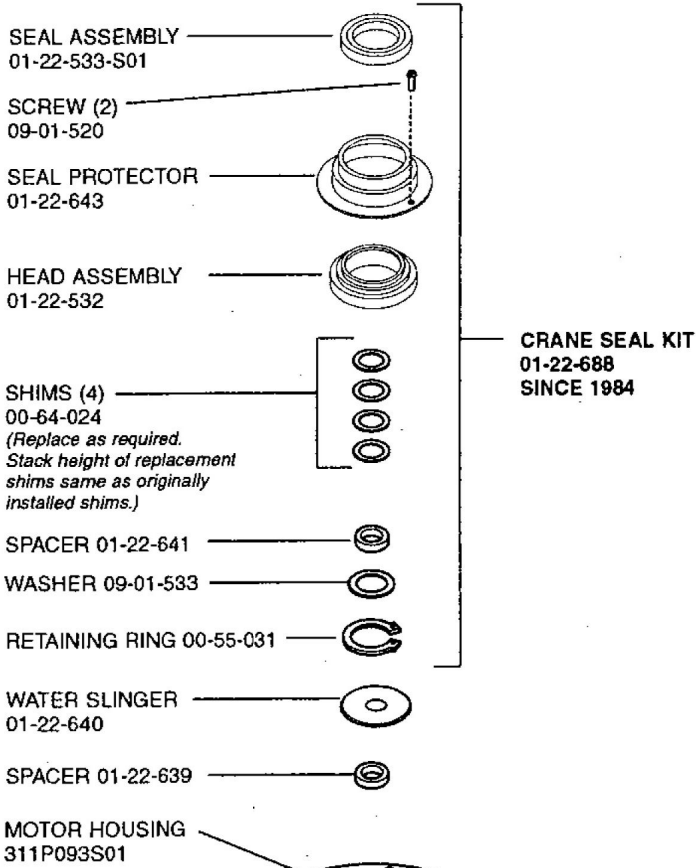

\* Included with Motor Housing and available separately.

**NUMBERED PARTS AVAILABLE SEPARATELY**  
**(NLA) - NO LONGER AVAILABLE**

# PARTS LIST

MODELS 2000-1/2000-3

2000-1: BEGINNING WITH #96-05-15084-1

2000-3: BEGINNING WITH #96-06-15464-1

## 2000-1:

### MOTOR ASSEMBLY 463P010S14

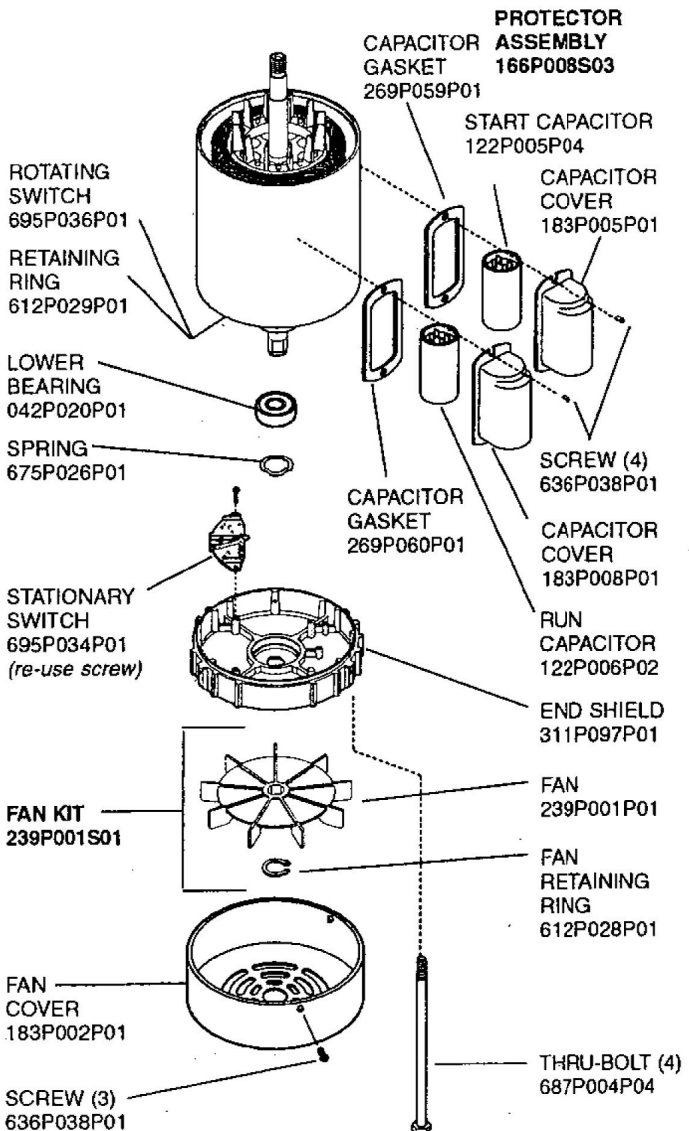
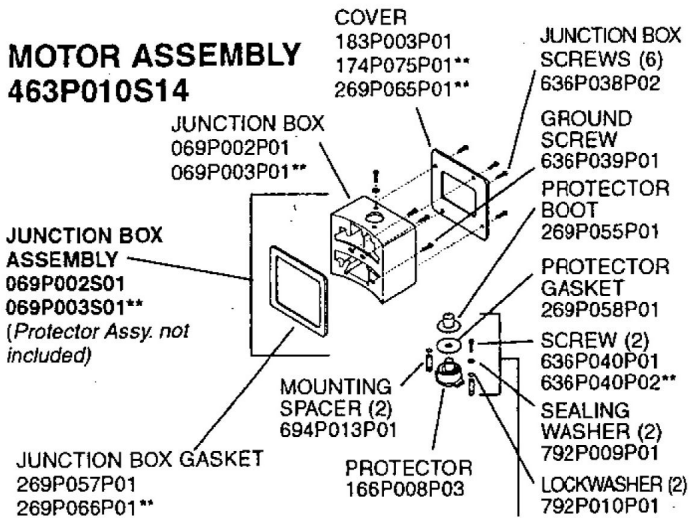

## 2000-3:

### MOTOR ASSEMBLY 463P010S34

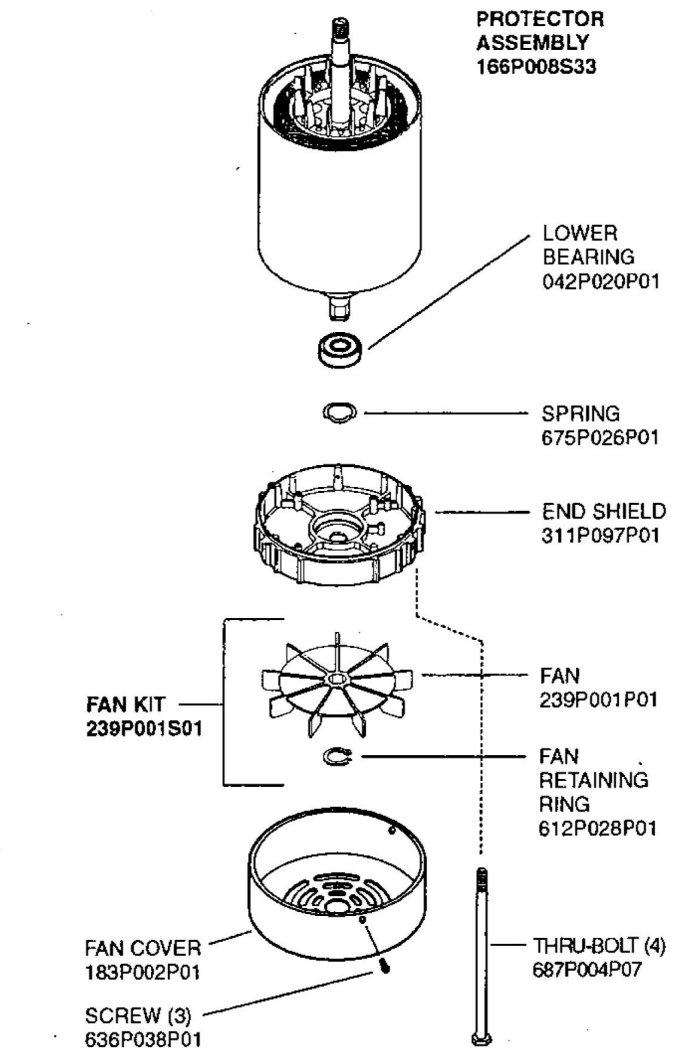
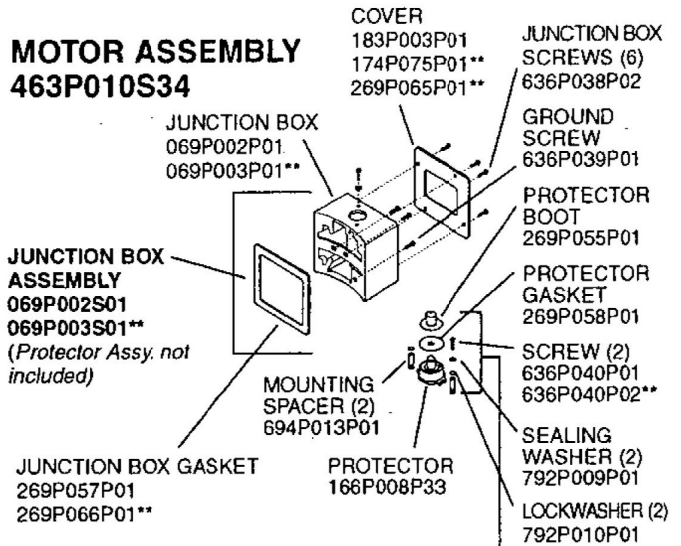

**PARTS LIST**  
**MODEL 3000-3**  
**FROM 1/82**

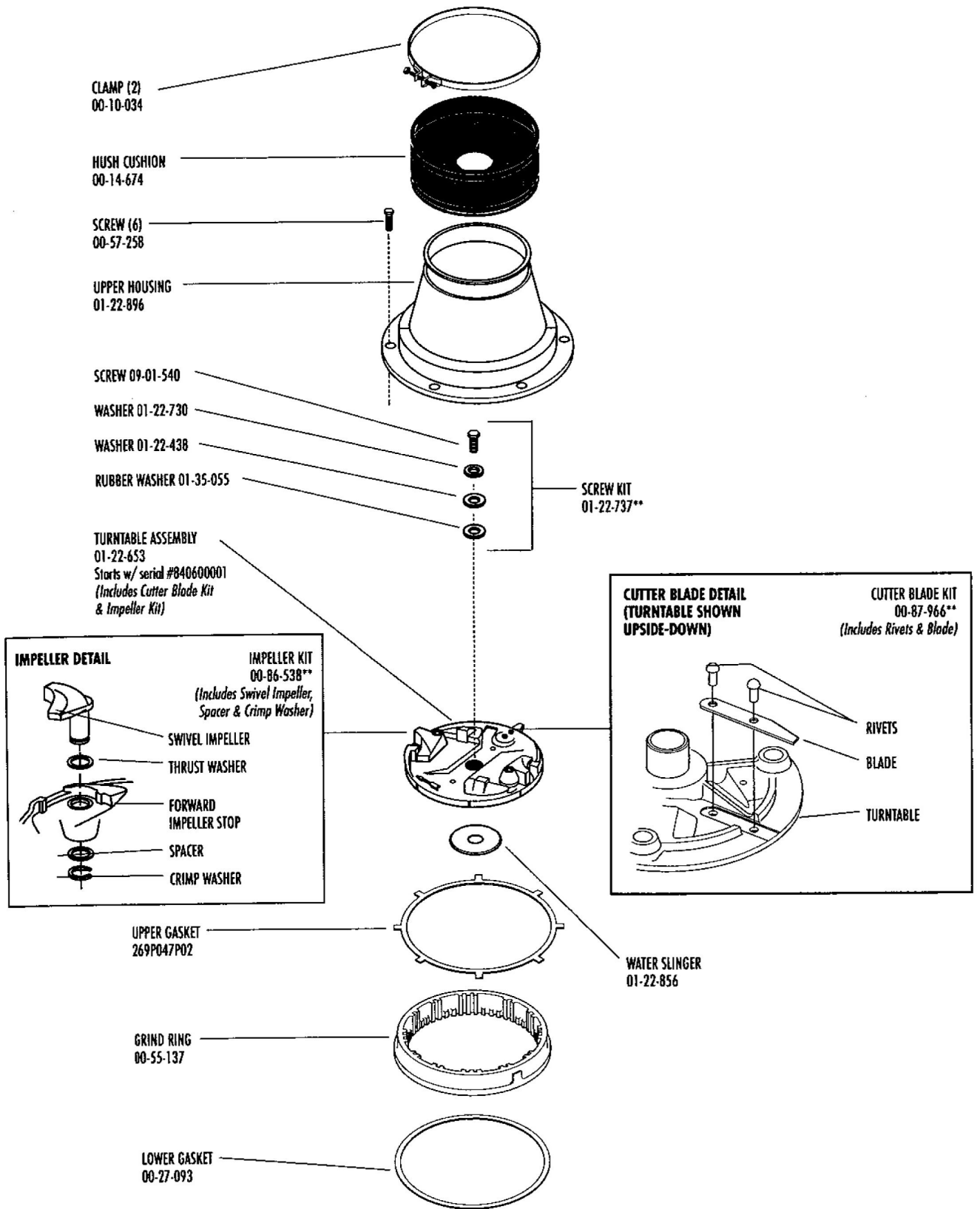

Due to continued product improvement, product configurations, parts and specifications may change without notice. Please call before ordering.

LIMITED QTY. AVAILABLE    \*\* ALSO AVAILABLE SEPARATELY    (NLA) NO LONGER AVAILABLE



# PARTS LIST MODEL 3000-3 From 1/82

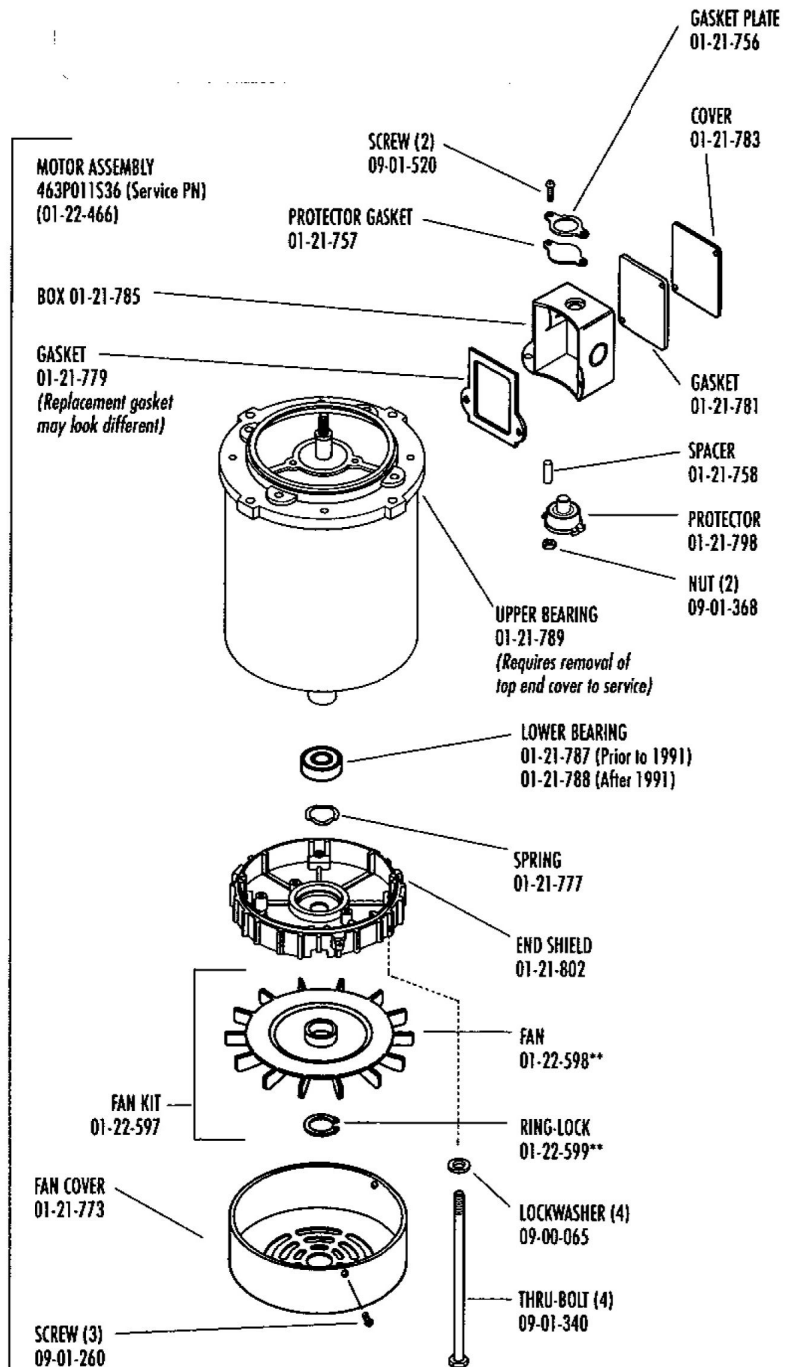
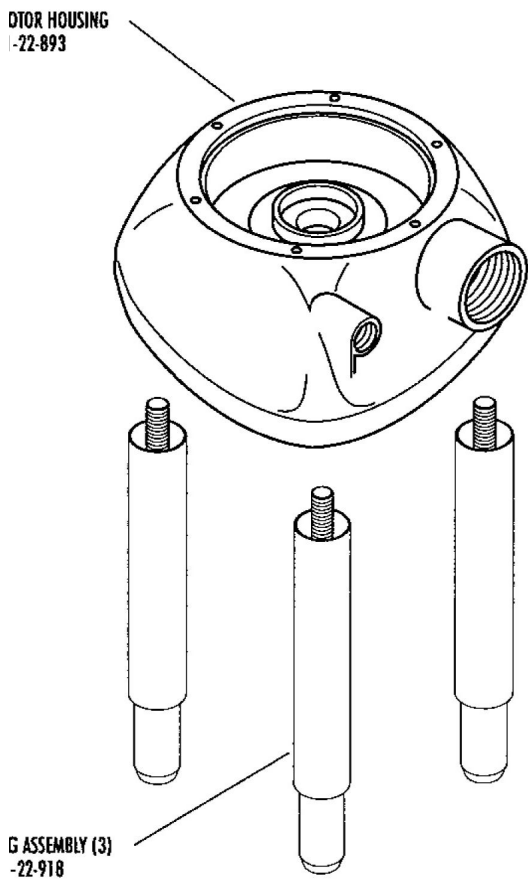
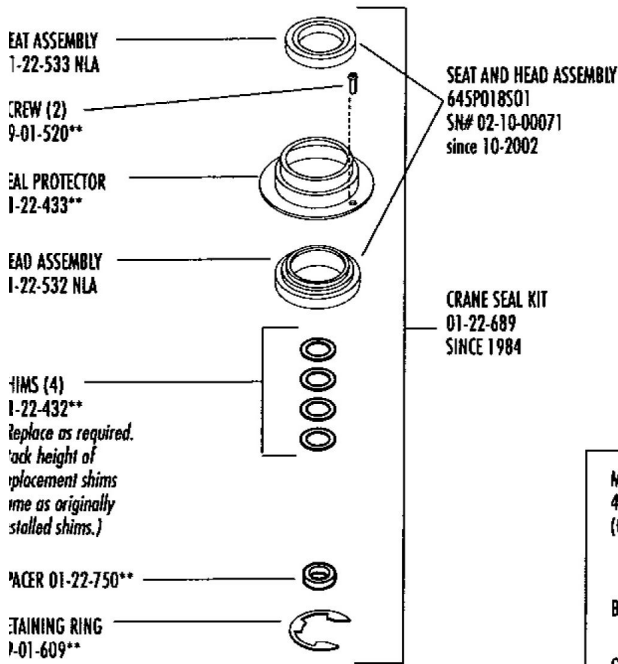

Due to continued product improvement, product configurations, parts and specifications may change without notice. Please call before ordering.

LIMITED QTY. AVAILABLE    \*\* ALSO AVAILABLE SEPARATELY    (NLA) NO LONGER AVAILABLE

# PARTS LIST

## MODEL 5000-3/38/38S

FROM 1/82

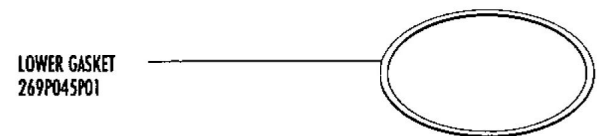
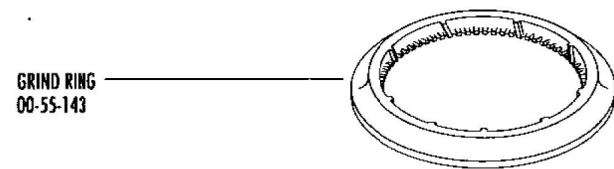
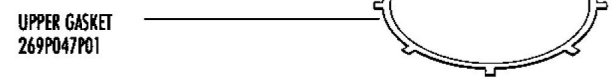
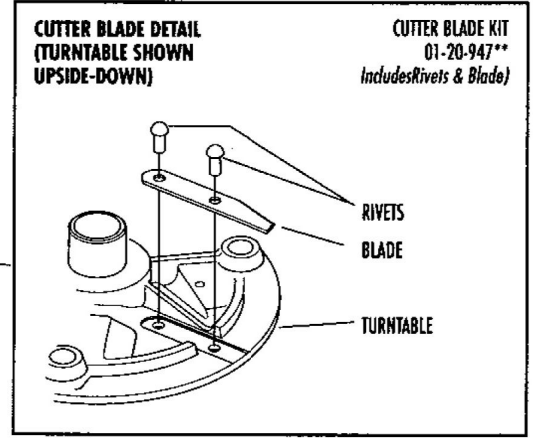
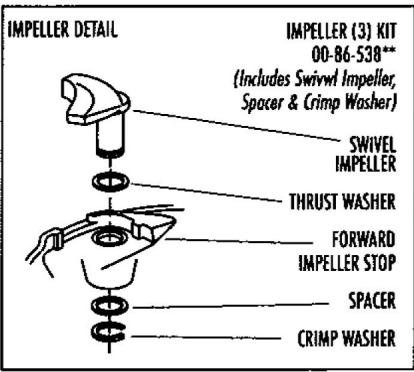
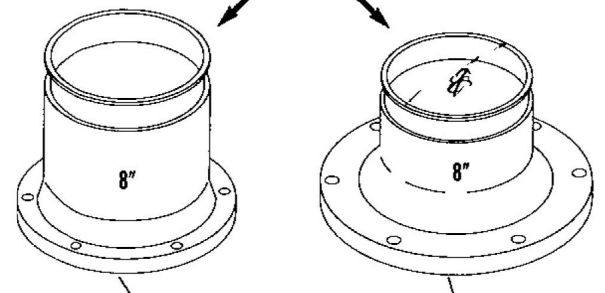
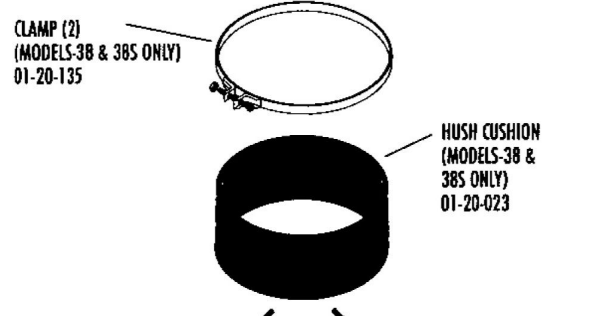
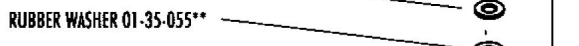
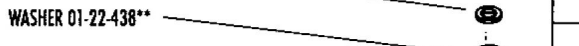
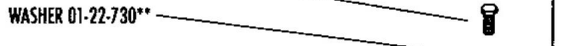
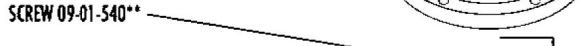
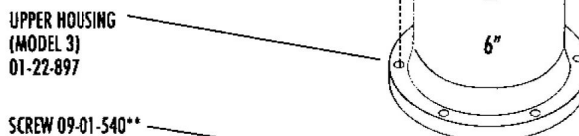
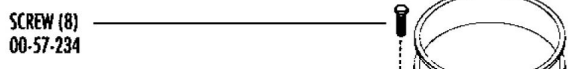

Due to continued product improvement, product configurations, parts and specifications may change without notice. Please call before ordering.

\* LIMITED QTY. AVAILABLE    \*\* ALSO AVAILABLE SEPARATELY    (NLA) NO LONGER AVAILABLE

# PARTS LIST MODEL 5000-3/38/38S FROM 1/82

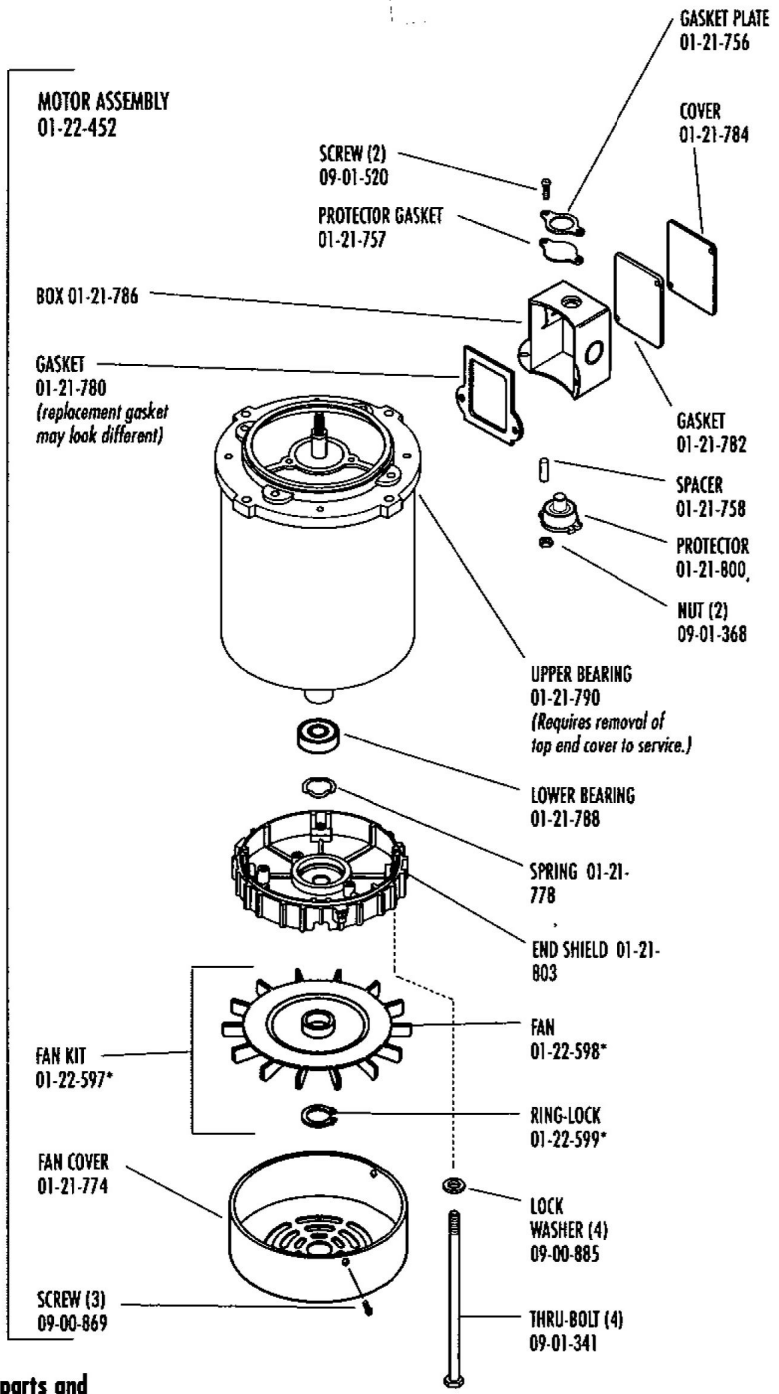
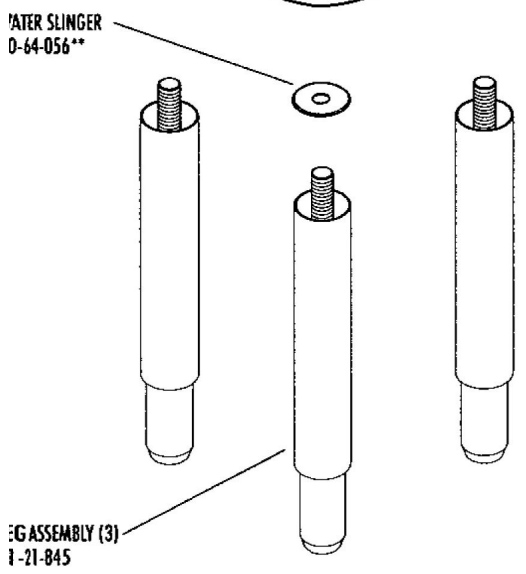
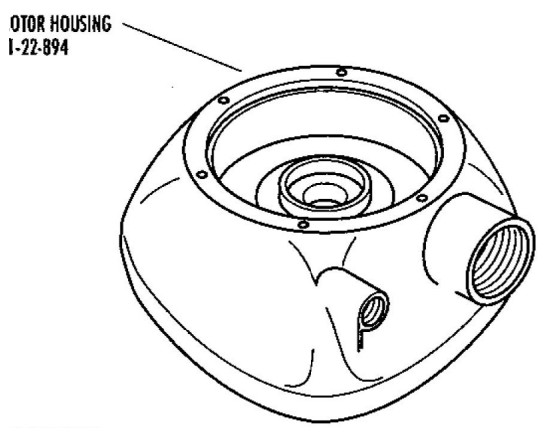
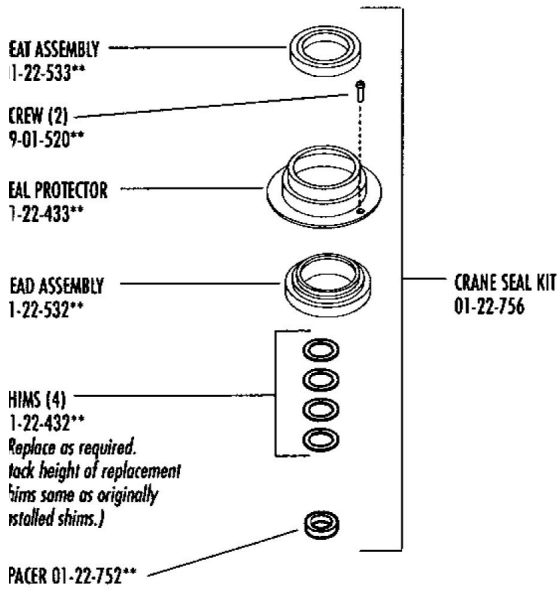

Due to continued product improvement, product configurations, parts and modifications may change without notice. Please call before ordering.

LIMITED QTY. AVAILABLE    \*\* ALSO AVAILABLE SEPARATELY    (NLA) NO LONGER AVAILABLE