

Sublue ()

Sublue Tianjing (Headquarters)

1

Address No. 1, Quanzhou Road, Binhai-Zhongguancun Science and Technology Park, Tianjin

support@sublue.com

Email support@sublue.com

Sublue™

Sublue reserves the right for final interpretation™

™ **Navbow+**

White Shark™ Navbow+ Users Manual

V10

V10

16

This product is not recommended for use by children under the age of sixteen.

Similar to other electronic products, you should be careful to prevent the electric shock during use.



Sublue

Sublue official website

CMIIT ID2019DP5060

The device contains the radio transmitting module whose CMII is 2019DP5060.

App

Use of App

SublueGo App

Download SublueGo App

SublueGo AppSublueGo

SublueGo App is a mobile phone app that helps use this product. It provides functions of personalized parameter setting, generation of underwater exercise data, product condition monitoring, firmware update, community sharing and interaction and so on, the details of which can be seen in the SublueGo chapter of the Users Manual.

SublueGo

Download and install SublueGo via the following methods

1.

1. Use your mobile phone to scan the barcode on the left.

2. iOSAppStoreSublueGoAndroidGoogle Play

2. iOS users log in AppStore and search SublueGo for downloading, while Android users log in Google Play or Tencents mayapp.com for downloading.

SublueGo AppiOS 12.0Android 7.0

SublueGo App requires iOS 12.0 or above system or Android 7.0 or above system.

AppSublueGo App

This App is subject to change without notice, please follow and update SublueGo App in a timely manner.

Recommendations and Support

™ Navbow+

Please read this White Shark™ Navbow+ Users Manual carefully prior to operation; and obtain information and notice of relevant products.

You may get support related to product issues, the Users Manual, software downloading and instructional videos, etc. via the following methods.

2

2 Support

Subblue www.subblue.com

Subblue official website: www.subblue.com

Subblue support@subblue.com

Subblue customer service email: support@subblue.com

China:

400-806-2688

support@subblue.com

Service hotline: 400-806-2688

Email: support@subblue.com

9:00-18:00

Working time: Monday to Friday, 9:00-18:00 (BJT)

America:

+1 855 206 8698

support.us@subblue.com

Service hotline: +1 855 206 8698

Email: support.us@subblue.com

9:00-18:00

Working time: Monday to Friday, 9:00-18:00 (PST)

Other regions:

Please contact your dealer for support

Warning

Safety Precautions



16

This product is not recommended for use by children under the age of sixteen.



This product cannot be used as a lifesaving device, and to ensure safety, users must either wear a life jacket or be equipped with life-saving equipment in all circumstances.



Under no circumstances should you put your fingers into the propeller; and do not affix clothing or other objects near the propeller.



Do not wear loose clothing or devices that could be sucked into the propeller by the water.



This product is not intended for use in water with dissolved sand or with similar physical properties. Otherwise, the product can be severely damaged.



Do not depend only on the depth, course and other data for underwater activities, and always make sure dive computer, depth gauge, thermometer, compass and other spare equipment are with you.



Always remove the battery from the product before transport or air transit, and store the battery separately in accordance with relevant regulations.



40 m

Do not use this product beyond its specified limit depth (40m).



Under no circumstances should you let your face or mask approach the rear of the propellers.



Wear a swimming cap during use, and pay special attention to anyone with long hair around you to prevent hair or clothing being tangled in the propeller.



Ensure that a companion is watching you from within a certain distance during use.



Always pay attention to the surrounding water area during use to ensure no danger of collision with boats or swimmers.



⏚

Always pay attention to battery charge when using this product in water and make sure to turn back it before power exhaustion.



Be sure to read the Users Manual carefully before use, and be familiar with all operating methods and precautions.

Notes

Make sure the battery is fully charged before use.

Inspect, set and calibrate relevant functions before use.

Do not replace the battery in water. Be sure to replace it in a dry environment where the device and hands are dry.

Do not place heavy objects on the product.

The surface of the product must not come into contact with volatile or acidic substances such as gasoline or rubber cement, or sharp objects.

30

To protect the service life of the motor, do not run it continuously for more than 30s in a non-water environment. In the case of any abnormalities (such as a burning smell), immediately release the switch to stop the device and cut off its power supply.

Do not use this product directly on the beach to prevent sand, shells, or other debris from being sucked into the propeller.

Factors such as location, temperature, depth, and water flow under different conditions can affect the buoyancy of this product. If the product is released at this time, it may sink.

Be sure to remove the product from the water when it is not being used.

Do not use it in the case of malfunction.

Sublue

After-sales service personnel except for the manufacturer may not perform repairs without authorization. Improper repair may result in water leakage, damage, fire, or electric shock.

Be sure to read the User's Manual carefully prior to use, and be familiar with all precautions!



Warning



Notes

*

* Annotation (detailed explanations and instructions)

Contents

Product Overview

Information

Features

List of Items

Optional Accessories

Part Names

First Connection for Use

Unpacking for Inspection

Battery Charging

SubblueGo App

SubblueGo App Installation

Device Connection

Setting and Calibration

First Use

Device

Screen Interface

Button and Operation

Description of Display Screen

Battery

Introduction to the Battery

Battery Charging

Battery Replacement

Device Usage

Inspection before Usage

Flotation Regulation

Wear and Emergency Release of Loss Prevention Cord

Device Calibration

Date Record of Underwater exercise

Posture Holding

Charge Quantity Reading

Alarming beyond Specified Limit Depth

One-hand Operation

SubblueGo

SubblueGo

Maintenance

Cleaning after Use

Storage

General Troubleshooting

Specifications and Parameters

Product Overview

1

1 Information

TM Navbow+ Navbow40 m2 m/s60 3Navbow+SubblueGo AppSubblueGo

White Shark™ Navbow+ is an underwater booster with richer and stronger functions, building on all excellent performance of White Shark Navbow. With 40m of maximum usage depth, 2m/s of maximum speed and 60 minutes general service life, it has 3 optional speed levels and allows one-hand operation. Additionally, Navbow+ has been added with many real-time speed displays such as depth, temperature, course and so on. It automatically records users data of underwater exercises and data graphs and journals of personalized underwater exercise can thus be generated via SubblueGo App so that your wonderful experiences can be shared with your friends via SubblueGo.

2

2 Features

-
- Compact and portable

DPV1/3

It is about 1/3 of traditional DPVs in volume and weight, which makes it extremely convenient to carry.

-
- Strong power and long service life
- DPV
- Better than medium and high end of traditional DPVs in power promotion and service life, enabling users to have wonderful underwater experiences.
-
- Convenient-dissembled battery compartment
-
- Unique patented battery sealing technology, which substantially reduces the complicated requirements for sealing structure installation so that users can rapidly install battery while reliability is ensured.
-
- Multiple real-time data

Real-time course, depth, temperature, quantity of charge, manual operation mode, speed levels, wireless connecting status and underwater recording notice for users to understand product and environment conditions in real time

-
- Reminders and alarms

If the depth is beyond the limit, the charge is in low quantity or device malfunctions, the product display screen and buzzer will send out warnings at the same time.

-
- Personalized product parameter setting

SubblueGo App

Users can set products functions via SubblueGo App on the basis of their usage habits and requirements.

-
- Generation and sharing of underwater exercise journal

Navbow+ SubblueGo App60

Navbow+ will automatically record users underwater exercise data and generate up to 60 personalized page data via SubblueGo App including depth and temperature curves, personal pictures, locations, usage environment labels and so on which can be shared within communities and among friends.

•

- One-hand operation support

DPV

The product is designed to accommodate users habits of one-hand operation, and users can release one hand under water like that when he/she operates professional DPVs.

-
- Micro-positive buoyancy design
-
- The product itself is designed to be equipped with micro-positive buoyancy which automatically floats upwards when it is released.
-
- External load support

111/4

The product is designed to have one standard motion camera hanging point, one 1/4 underwater device installation port, convenient for load extension.



-
- The micro-positive buoyancy of the product is available only when it is in sea water and the user does not add additional objects with negative buoyancy (weights, underwater cameras, lighting equipment, etc.). Different water environments and additional load may change product buoyancy and even cause negative buoyancy.
- ™ Navbow+
- The user must possess professional diving skill and understand the operation process and usage notice of one-hand operation mode in the White Shark™ Navbow+Users Manual well, as well as completely mastering the operation in absolutely safe water environment before using the product.

3

3 List of Items



1

Underwater booster 1



1

One-hand operation sling 1



1

Lithium ion battery 1



&1

Counterweight stand and counterweight column1



D1

Button transfer buckle1



1

Lost prevention rope1



2

Instructions2

4

4 Optional Accessories (it shall be bought separately)



98Wh1 1/4

98Wh Lithium ion battery1



1 1

Transition socket1 diving cross strap1



1

Multi-functional waterproof backpack1



1

Diving cross strap1



1

Photography platform

5

5 Part Names

1.

Booster sleeve

2. OLED

OLED display screen

3.

Multi-functional toggle switch

4.

Start button

5.

Flotation tank

6.

Battery cover

7.

Motion camera hanging point

8. 1/4

1/4 external installation hole

9.

Sling buckle

10.

Sealing gasket

11.

Back protection cover

12.

Front protection cover

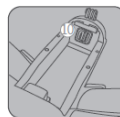
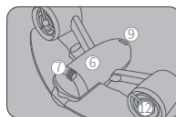
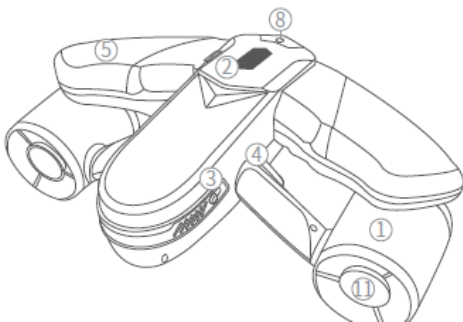

First Connection for Use

1

1 Unpacking for Inspection

Sublue

After unpacking, check carefully whether the case is broken, the protective cover has fallen off, the propeller blade has been damaged, the battery back cover cannot be opened, the battery is swollen or is leaking, the battery sealing gasket has been damaged, or other conditions that could seriously affect product use. If you find any of the above problems, please do not use the device and contact a Sublue After-sales Service Center or an authorized after-sales service organization.

2

2 Battery Charging

100-240V~AC50/60Hz

Connect the charger to the AC supply (100-240V AC, 50/60HZ).

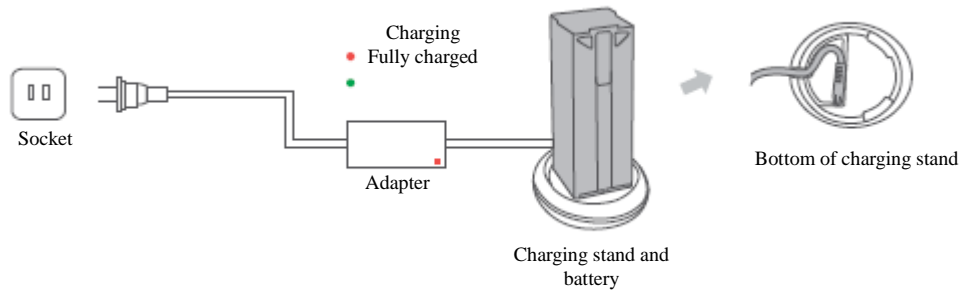

3 SublueGo App

3 SublueGo App Installation



SublueGo

Download and install SublueGo via the following methods

1. Use your mobile phone to scan the barcode on the left.
2. iOSAppStoreSublueGoAndroidGoogle Play
2. iOS users log in AppStore and search SublueGo for downloading, while Android users log in Google Play or Tencents mayapp.com for downloading.



SublueGo AppiOS 12.0Android 7.0

SublueGo App requires iOS 12.0 or above system or Android 7.0 or above system.

AppSublueGo App

This App is subject to change without notice, please follow and update SublueGo App in time.

4

4 Device Connection

SublueGo App

SublueGo

Use SublueGo App, scan the barcode on the device with your mobile phone or search bluetooth device nearby and connect the device according to the software guidance. (Please refer to the SublueGo chapter of this Users Manual)

5

5 Setting and Calibration

SubblueGo App

When you connect SubblueGo App, set functions in the console interface of the device according to your habits, and you should firstly calibrate the underwater booster to ensure the correctness of depth, temperature, course and other data.

6

6 First Use

Navbow+

Use your Navbow+ to explore the underwater world.



Prior to use, you should be familiar with product performance in an absolutely safe water environment and fully grasp its operations.

Device

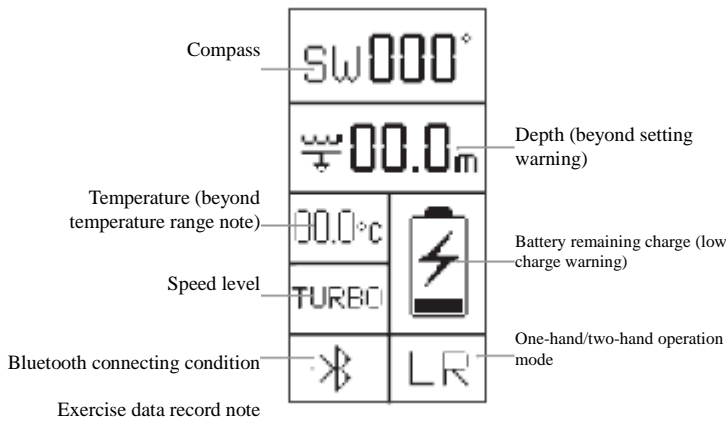

1

Screen Interface

2

Button and Operation

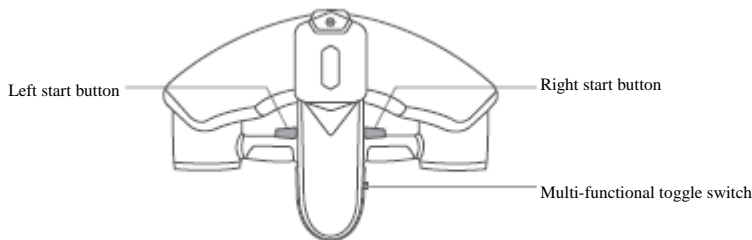

Operation

Photo

Instructions

Power on	Push forward and hold the multi-functional toggle switch for 1 second. 1
Power off	Push forward and hold the multi-functional toggle switch for 3 seconds.* 3 *
Start operation with two hands	Press the left and right start buttons at the same time to run the device.
Speed switching mode 1 1	When the device is powered on, push forward and then release the multi-functional toggle switch. 1. When the power is on, push forward and then release the left and right start buttons at the same time to keep device operating.
Speed switching mode 2 2	1. 2. Release the right start button and then quickly press it twice and hold on* 2. 2 *
Manual operation switching	When the device is powered on but not in operation condition, double click the left start button twice or set it via SubblueGo App 2 SubblueGo App 1. Manual operation to L left hand mode
Left hand operation of one-hand operation	1. L 2. Press the start buttons with two hands 2. 3. When the device operates, release the right hand. 3.
Right hand operation of one-hand operation	1. Manual operation to R right hand mode 1. R 2. Press the start buttons with two hands 2. 3. When the device operates, release the left hand. 3.



TMNavbow+

Before using one-hand operation function, the user must make sure he/she has professional diving skill and understand the operation process and usage notice of one-hand operation mode in the White Shark™ Navbow+ Users Manual well, as well as completely mastering the operation in absolutely safe water environment before using the product.



50% TURBO

When the charge level is less than 50%, you cannot enter the TURBO speed level.

2

The speed switching mode 2 can only be available under two-hand operation mode.

* 20

* The product will automatically be powered off after 20 minutes without any operation.

3

3 Description of Display Screen

Display of main screen information

Information	Photo	Status	Instructions
Battery		Continuous light	
Low charge warning		Flash	When the remaining charge is 30% 30%
Extremely low charge warning		Rapid Flash	When the remaining charge is 20% 20%
Compass		Continuous light	
Depth*		Continuous light	
* Depth pre-warning note		Flash	Needs to be started in SubblueGo where functions are set SubblueGo
Temperature		Continuous light	
Temperature beyond span upper limit		Flash	
Temperature beyond span lower limit		Flash	
Speed gear*	FREE	Continuous light	Low speed of about 1m/s 1 m/s
* exercise	TURBO	Continuous light	Medium speed of about 1.5m/s 1.5m/s
		Continuous light	High speed of about 2m/s 2 m/s
Connection condition		Continuous light	Mobile phone and device are not connected
		Continuous light	Mobile phone and device are successfully connected
Recording underwater exercise data		Flash	
Manual operation mode	LR	Continuous light	Two-hand operation mode
	R		
	L	Continuous light	Right hand operation of one-hand operation
		Continuous light	Light hand operation of one-hand operation

*

The speed level is the experimental speed. The speed of navigation is affected by factors such as different users, water temperatures, water depth, flow, and other water conditions, as well as load on the device and the user's underwater wear and equipment.

* 1.2 m

When depth is more than 1.2m, the data record will automatically start.

Display of other information

Information	Photo	Status	Instructions
Malfunction		Continuous light	
Beyond product depth limit		Flash	
Turn back reminder		Continuous light	<p>t requires to be started in SubblueGo where functions are set</p> <p>SubblueGo</p> <p>Push the multi-functional toggle button once and exit the interface for turn back reminder</p> <p>1</p>
Device in calibration		Continuous light	
Device calibration succeeded		Continuous light	
Device calibration failed		Continuous light	
Under self-cleaning		Continuous light	<p>When self-cleaning mode is started, it will operate for 3 minutes.</p> <p>3</p>
Safety lock		Continuous light	<p>When entering safety lock mode, you cannot operate the device. You should unlock it in App before re-operating the device.</p> <p>App</p>
Firmware updating		Continuous light	



Subblue

In case of any malfunction warning, you should immediately stop the use and timely contact Subblue after-sales service center or authorized service organizations for support.

Permanent damages will be made if the product is used beyond its depth limit, please do not do that.

Please always notice the charge changes and turn back according to the reality.

Please use fresh water rather than sea water for self-cleaning.

Battery

1

1 Introduction to the Battery

Navbow10670 mAh

Navbow+

The battery is a high-performance lithium-ion battery with a capacity of 10,670 mAh, designed specifically for the Navbow series underwater booster. It features high-performance cells that provide sufficient power supply for the Navbow+.



Please carefully read and strictly follow the requirements in the Users Manual and those on the battery surface sticker. The user shall undertake all consequences if he/she fails to follow the usage requirements.

Navbow+Navbow+SublueSublue

The battery must be charged using the dedicated charger supplied by Navbow+. Sublue is not responsible for any consequences of charging through chargers not provided by the official Navbow+ product (including other Sublue models).



Make sure to fully charge the battery before using it for the first time.

2

It takes about less than 2 hours to fully charge the battery with quick charging adapters.

2

2 Battery charging

100-240V~AC50/60Hz

Connect the charger to the AC supply (100-240V AC, 50/60Hz).

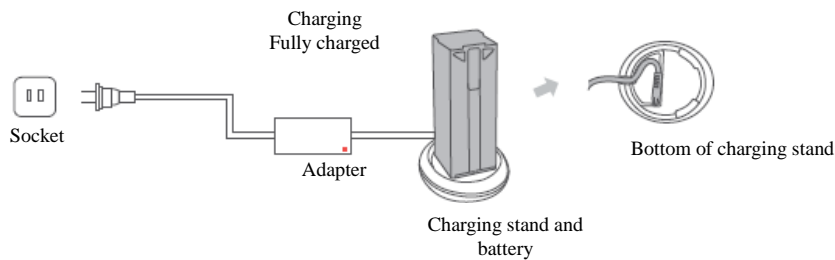

Please do not charge the battery near fire or heat.

0

Please do not charge the battery below 0.



The battery will be hotter after use, which is normal and you should charge it when it cools down to room temperature.

252

The best temperature for battery to be charged is 252, within which battery life will be extended.

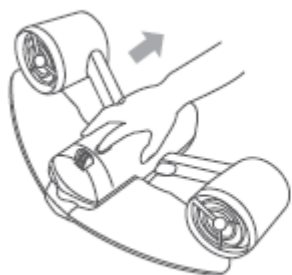

Open the battery back cover
打开电池后盖

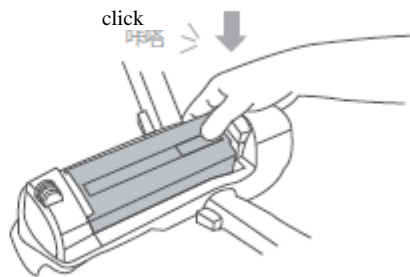

Insert the battery diagonally into the battery compartment and withstand the front end

3

Battery replacement

4

Battery Storage and Maintenance

1. 2556520RH30-60%

1. When the device is not in use, take the battery out and store it separately. The optimal storage conditions for the battery are 25°C, 60-25% RH humidity, and 30%-60% power capacity. It should be separately stored in a cool and ventilated place.

2. 30%

2. For safety, the battery should be kept at low charge during transportation. Discharge it beforehand to 30%.

3. 60%

3. If stored for a long period, check the battery level at least every 6 months and charge it to 60%.



Do not drop, squeeze or puncture the battery as this may cause internal short circuiting and overheating.

Do not leave the battery in places exposed to direct sunlight or high temperatures (such as near fire, microwaves or ovens), because it may overheat and potentially explode.

Keep the battery out of the reach of children.

Do not disassemble or modify the battery. Unauthorized modification may cause leakage or explosion.

Do not use damaged batteries.

If electrolyte enters your eyes after leakage, do not wipe it. Apply water to rinse it, and consult a doctor immediately. If left untreated, your eyes will be injured.



Charge the battery every 6 months



Do not squeeze and puncture the battery



Far from heat



Far from children

Device Usage

1

1 Inspection before Use

1.

1. Whether there is defect or damage on the device appearance and whether the propeller is broken and battery sealing gasket is damaged.

- 2.
2. Whether the battery functions and has been fully charged.
- 3.
3. Whether the buttons are functional.
- 4.
4. Whether the display screen functions.
- 5.
5. Whether the device has been calibrated.
6. SubblueGo App
6. Whether the relevant settings have been finished on SubblueGo App.
- 7.
7. Whether the depth, temperature, course and all other fundamental and spare digital and mechanical instruments show a correct and uniform reading.

2

2 Flotation Regulation

The device buoyancy may vary as water environment changes. If you need to increase the buoyancy and regulate the device to the best condition, you can do as follows.



Please make sure regulate buoyancy in safe water environment to prevent the device from slipping out of the hand and sinking.

The device may be negative in buoyancy after regulation, and the machine will sink when the device is released.



install the counterweight column first



assemble the counterweight stand next

1.

1. Install the counterweight stand and column according to photos.

2. 1

2. The device should be completely sunk in water and the air should be fully vented when one counterweight column is added. Inspect whether the buoyancy condition is up to expectation and if not, continue adding counterweight columns until expectations are met.

3

3 Wear and Emergency Release of Loss Prevention Cord



While wearing the loss prevention cord, in order to protect your personal safety in case of emergency, the device can be separated from you by quick release.

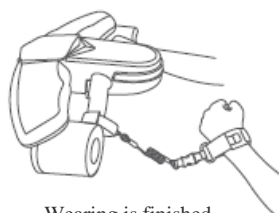

Wearing is finished



Quick release

4

4 Device Calibration

In calibration setting, the underwater booster compass and depth sensor will be calibrated at the same time.

If one of the following situations happens, please calibrate the device:

1. 100 km

1. Use the product over 100km away from the place where last calibration was successful.

2.

2. Regions where elevations have obvious changes.

3. 30

3. Over 30 days of non-use.

Calibration steps

1.

1. Choose an open area.

2. SubblueGo App
2. Turn on SubblueGo App and connect it to your underwater booster.
3. SubblueGo Navbow+
3. Choose device calibration in the Navbow+ console interface in SubblueGo.
4. 360
4. Horizontally rotate the underwater booster 360 degrees.
- 5.
5. Finish calibration.

If calibration succeeds, the display screen will show calibration succeeded and send out a sound. Otherwise, please change places for another calibration.

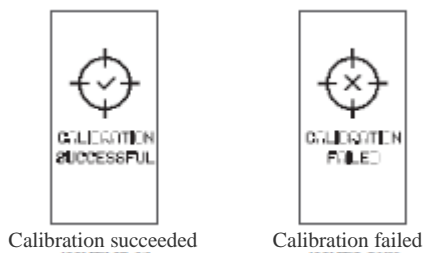

Please do not calibrate near strong magnetic field regions or large metal structures, such as concrete buildings, magnetic mine fields, metal blocks and so on.

Please do not carry magnetic things with you during calibration, such as mobile phones, keys and so on.

You are suggested to calibrate the compass before use.



Start device calibration and the depth sensor will be automatically calibrated. No need for other operations.

To exit the calibration notice interface, you should push the multi-functional toggle switch for several times.

5

5 Date Record of Underwater Exercises

Navbow+SubblueGo AppSubblueGo

Navbow+ has provided a brand new function of automatic recording of underwater exercises, generates data curves via SubblueGo App and personalized underwater exercise journal. (Please follow the SubblueGo chapter of the Users Manual to synchronize the journal data.)

1.

1. Conditions to start data recording

1.2 m

When the depth is more than 1.2m, the data recording will be automatically started and flashing prompt of record photos will appear on the screen.

2.

2. Conditions to end data recording

1.2 m5

When the depth is less than 1.2m for 5 minutes, it will automatically end recording.

When powered off, it will automatically end recording.

When the mobile phone is connected to bluetooth, it will automatically end recording.

When malfunction happens, it will automatically end recording.



1

The sampling rate of data is 1 second.

1 1

The longest recording time of each data is one hour, and when the time exceeds one hour, a new data record will be automatically started.

0 m 0m

When the end segments of data are 0m, these data will be automatically screened out.

60

The maximum storage number of data is 60.

6

6 Posture Holding

Try to keep your body streamlined and prevent any part of your body from hindering the hydraulic output of the underwater booster.



You should be familiar with product performance in an absolutely safe water environment and fully grasp its operations.

When there is strong magnetic field around the product, it will affect the compass and thus you are not suggested to trust the compass data.

7

7 Charge Reading



0

When the battery is used below 0, the charge will descend and lead to a sharp reduction in operation duration.

Please always notice the charge changes and turn back according to the reality.



21

When the battery is in low charge (2) and in extremely low charge (1), the underwater booster will send out buzzer warnings to remind the user when it stops operation.

8

8 Alarming beyond Specified Limit Depth

40 m

When the user dives beyond the specified limit depth (40m), the underwater booster will stop working. At this time, the screen will continuously enter the alarming statue and the underwater booster will send out buzzers.



10

The booster can resume operation 10 seconds after such alarm is made, please rise to the specified depth as soon as possible.

9

9 One-hand Operation

The one-hand operation function helps the user release one hand when operating the underwater booster, so that the user can balance ear pressure, call companions and do other activities.

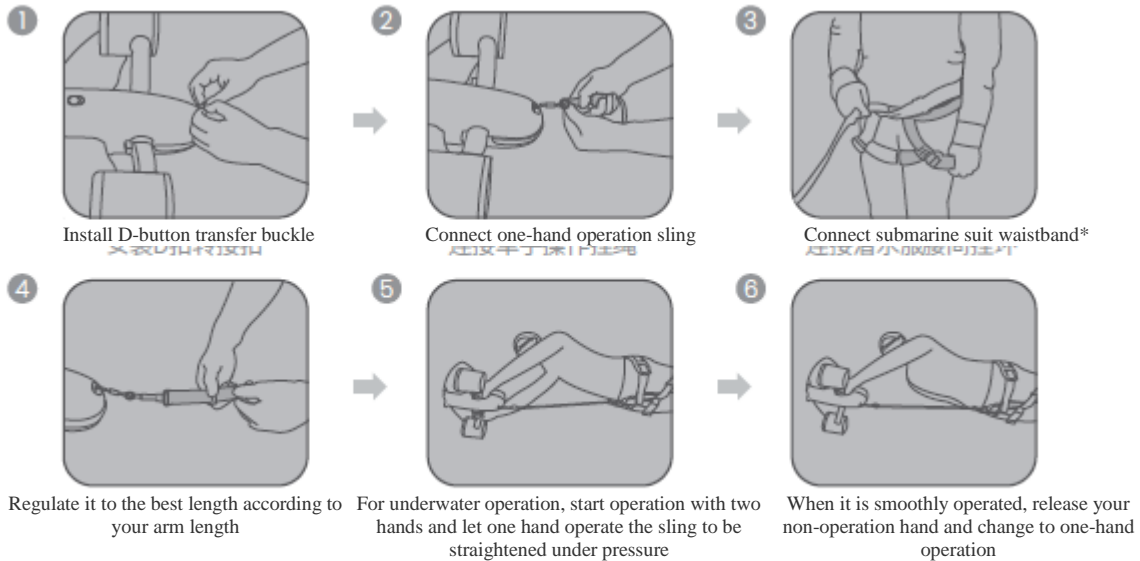

Sublue

Please strictly follow the operation method in Sublue instructions for one-hand operation. Do not try other methods because they may cause unknown physical risks.

Navbow+

The user must possess professional diving skill and understand the operation process and usage notice of one-hand operation mode in the White Shark™ Navbow+Users Manual well, as well as completely mastering the operation in absolutely safe water environment before using the product.



FREE

Please firstly adapt and exercise the one-hand operation under FREE mode.

When operate the device under water, please start operation with two hands. When it is smoothly operated, use one-hand operation to straighten the sling. You should not release your non-operation hand until your hand tension is significantly reduced. After that, you can operate with one hand.

SublueGo

SublueGo App

SublueGo App Introduction

SublueGo App SublueGo

SublueGo App is a mobile phone app that helps use this product. It provides functions of personalized parameter setting, generation of underwater exercises, product condition monitoring, firmware update, community sharing and interaction and so on. You can also upload your photos, videos or journals to SublueGo community network to share the wonderful moments under water.

1.

Synchronization of Underwater Exercise Journal Data



Synchronize the exercise data recorded in the underwater booster to your mobile phone and edit and generate your personal underwater

exercise journals.

SublueGo

Enter the journal synchronization page from SublueGo console.

Choose synchronization which will display the journal list saved in your device. You can select journals that you want to download and then press synchronization. Then, the device will transmit data to your mobile phone.



When RAM of underwater booster is completely stored, the device will automatically delete the earliest data to save later ones. Please synchronize data in time.

2.

2. Geomagnetic Declination Setting



SublueGo

Geomagnetic declination setting improves the accuracy of compass. Therefore, before you use the product, especially when you have changed the use area of the product, you should obtain local geomagnetic declination from reliable sources and set it in SublueGo.

* N

* Magnetic declination refers to the angle between the magnetic meridian and the geographical meridian at any point on the earth's surface. It is different in various places, while it is also different even in the same place with different time. If the magnetic needle points to the north pole and heads towards the east, then the angle of magnetic declination is positive, and if it heads towards the west, then it is negative.

3.

3. Safety Lock



When this function is set to start, the device will be locked. Though you can power the device on, you cannot operate it. Meanwhile, the screen will display the photo of safety lock start. You can use the device when the function is lifted.



If you are worried that the device is incorrectly operated or children use it without supervision, you are suggested to use this function.

4.

4. Self-cleaning



With this function, the product can be deeply cleaned and sea water remaining in the product will be also removed.



Please use fresh water for cleaning. During the operation of self-cleaning function, the propeller will move, so please be cautious!



3

Self-cleaning will last for 3 minutes.

5.

5. Low Charge Buzzer Reminder



When this function is started and charge is less than 30%, the device will send out buzzer warnings.

6./

6. Fresh Water/Sea Water



Set the function according to the water environment (fresh water or sea water) in which the product is applied to improve the accuracy of depth display.



Water environment in various regions causes depth to be displayed in error. Please confirm that the depth data and spare digital or mechanical instruments show the same reading before use.

7.

7. Depth Pre-warning Setting



The user can set the depth value that he/she expects to be noticed through this function, and when the depth exceeds your setting value, the device will send out warnings.

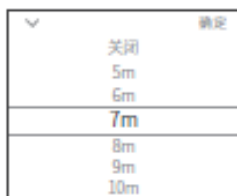

Depth value setting by mobile phone

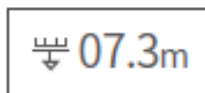

The screen flashes if depth exceeds the setting value

8.

8. Turn Back Charge Reminder



The user can set the remaining charge value to remind turning back, and when the remaining charge is less than the setting value, the device will send out warnings.



Please always notice the charge changes and turn back according to the reality.

1

You should push the multi-functional toggle switch once to exit the turn back reminder interface.

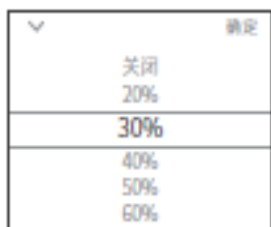

Remaining charge value setting by mobile phone



A prompt pops up when the charge is less than the setting value

Maintenance

1

1 Cleaning after Use

1. Navbow+ 30

1. After each use, Navbow+ should be completely immersed in clear water for 30 minutes to prevent residue from seawater or foreign matter. Besides, attentions should be paid to the following.



The battery must be installed during cleaning.

Use clean water.

20

Immerse in water for more than 20 minutes.

Do not add chemical cleaners such as laundry detergents or cleaning agent to the water.

Navbow+

When the Navbow+ is immersed in water, some bubbles may emerge from holes on its body. This is normal.

2. App Navbow+

2. For deep cleaning, please click the self-cleaning function on your mobile phone App. Then the booster will automatically run. You should immerse the Navbow+ booster completely in fresh water.



Be careful to prevent the water from being splashed on your body.

3. Navbow+

3. Shake fully and clean the Navbow+ body to remove any foreign matter attached to it.

4.

4. Wipe the surface of the device with a clean, soft, dust-free cloth. Make sure that the body and battery have no water beads, and place them in a cool, dry place to dry naturally.



Never use a hair dryer or drying apparatus to dry it.

Never spray the battery contact or the battery compartment of the host with water.

2

2 Storage

If the device will be idle for a long time, please note that the Mix Pro and the battery should be stored separately in the package; and please observe the following directions.

1. 0-456520RH

1. Ensure that the device is stored in a cool and ventilated place, above 0C and below 45C where the humidity is 6520RH.

2.

2. Dont store it in areas exposed to direct sunlight.

3.

3. Keep it away from heat, fire, and children's reach.

4.

4. Keep it away from devices that may generate strong magnetic fields.

5. 10

5. Take out the device at least once a month and run it for about 10 seconds to prevent corrosion caused by changes in the storage environment.

General Troubleshooting

Fault	Solution
Stuck or abnormally running propeller	<ol style="list-style-type: none"> 1) Turn off the device 1. 2) Check if the propeller is entangled in foreign matter 2. 3) Follow the instructions in the Maintenance chapter to clean the underwater booster 3. 4) Contact Subblue or an authorized service organization 4. Subblue
Damaged or swollen battery	<p>Contact Subblue or an authorized service organization Subblue</p>
Battery contact is corroded	<ol style="list-style-type: none"> 1) Check for damage around the battery contacts 1. 2) Check the devices sealing gasket for damage or protrusions 2. 3) Check the battery sealing surface corresponding to the sealing gasket for scratches or protrusions 3. 4) If the corrosion is slight, clean it with a dry cloth 4. 5) Contact Subblue or an authorized service organization 5. Subblue
Failure to power on	<ol style="list-style-type: none"> 1) Please fully charge the battery and install it before another power-on. 1. 2) Contact Subblue or an authorized service organization 2. Subblue
Abnormal operation	<ol style="list-style-type: none"> 1) Check if it is in one-hand operation mode or speed-change operation mode 1. 2) Try to reboot the device 2. 3) Contact Subblue or an authorized service organization 3. Subblue
Failure Code: ER00	<ol style="list-style-type: none"> 1) Please power off the device and take out battery 1. 2) Contact Subblue or an authorized service organization 2. Subblue
ER00	<ol style="list-style-type: none"> 1) Power off the device 1.
Failure Code: ER20 or ER40	<ol style="list-style-type: none"> 2) Check if the propeller is entangled in foreign matter 2. 3) Follow the instructions in the Maintenance chapter to clean the underwater booster 3. 4) Contact Subblue or an authorized service organization 4. Subblue
ER20ER40	

Abnormal compass data

- 1) Make sure there is no magnetic field around the site
1. Calibrate the compass in the device calibration of SubblueGo App
2. SubblueGo App
- 3) Check the magnetic declination of the region where you are and set it in SubblueGo App
3. SubblueGo App
- 4) Contact Subblue or an authorized service organization
4. Subblue

Specifications and Parameters

Physical Parameters

486 mm 327 mm 177 mm

Dimensions: 486mm (length) * 327mm (width) * 177mm (height)

3400 g

Weight: 3400g (not including battery)

Working conditions

0-40 m

Depth range 0-40m

0-35

Working temperature 0-35

0-45

Storage temperature 0-45

Performance

* TURBO 2 m/s exercise 1.5 m/s FREE 1 m/s

Maximum speed* TRUBO gear is about 2m/s, exercise gear is about 1.5m/s and FREE gear is about 1m/s

* 60 TURBO 8 50% exercise 20 FREE 45

Maximum service life* Up to 60m for normal use (50% charge remaining after 8m use for TURBO level, 20m for exercise level and 45m for FREE level for continuous use)

0-35

Temperature range 0-35

2

Temperature accuracy 2

0.1

Temperature resolution 0.1

0-40 m

Depth range 0-40 m

0.5 m

Depth accuracy 0.5 m

0.1 m

Depth resolution 0.1 m

10

Compass accuracy 10

	1
Compass resolution	1
Journal	
	1
Sampling rate	1 s
	60
Maximum storage items for device	60 items
	1
Maximum storage duration	1 h
External load	
	1/4
External load	Motion camera hanging point, 1/4threaded connections and sling buckle (for one-hand operation)
Battery	
	10670 mAh
Capacity	10670 mAh
	14.8 V
Nominal voltage	14.8 V
	1100 g
Battery weight	1100 g
	158 Wh
Energy	158 Wh
	5-40
Ambient temperature for charging	5-40C
Charging adapter	
	100-240 V~AC 50/60 Hz
Input voltage	100-240 V~AC 50/60 Hz
	16.8 VDC
Output voltage	16.8 VDC
	126 W
Rated power	126 W
Charging indication	Charging: red fully charging: green light
Motor	
	14.8 V
Rated voltage	14.8 V
	420 W
Power	420 W
	B
Motor grade	B continuous operation
	2470 RPM
Maximum speed	2470 RPM

*

* The speed level is the experimental speed. The speed of navigation is affected by factors such as different users, water temperatures, water depth, flow, and other water conditions, as well as load on the device and the user's underwater wear and equipment.

*

* The use time generally refers to the average maximum time of operation based on general (non-continuous) usage habits when the device is fully charged.

*

* Continuous use time refers to the average maximum operation time for continuous use at each speed level when the device is fully charged.

* TURBO50% TURBO50% exercise

* TURBO level can be used only when the remaining charge is over 50%. Continuous use of TRUBO level to less than 50% charge, it will be automatically changed to exercise level for continuous operation.

Warning:

This device complies with part 15 of the FCC Rules. Operation is subject to the following two conditions: (1) This device may not cause harmful interference, and (2) this device must accept any interference received, including interference that may cause undesired operation.

This equipment complies with FCC radiation exposure limits set forth for an uncontrolled environment.

This equipment has been tested and found to comply with the limits for a Class B digital device, pursuant to Part 15 of the FCC Rules. These limits are designed to provide reasonable protection against harmful interference in a residential installation. This equipment generates, uses and can radiate radio frequency energy and, if not installed and used in accordance with the instructions, may cause harmful interference to radio communications. However, there is no guarantee that interference will not occur in a particular installation. If this equipment does cause harmful interference to radio or television reception, which can be determined by turning the equipment off and on, the user is encouraged to try to correct the interference by one or more of the following measures:

- Reorient or relocate the receiving antenna.
- Increase the separation between the equipment and receiver.
- Connect the equipment into an outlet on a circuit different from that to which the receiver is connected.
- Consult the dealer or an experienced radio/TV technician for help.

Changes or modifications not expressly approved by the party responsible for compliance could void the user's authority to operate the equipment.