

**Your Professional Cutting Partner!**



**Hi-Tech Cutting Tool Co., Ltd**

Tel: +86 769 8150 2920  
Fax: +86 769 8150 2952

Email: [shirleypeng@htcuttingtool.com](mailto:shirleypeng@htcuttingtool.com)

Web: [www.htcuttingtool.com](http://www.htcuttingtool.com)

Add: No. 8, West 1st District, Shihe Road, Shilongkeng Village, Liaobu Town, Dongguan City, China



**Holder Products**

# 目录 Contents

- 1. High efficient (double-side) high feeding rate cutter →1-9
- 2. Ball milling holder →10-13
- 3. Shank mill/ thread type mill →14-18
- 4. Carbide holder/ thread holder →39-40
- 5. Drill →41-42
- 6. Brazed carbide end mill →43-52
- 7. Carbide end mill →53-54

## EXN03R 东芝双面四角快进给立铣刀 MILLING TOOLS

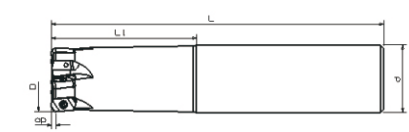

**NEW**



型号 Designation	尺寸Size(mm)						刀片型号 Inserts	刀片螺丝 Inserts Screw	扳手 Wrench
	Max.ap	D	d	L	L1	刃数 Teeth			
<b>EXN03R</b> 016M15.0-02-150L	1.0	16	15	150	30	2	LNMU0303ZR	M2. 5X6. 5	T8
016M16.0-02-150L	1.0	16	16	150	50	2			
016M16.0-02-200L	1.0	16	16	150	70	2			
017M16.0-02-160L	1.0	17	16	160	30	2			
017M16.0-02-200L	1.0	17	16	200	30	2			
020M19.0-03-150L	1.0	20	19	150	30	3			
020M20.0-03-150L	1.0	20	20	150	70	3			
020M20.0-03-200L	1.0	20	20	200	90	3			
021M20.0-03-150L	1.0	21	20	150	30	3			
021M20.0-03-200L	1.0	21	20	200	30	4			
025M24.0-04-150L	1.0	25	24	150	35	4			
025M25.0-04-150L	1.0	25	25	150	70	4			
025M25.0-04-200L	1.0	25	25	200	100	5			
026M25.0-04-150L	1.0	26	25	150	35	5			
026M25.0-04-200L	1.0	26	25	200	35	5			
032M32.0-05-160L	1.0	32	32	160	70	5			
032M32.0-05-200L	1.0	32	32	200	120	5			
033M32.0-05-160L	1.0	33	32	160	40	5			
033M32.0-05-200L	1.0	33	32	200	40	5			
035M32.0-05-160L	1.0	35	32	160	45	5			
035M32.0-05-200L	1.0	35	32	200	45	8			

## TXN03R 东芝双面四角快进给面铣刀盘 MILLING TOOLS

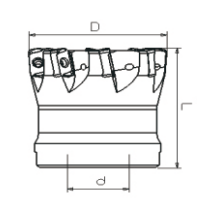

**NEW**



型号 Designation	尺寸Size(mm)						刀片型号 Inserts	刀片螺丝 Inserts Screw	扳手 Wrench
	Max.ap	D	d	L	L1	刃数 Teeth			
<b>TXN03R</b> 040M16.0-E05/E06	1.0	40	16	40		5/6	LNMU0303ZR	M2. 5X6. 5	T8
050M22.0-E08/E05	1.0	50	22	50		5/8			
063M22.0-E08	1.0	53	22	50		8			

**HXN03R**

东芝双面四角锁牙式立铣刀 MILLING TOOLS

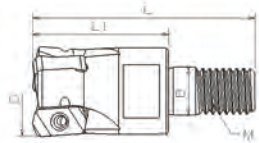

**NEW**



型号 Designation	尺寸Size(mm)						刀片型号 Inserts	刀片螺丝 Inserts Screw	扳手 Wrench
	D	L1	L	B	M	刃数 Teeth			
<b>HXN03R</b> 16-M8-2T	16	25	46	8.5	8	2	LNMU0303ZR	M2. 5X6. 5	T8
17-M8-2T	17	25	46	8.5	8	2			
20-M10-3T	20	30	49	10.5	10	3			
21-M10-3T	21	30	49	10.5	10	3			
25-M12-4T	25	35	57	12.5	12	4			
26-M12-4T	26	35	57	12.5	12	4			
32-M16-5T	32	40	63	17	16	5			
33-M16-5T	33	40	63	17	16	5			
35-M16-5T	35	40	63	17	16	5			

**MFH 03R**

京瓷双面四角快进给立铣刀 MILLING TOOLS

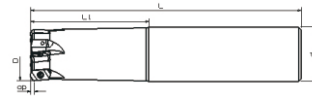

**NEW**

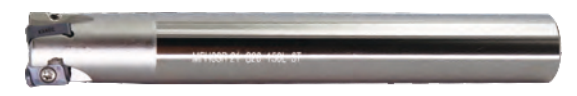

型号 Designation	尺寸Size(mm)						刀片型号 Inserts	刀片螺丝 Inserts Screw	扳手 Wrench
	Max.ap	D	d	L	L1	刃数 Teeth			
<b>MFH 03R</b> 016M15.0-02-150L	1.0	16	15	150	30	2	LOGU030310ER	M3X7. 5	T8
016M16.0-02-150L	1.0	16	16	150	50	2			
016M16.0-02-200L	1.0	16	16	150	70	2			
017M16.0-02-160L	1.0	17	16	160	30	2			
017M16.0-02-200L	1.0	17	16	200	30	2			
020M19.0-03-150L	1.0	20	19	150	30	3			
020M20.0-03-150L	1.0	20	20	150	70	3			
020M20.0-03-200L	1.0	20	20	200	90	3			
021M20.0-03-150L	1.0	21	20	150	30	3			
021M20.0-03-200L	1.0	21	20	200	30	4			
025M24.0-04-150L	1.0	25	24	150	35	4			
025M25.0-04-150L	1.0	25	25	150	70	4			
025M25.0-04-200L	1.0	25	25	200	100	5			
026M25.0-04-150L	1.0	26	25	150	35	5			
026M25.0-04-200L	1.0	26	25	200	35	5			
032M32.0-05-160L	1.0	32	32	160	70	5			
032M32.0-05-200L	1.0	32	32	200	120	5			
033M32.0-05-160L	1.0	33	32	160	40	5			
033M32.0-05-200L	1.0	33	32	200	40	5			
035M32.0-05-160L	1.0	35	32	160	45	5			
035M32.0-05-200L	1.0	35	32	200	45	8			

**MFWN 90°**

京瓷双面90°六角低阻力面铣刀盘 MILLING TOOLS

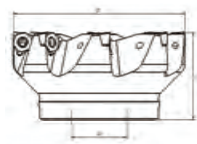

**NEW**



型号 Designation	尺寸Size(mm)						刀片型号 Inserts	刀片螺丝 Inserts Screw	扳手 Wrench
	Max.ap	D	d	L	L1	刃数 Teeth			
MFWN90063R-22-4T		63	22	40		4	WNMU080608	M5X12	T20
MFWN90080R-27-5T		80	27	50		5			
MFWN90100R-32-7T		100	32	50		7			
MFWN90125R-40-8T		125	40	63		8			
MFWN90160R-40-10T		160	40	63		10			
MFWN90200R-60-12T		200	60	63		12			
MFWN90250R-60-14T		250	60	63		14			

**MFH 03R**

京瓷双面四角快进给锁牙式立铣刀 MILLING TOOLS

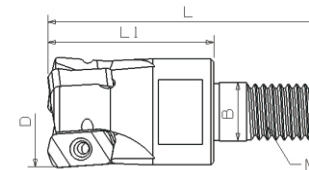

**NEW**



型号 Designation	尺寸Size(mm)						刀片型号 Inserts	刀片螺丝 Inserts Screw	扳手 Wrench
	D	L1	L	B	M	刃数 Teeth			
<b>MFH 03R</b> 16 - M 8 - 2 T	16	25	46	8.5	8	2	LOGU030310ER	M3X7. 5	T8
17 - M 8 - 2 T	17	25	46	8.5	8	2			
20 - M 10 - 3 T	20	30	49	10.5	10	3			
21 - M 10 - 3 T	21	30	49	10.5	10	3			
25 - M 12 - 4 T	25	35	57	12.5	12	4			
26 - M 12 - 4 T	26	35	57	12.5	12	4			
32 - M 16 - 5 T	32	40	63	17	16	5			
33 - M 16 - 5 T	33	40	63	17	16	5			
35 M 16 5 T	35	40	63	17	16	5			

**MFH 03R** 京瓷双面四角快进给面铣刀盘 MILLING TOOLS



**NEW**



型号 Designation	尺寸Size(mm)						刀片型号 Inserts	刀片螺丝 Inserts Screw	扳手 Wrench
	Max.ap	D	d	L	L1	刃数 Teeth			
<b>MFH 03R</b> 040M16.0-E05/E06	1.0	40	16	40		5/6	LOGU030310ER	M3X7.5	T8
050M22.0-E08/E05	1.0	50	22	50		5/8			
063M22.0-E08	1.0	53	22	50		8			

**MFH 03R 加工参数**

刀片形状	被加工材料	刀杆型号和进给(进给f:mm/) ap=0.5mm的推荐进给(基准值)								推荐刀片材质(切削速度Vc:m/min)			
		MFH16 -...-2T	MFH20 -...-3T	MFH20 -...-4T	MFH25 -...-4T	MFH25 -...-5T	MFH32 -...-5T	MFH32 -...-6T	MFH -...-R-03	MEGACOAT NANO			CVD 涂层
										PR1535	PR1525	PR1510	CA6535
GM	炭素钢 (Sxxc)	0.2 - 0.7 - 1.2	0.2-0.5-0.8	0.2-0.5-1.5	0.2-0.5-0.8	0.2-0.8-1.5	0.2-0.5-0.8	0.2-0.5-0.8	☆	★	-	-	
	120-180-250								120-180-250	-	-		
	合金钢 (SCM 等)	☆	★	-	-								
	100-160-220	100-160-220	-	-									
	模具钢 (SKD等)(~40HRC)	0.2 - 0.5 - 0.9	0.2-0.4-0.6	0.2-0.6-1.2	0.2-0.4-0.6	0.2-0.6-1.2	0.2-0.4-0.6	0.2-0.4-0.6	☆	★	-	-	
	80-140-180	80-140-180	-	-									
	模具钢 (SKD等)(40~50HRC)	0.2 - 0.3 - 0.5	0.2-0.25-0.3	0.2-0.3-0.6	0.2-0.25-0.3	0.2-0.3-0.6	0.2-0.25-0.3	0.2-0.25-0.3	☆	★	-	-	
	60-100-130	60-100-130	-	-									
	奥氏体不锈钢 (SUS304等)	0.2 - 0.5 - 0.9	0.2-0.4-0.6	0.2-0.6-1.2	0.2-0.4-0.6	0.2-0.6-1.2	0.2-0.4-0.6	0.2-0.4-0.6	☆	☆	-	-	
100-160-200	100-160-200								-	-			
150-200-250	-								-	★			
180-240-300	-	-	-	-									
马氏体不锈钢 (SUS403等)	0.2 - 0.7 - 1.2	0.2-0.5-0.8	0.2-0.8-1.5	0.2-0.5-0.8	0.2-0.8-1.5	0.2-0.5-0.8	0.2-0.5-0.8	-	-	★	-		
120-180-250								-	-	-			
析出硬化系不锈钢 (SUS630等)	0.2 - 0.5 - 0.9	0.2-0.4-0.6	0.2-0.6-1.2	0.2-0.4-0.6	0.2-0.6-1.2	0.2-0.4-0.6	0.2-0.4-0.6	☆	-	-	-		
20-30-50								-	-	★			
20-30-50	-	-	-	-									
灰铁 (FC)	0.2 - 0.3 - 0.6	0.2-0.25-0.4	0.2-0.4-0.8	0.2-0.25-0.4	0.2-0.4-0.8	0.2-0.25-0.4	0.2-0.25-0.4	☆	-	★	-		
40-60-80								-	★	-			
30-50-70	-	-	-	-									
球铁 (FCD)	0.2 - 0.3 - 0.5	0.2-0.4-0.6	0.2-0.6-1.2	0.2-0.4-0.6	0.2-0.6-1.2	0.2-0.4-0.6	0.2-0.4-0.6	-	-	★	-		
100-150-200								-	-	-			
Ni基耐热合金	0.2 - 0.25 - 0.3	0.2-0.25-0.4	0.2-0.4-0.8	0.2-0.25-0.4	0.2-0.4-0.8	0.2-0.25-0.4	0.2-0.25-0.4	-	-	☆	★		
20-30-50								-	-	★			
20-30-50	-	-	-	-									
钛合金 (Ti-6Al-4V)	0.2 - 0.4 - 0.6	0.2-0.4-0.6	0.2-0.4-0.6	0.2-0.4-0.6	0.2-0.4-0.6	0.2-0.4-0.6	0.2-0.4-0.6	★	-	★	-		
40-60-80								-	★	-			

**MFH 01R** 京瓷小径高速直角/圆弧立铣刀 MILLING TOOLS

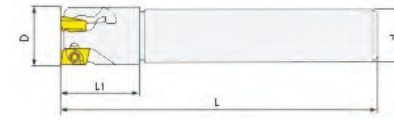

**NEW**



型号 Designation	尺寸Size(mm)						刀片型号 Inserts	刀片螺丝 Inserts Screw	扳手 Wrench
	Max.ap	D	d	L	L1	刃数 Teeth			
MFH 08-S10-01-1T		8	10	100		1	LPGT010210ER	M1.8X4	T6
MFH 10-S10-01-2T		10	10	100		2			
MFH 12-S12-01-3T		12	12	100		3			
MFH 14-S12-01-3T		14	12	100		3			
MFH 16-S16-01-4T		16	16	100		4			

**MFH 01R** 京瓷小径高速直角锁牙式立铣刀 MILLING TOOLS

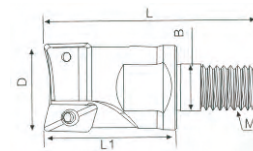

**NEW**



型号 Designation	尺寸Size(mm)						刀片型号 Inserts	刀片螺丝 Inserts Screw	扳手 Wrench
	Max.ap	D	d	L	L1	刃数 Teeth			
MFH 08-M06-01-1T		8	6.5	31.5		1	LPGT010210ER	M1.8X4	T6
MFH 10-M06-01-2T		10	6.5	31.5		2			
MFH 12-M06-01-3T		12	6.5	31.5		3			
MFH 14-M06-01-3T		14	6.5	31.5		3			
MFH 16-M08-01-4T		16	8.5	40		4			

**MFH 01R 加工参数**

断屑槽	被加工材料	刀杆型号和进给(进给fz:mm/ft) ap=0.3mm的推荐进给(基准值)					推荐刀片材质(切削速度Vc:m/min)		
		MFH08-...-1T	MFH10-...-2T	MFH12-...-3T	MFH14-...-3T	MFH16-...-4T	MEGACOAT NANO		CVD 涂层
							PR1535	PR1510	CA6535
GM	炭素钢 (Sxxc)	0.2 - 0.4 - 0.6			0.2 - 0.5 - 0.8	★	☆	-	
	120-180-250					120-180-250	-		
	合金钢 (SCM 等)	★	☆	-					
	100-160-220	100-160-220	-						
	模具钢 (SKD等)(~40HRC)	0.2 - 0.3 - 0.5			0.2 - 0.4 - 0.6	★	☆	-	
	80-140-180	80-140-180	-						
	模具钢 (SKD等)(40~50HRC)	0.2 - 0.25 - 0.3			0.2 - 0.25 - 0.4	★	☆	-	
	60-100-130	60-100-130	-						
	奥氏体不锈钢 (SUS304等)	0.2 - 0.3 - 0.5			0.2 - 0.4 - 0.6	☆	★	-	
	100-160-220					100-160-220	-		
	150-200-250					-	★		
	180-240-300	-	-	-					
马氏体不锈钢 (SUS403等)	0.2 - 0.4 - 0.6			0.2 - 0.5 - 0.8	★	-	-		
120-180-250					-	-			
析出硬化系不锈钢 (SUS630等)	0.2 - 0.3 - 0.5			0.2 - 0.4 - 0.6	-	★	-		
90-120-150					-	-			
灰铁 (FC)	0.2 - 0.4 - 0.6			0.2 - 0.5 - 0.8	★	-	-		
120-180-250					-	-			
球铁 (FCD)	0.2 - 0.3 - 0.5			0.2 - 0.4 - 0.6	★	-	-		
100-150-200					-	-			
Ni基耐热合金	0.2 - 0.25 - 0.3			0.2 - 0.25 - 0.4	-	☆	★		
20-30-50					-	★			
20-30-50	-	-	-						
钛合金 (Ti-6Al-4V)	0.2 - 0.4 - 0.6			0.2 - 0.5 - 0.8	★	-	-		
120-180-250					-	-			



**MFH 14R**

京瓷高进给面铣刀盘

MILLING TOOLS

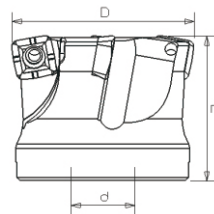

**NEW**



型号 Designation	尺寸Size(mm)						刀片型号 Inserts	刀片螺丝 Inserts Screw	扳手 Wrench
	Max.ap	D	d	L	L1	刃数 Teeth			
<b>MFH 14R</b> 50R-22-4T		50	22	50		4	S0MT140520ER	M5X12	T20
63R-22-4T		63	22	50		4			
80R-27-5T		80	27	50		5			

**MFH 14R 加工参数**

刀片形状	被加工材料	刀杆型号和进给(进给亿z:mm/t)					推荐刀片材质(切削速度Vc:m/min)			
		MFH25-	MFH32-	MFH40-	MFH...R-10	MFH...-14	MEGACOAT NANO			CVD 涂层
							PR1535	PR1525	PR1510	
GM	炭素钢 (Sxxc)	0.5-0.8-1.0 (aps1.0mm) 0.2-0.4-0.5 (aps1.5mm)	0.5-1.0-1.5 (aps1.0mm) 0.3-0.7-1.0 (aps1.5mm)	0.5-1.2-1.8 (aps1.0mm) 0.4-1.0-1.5 (aps1.5mm)	0.5 - 1.5 - 2.0	☆ 120-180-250	★ 120-180-250	-	-	
	合金钢 (SCM 等)	0.5-0.8-1.0 (aps1.0mm) 0.2-0.4-0.5 (aps1.5mm)	0.5-1.0-1.5 (aps1.0mm) 0.3-0.7-1.0 (aps1.5mm)	0.5-1.2-1.8 (aps1.0mm) 0.4-1.0-1.5 (aps1.5mm)	0.5 - 1.5 - 2.0	☆ 100-160-220	★ 100-160-220	-	-	
	模具钢 (SKD 等)(~40HRC)	0.5-0.7-0.8 (aps1.0mm) 0.2-0.3-0.4 (aps1.5mm)	0.5-0.8-1.2 (aps1.0mm) 0.3-0.6-0.8 (aps1.5mm)	0.5-1.0-1.6 (aps1.0mm) 0.4-0.8-1.2 (aps1.5mm)	0.5 - 1.2 - 1.8	☆ 80-140-180	★ 80-140-180	-	-	
	模具钢 (SKD 等)(40~50HRC)	0.15-0.3-0.5 (aps1.0mm) 0.15-0.2-0.25 (aps1.5mm)	0.2-0.5-0.8 (aps1.0mm) 0.2-0.3-0.45 (aps1.5mm)	0.2-0.6-0.9 (aps1.0mm) 0.2-0.5-0.7 (aps1.5mm)	0.2 - 0.7 - 1.0	☆ 60-100-130	★ 60-100-130	-	-	
	奥氏体不锈钢 (SUS304等)	0.5-0.7-0.8 (aps1.0mm) 0.2-0.3-0.7 (aps1.5mm)	0.5-0.8-1.2 (aps1.0mm) 0.3-0.6-0.8 (aps1.5mm)	0.5-1.0-1.6 (aps1.0mm) 0.4-0.8-1.2 (aps1.5mm)	0.5 - 1.2 - 1.8	☆ 100-160-200	☆ 100-160-200	-	-	
	马氏体不锈钢 (SUS403等)	0.5-0.7-0.8 (aps1.0mm) 0.2-0.3-0.4 (aps1.5mm)	0.5-0.8-1.2 (aps1.0mm) 0.3-0.6-0.8 (aps1.5mm)	0.5-1.0-1.6 (aps1.0mm) 0.4-0.8-1.2 (aps1.5mm)	0.5 - 1.2 - 1.8	☆ 150-200-250	-	-	★ 180-240-300	
	析出硬化系不锈钢 (SUS630等)	0.5-0.7-0.8 (aps1.0mm) 0.2-0.3-0.4 (aps1.5mm)	0.5-0.8-1.2 (aps1.0mm) 0.3-0.6-0.8 (aps1.5mm)	0.5-1.0-1.6 (aps1.0mm) 0.4-0.8-1.2 (aps1.5mm)	0.5 - 1.2 - 1.8	★ 90-120-150	-	-	-	
	灰铁 (FC)	0.5-0.8-1.0 (aps1.0mm) 0.2-0.4-0.5 (aps1.5mm)	0.5-1.0-1.5 (aps1.0mm) 0.3-0.7-1.5 (aps1.5mm)	0.5-1.2-1.8 (aps1.0mm) 0.4-1.0-1.5 (aps1.5mm)	0.5 - 1.2 - 2.0	-	-	★ 120-180-250	-	
	球铁 (FCD)	0.5-0.7-0.8 (aps1.0mm) 0.2-0.3-0.4 (aps1.5mm)	0.5-0.8-1.2 (aps1.0mm) 0.3-0.6-0.8 (aps1.5mm)	0.5-1.0-1.6 (aps1.0mm) 0.4-0.8-1.2 (aps1.5mm)	0.5 - 1.2 - 1.8	-	-	★ 100-150-200	-	
	Ni基耐热合金	0.2-0.4-0.6 (aps1.0mm) 0.15-0.2-0.3 (aps1.5mm)	0.2-0.5-0.9 (aps1.0mm) 0.2-0.4-0.6 (aps1.5mm)	0.2-0.6-1.0 (aps1.0mm) 0.2-0.5-0.8 (aps1.5mm)	0.2 - 0.8 - 1.2	☆ 20-30-50	-	-	★ 20-30-50	
钛合金 (Ti-6Al-4V)	0.2-0.4-0.6 (aps1.0mm) 0.15-0.2-0.3 (aps1.5mm)	0.2-0.5-0.9 (aps1.0mm) 0.2-0.4-0.6 (aps1.5mm)	0.2-0.6-1.0 (aps1.0mm) 0.2-0.5-0.8 (aps1.5mm)	0.2 - 0.8 - 1.2	★ 40-60-80	-	★ 30-50-70	-		

**MXN**

黛杰双面四角快魔王立铣刀

MILLING TOOLS

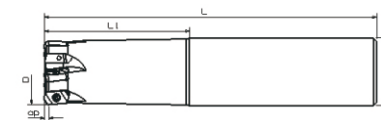

**NEW**



型号 Designation	尺寸Size(mm)						刀片型号 Inserts	刀片螺丝 Inserts Screw	扳手 Wrench
	Max.ap	D	d	L	L1	刃数 Teeth			
<b>MXN</b> 016M15.0-02-150L	1.0	16	15	150	30	2	ENMU100412ZER	M2. 5X6. 5	T8
016M16.0-02-150L	1.0	16	16	150	50	2			
016M16.0-02-200L	1.0	16	16	150	70	2			
017M16.0-02-160L	1.0	17	16	160	30	2			
017M16.0-02-200L	1.0	17	16	200	30	2			
020M19.0-03-150L	1.0	20	19	150	30	3			
020M20.0-03-150L	1.0	20	20	150	70	3			
020M20.0-03-200L	1.0	20	20	200	90	3			
021M20.0-03-150L	1.0	21	20	150	30	3			
021M20.0-03-200L	1.0	21	20	200	30	4			
025M24.0-04-150L	1.0	25	24	150	35	4			
025M25.0-04-150L	1.0	25	25	150	70	4			
025M25.0-04-200L	1.0	25	25	200	100	5			
026M25.0-04-150L	1.0	26	25	150	35	5			
026M25.0-04-200L	1.0	26	25	200	35	5			
032M32.0-05-160L	1.0	32	32	160	70	5			
032M32.0-05-200L	1.0	32	32	200	120	5			
033M32.0-05-160L	1.0	33	32	160	40	5			
033M32.0-05-200L	1.0	33	32	200	40	5			
035M32.0-05-160L	1.0	35	32	160	45	5			
035M32.0-05-200L	1.0	35	32	200	45	8			

**GMX**

黛杰双面四角快魔王面铣刀盘

MILLING TOOLS



**NEW**



型号 Designation	尺寸Size(mm)						刀片型号 Inserts	刀片螺丝 Inserts Screw	扳手 Wrench
	Max.ap	D	d	L	L1	刃数 Teeth			
<b>GMX</b> 040M16.0-E05/E06	1.0	40	16	40		5/6	ENMU100412ZER	M2. 5X6. 5	T8
050M22.0-E08/E05	1.0	50	22	50		5/8			
063M22.0-E08	1.0	53	22	50		8			

**MXG** 黛杰双面四角快魔王锁牙式刀 MILLING TOOLS

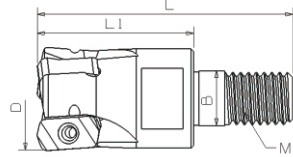

**NEW**



型号 Designation	尺寸Size(mm)						刀片型号 Inserts	刀片螺丝 Inserts Screw	扳手 Wrench
	D	L1	L	B	M	刃数 Teeth			
<b>MXG</b> 16-M 8-2 T	16	25	46	8.5	8	2	ENMU100412ZER	M2. 5X6. 5	T8
17-M 8-2 T	17	25	46	8.5	8	2			
20-M 10-3 T	20	30	49	10.5	10	3			
21-M 10-3 T	21	30	49	10.5	10	3			
25-M 12-4 T	25	35	57	12.5	12	4			
26-M 12-4 T	26	35	57	12.5	12	4			
32-M 16-5 T	32	40	63	17	16	5			
33-M 16-5 T	33	40	63	17	16	5			
35-M 16-5 T	35	40	63	17	16	5			

**TEBL** 特固克双面四角快进给锁牙式刀 MILLING TOOLS

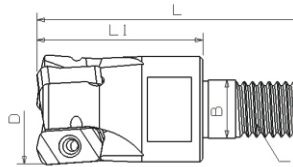

**NEW**



型号 Designation	尺寸Size(mm)						刀片型号 Inserts	刀片螺丝 Inserts Screw	扳手 Wrench
	D	L1	L	B	M	刃数 Teeth			
<b>TEBL</b> 16-M 8-2 T	16	25	46	8.5	8	2	BLMP0603	M2. 5X6. 5	T8
17-M 8-2 T	17	25	46	8.5	8	2			
20-M 10-3 T	20	30	49	10.5	10	3			
21-M 10-3 T	21	30	49	10.5	10	3			
25-M 12-4 T	25	35	57	12.5	12	4			
26-M 12-4 T	26	35	57	12.5	12	4			
32-M 16-5 T	32	40	63	17	16	5			
33-M 16-5 T	33	40	63	17	16	5			
35-M 16-5 T	35	40	63	17	16	5			

**TEBL** 特固克双面四角快进给立铣刀 MILLING TOOLS

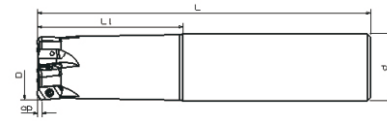

**NEW**



型号 Designation	尺寸Size(mm)						刀片型号 Inserts	刀片螺丝 Inserts Screw	扳手 Wrench
	Max.ap	D	d	L	L1	刃数 Teeth			
<b>TEBL</b> 016M15.0-02-150L	1.0	16	15	150	30	2	BLMP0603	M2. 5X6. 5	T8
016M16.0-02-150L	1.0	16	16	150	50	2			
016M16.0-02-200L	1.0	16	16	150	70	2			
017M16.0-02-160L	1.0	17	16	160	30	2			
017M16.0-02-200L	1.0	17	16	200	30	2			
020M19.0-03-150L	1.0	20	19	150	30	3			
020M20.0-03-150L	1.0	20	20	150	70	3			
020M20.0-03-200L	1.0	20	20	200	90	3			
021M20.0-03-150L	1.0	21	20	150	30	3			
021M20.0-03-200L	1.0	21	20	200	30	4			
025M24.0-04-150L	1.0	25	24	150	35	4			
025M25.0-04-150L	1.0	25	25	150	70	4			
025M25.0-04-200L	1.0	25	25	200	100	5			
026M25.0-04-150L	1.0	26	25	150	35	5			
026M25.0-04-200L	1.0	26	25	200	35	5			
032M32.0-05-160L	1.0	32	32	160	70	5			
032M32.0-05-200L	1.0	32	32	200	120	5			
033M32.0-05-160L	1.0	33	32	160	40	5			
033M32.0-05-200L	1.0	33	32	200	40	5			
035M32.0-05-160L	1.0	35	32	160	45	5			
035M32.0-05-200L	1.0	35	32	200	45	8			

**TEBL** 特固克双面四角快进给面铣刀盘 MILLING TOOLS



**NEW**



型号 Designation	尺寸Size(mm)						刀片型号 Inserts	刀片螺丝 Inserts Screw	扳手 Wrench
	Max.ap	D	d	L	L1	刃数 Teeth			
<b>TEBL</b> 040M16.0-E05/E06	1.0	40	16	40		5/6	BLMP0603	M2. 5X6. 5	T8
050M22.0-E08/E05	1.0	50	22	50		5/8			
063M22.0-E08	1.0	53	22	50		8			

**BNM** 黛杰球头精加工立铣刀 MILLING TOOLS

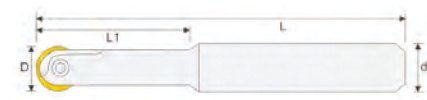
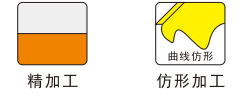

型号 Designation	尺寸Size(mm)				刀片型号 Inserts	刀片螺丝 Inserts Screw	扳手 Wrench
	D	d	L1	L			
<b>BNM-4R</b> 8D10d100L	8	10	28	100	BNM-080	BNM4R	T8
8D10d130L	8	10	28	130			
8D12d130L	8	12	50	130			
8D12d160L	8	12	65	160			
<b>BNM-5R</b> 10D10d100L	10	10	28	100	BNM-100	BNM5R	T15
10D12d130L	10	12	32	130			
10D12d160L	10	12	32	160			
<b>BNM-6R</b> 12D12d130L	12	12	32	130	BNM-120	BNM6R	T20
12D12d160L	12	12	32	160			
12D16d160L	12	16	32	160			
<b>BNM-8R</b> 16D16d130L	16	16	65	130	BNM-160	BNM8R	T20
16D16d160L	16	16	65	160			
16D16d200L	16	16	65	200			
<b>BNM-10R</b> 20D20d160L	20	20	35	160	BNM-200	BNM10R	T20
20D20d200L	20	20	90	200			
20D25d160L	20	25	100	160			
20D25d200L	20	25	100	200			
20D25d250L	20	25	100	250			
<b>BNM-12.5R</b> 25D25d160L	25	25	45	160	BNM-250	BNM12.5R	T20
25D25d200L	25	25	100	200			
25D25d250L	25	25	100	250			
25D32d200L	25	32	100	200			
25D32d250L	25	32	100	250			
<b>BNM-15R</b> 30D32d200L	32	32	100	200	BNM-300	BNM15R	T30
30D32d250L	32	32	100	250			
30D32d300L	32	32	100	300			

适用刀片INSERTS:黛杰 DIJET

**BNM** 黛杰球头精加工立铣刀 MILLING TOOLS

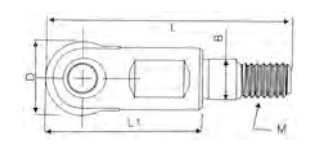
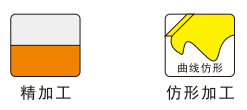

型号 Designation	尺寸Size(mm)						刀片型号 Inserts	刀片螺丝 Inserts Screw	扳手 Wrench
	D	L1	L	B	M	刃数 Teeth			
<b>BNM</b> R5-M5-1T	10	20	34.5	5.5	5	1	BNM-100	BNM5R	T15
R6-M6-1T	12	20	34.5	6.5	6	1	BNM-120	BNM6R	T20
R8-M8-1T	16	28	46	8.5	8	1	BNM-160	BNM8R	T20
R10-M10-1T	20	30	46	10.5	10	1	BNM-200	BNM10R	T20
R12.5-M12-1T	25	35	57	12.5	12	1	BNM-250	BNM12R	T20
R15-M16-1T	30	40	63	12.5	16	1	BNM-300	BNM15R	T30

适用刀片INSERTS:黛杰 DIJET

**T2139** 瓦尔特球头精加工立铣刀 MILLING TOOLS

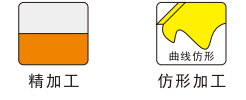

型号 Designation	尺寸Size(mm)				刀片型号 Inserts	刀片螺丝 Inserts Screw	扳手 Wrench
	D	d	L1	L			
<b>T2139-4R</b> 8D10d100L	8	10	28	100	P3202-D08	T2139-D08	T8
8D10d130L	8	10	28	130			
8D12d130L	8	12	50	130			
8D12d160L	8	12	65	160			
<b>T2139-5R</b> 10D10d100L	10	10	28	100	P3202-D10	T2139-D10	T15
10D12d130L	10	12	32	130			
10D12d160L	10	12	32	160			
<b>T2139-6R</b> 12D12d130L	12	12	32	130	P3202-D12	T2139-D12	T20
12D12d160L	12	12	32	160			
12D16d160L	12	16	32	160			
<b>T2139-8R</b> 16D16d130L	16	16	65	130	P3202-D16	T2139-D16	T20
16D16d160L	16	16	65	160			
16D16d200L	16	16	65	200			
<b>T2139-10R</b> 20D20d160L	20	20	35	160	P3202-D20	T2139-D20	T20
20D20d200L	20	20	90	200			
20D25d160L	20	25	100	160			
20D25d200L	20	25	100	200			
20D25d250L	20	25	100	250			
<b>T2139-12.5R</b> 25D25d160L	25	25	45	160	P3202-D25	T2139-D25	T20
25D25d200L	25	25	100	200			
25D25d250L	25	25	100	250			
25D32d200L	25	32	100	200			
25D32d250L	25	32	100	250			
<b>T2139-16R</b> 32D32d200L	32	32	100	200	P3202-D32	T2139-D32	T30
32D32d250L	32	32	100	250			
32D32d300L	32	32	100	300			

适用刀片INSERTS:瓦尔特 WALTER

**T2139** 瓦尔特精加工锁牙式立铣刀 MILLING TOOLS

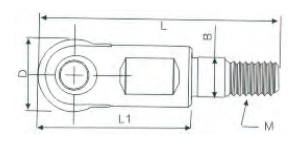
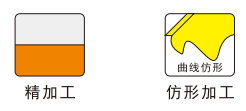

型号 Designation	尺寸Size(mm)						刀片型号 Inserts	刀片螺丝 Inserts Screw	扳手 Wrench
	D	L1	L	B	M	刃数 Teeth			
<b>T2139</b> R5-M5-1T	10	20	34.5	5.5	5	1	PD3202-D10	D10	T15
R6-M6-1T	12	20	34.5	6.5	6	1	PD3202-D12	D12	T20
R8-M8-1T	16	28	46	8.5	8	1	PD3202-D16	D16	T20
R10-M10-1T	20	30	46	10.5	10	1	PD3202-D20	D20	T20
R12.5-M12-1T	25	35	57	12.5	12	1	PD3202-D25	D25	T20
R15-M16-1T	30	40	63	12.5	16	1	PD3202-D30	D30	T30

适用刀片INSERTS:瓦尔特 WALTER



**ABPF** 日立球头精加工立铣刀 MILLING TOOLS

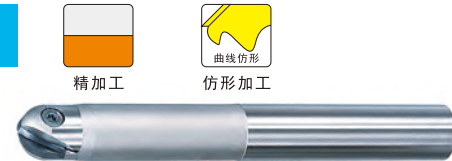

型号 Designation	尺寸Size(mm)				刀片型号 Inserts	刀片螺丝 Inserts Screw	扳手 Wrench
	D	d	L1	L			
<b>ABPF4R</b> 8D10d100L	8	10	28	100	ZPFG-080	ABPF4R	T8
8D10d130L	8	10	28	130			
8D12d130L	8	12	50	130			
8D12d160L	8	12	65	160	ZPFG-100	ABPF5R	T15
<b>ABPF5R</b> 10D10d100L	10	10	28	100			
10D12d130L	10	12	32	130			
10D12d160L	10	12	32	160	ZPFG-120	ABPF6R	T20
<b>ABPF6R</b> 12D12d130L	12	12	32	130			
12D12d160L	12	12	32	160			
12D16d160L	12	16	32	160	ZPFG-160	ABPF8R	T20
<b>ABPF6R</b> 16D16d130L	16	16	65	130			
16D16d160L	16	16	65	160			
16D16d200L	16	16	65	200			
<b>ABPF10R</b> 20D20d160L	20	20	35	160	ZPFG-200	ABPF10R	T20
20D20d200L	20	20	90	200			
20D25d160L	20	25	100	160			
20D25d200L	20	25	100	200			
20D25d250L	20	25	100	250			
<b>ABPF12.5R</b> 25D25d160L	25	25	45	160	ZPFG-250	ABPF12.5R	T20
25D25d200L	25	25	100	200			
25D25d250L	25	25	100	250			
25D32d200L	25	32	100	200			
25D32d250L	25	32	100	250			
<b>ABPF15R</b> 30D32d200L	32	32	100	200	ZPFG-300	ABPF15R	T30
30D32d250L	32	32	100	250			
30D32d300L	32	32	100	300			

适用刀片INSERTS:日立 HITACHI

**ABPF** 日立球头精加工立铣刀 MILLING TOOLS

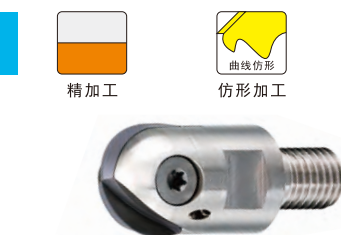
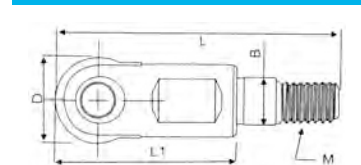

型号 Designation	尺寸Size(mm)						刀片型号 Inserts	刀片螺丝 Inserts Screw	扳手 Wrench
	D	L1	L	B	M	刃数 Teeth			
<b>ABPF R5-M5-1T</b>	10	20	34.5	5.5	5	1	ZPFG100-G ZPFG100-W	D10	T15
R6-M6-1T	12	20	34.5	6.5	6	1	ZPFG120-G ZPFG120-W	D12	T20
R8-M8-1T	16	28	46	8.5	8	1	ZPFG160-G ZPFG160-W	D16	T20
R10-M10-1T	20	30	46	10.5	10	1	ZPFG200-G ZPFG200-W	D20	T20
R12.5-M12-1T	25	35	57	12.5	12	1	ZPFG250-G ZPFG250-W	D25	T20
R15-M16-1T	30	40	63	12.5	16	1	ZPFG300-G ZPFG300-W	D30	T30

适用刀片INSERTS:日立 HITACHI

**BCF** 日立球形中粗铣刀 MILLING TOOLS

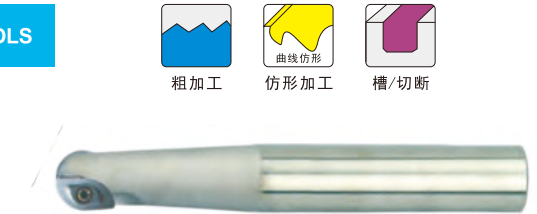
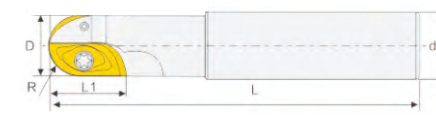

型号 Designation	尺寸Size(mm)					刀片型号 Inserts	
	D	d	L1	L	刃数 Teeth	主刃 Master Insert	副刃 Slave Lnsert
<b>BCF10R</b> 20D20d160L2T	20	20	60	160	2	ZCEW100CE	ZCEW100SE
20D20d200L2T	20	20	70	200	2		
20D25d160L2T	20	25	60	160	2		
20D25d200L2T	20	25	70	200	2		
20D25d250L2T	20	25	80	250	2		
<b>BCF12.5R</b> 25D25d160L2T	25	25	60	160	2	ZCEW125CE	ZCEW125SE
25D25d200L2T	25	25	70	200	2		
25D32d250L2T	25	32	80	250	2		
25D32d300L2T	25	32	90	300	2		
<b>BCF15R</b> 30D32d160L2T	30	32	60	160	2	ZCEW150CE	ZCEW150SE
30D32d200L2T	30	32	70	200	2		
30D32d250L2T	30	32	80	250	2		
30D32d300L2T	30	32	110	300	2		

通用刀片INSERTS:日立 HITACHI

**BCFL** 日立球形中粗铣刀(长柄型) MILLING TOOLS

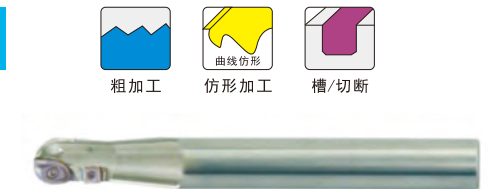

型号 Designation	尺寸Size(mm)					刀片型号 Inserts		
	D	d	L1	L	刃数 Teeth	主刃 Master Insert	副刃 Slave Lnsert	外周刃 Peripheral Insert
<b>BCFL10R</b> 20D20d160L2T	20	20	60	160	2	ZCEW100CE	ZCEW100SE	CPMT080804
20D20d200L2T	20	20	70	200	2			
20D25d160L2T	20	25	60	160	2			
20D25d200L2T	20	25	70	200	2			
20D25d250L2T	20	25	80	250	2	ZCEW125CE	ZCEW125SE	CPMT090308
<b>BCFL12.5R</b> 25D25d160L2T	25	25	60	160	2			
25D25d200L2T	25	25	70	200	2			
25D32d160L2T	25	32	70	160	2			
25D32d200L2T	25	32	80	200	2			
25D32d250L2T	25	32	90	250	2			
25D32d300L2T	25	32	105	300	2	ZCEW150CE	ZCEW150SE	CPMT090308
<b>BCFL15R</b> 30D32d160L2T	30	32	60	160	2			
30D32d200L2T	30	32	70	200	2			
30D32d250L2T	30	32	80	250	2			
30D32d300L2T	30	32	100	300	2			

适用刀片INSERTS:日立 HITACHI



**ASM07** 小径高速直角/圆弧立铣刀 MILLING TOOLS



型号 Designation	尺寸Size(mm)					刀片型号 Inserts	刀片螺丝 Inserts Screw	扳手 Wrench
	D	d	L1	L	刃数 Teeth			
<b>ASM07</b> 8D10d75L1T	8	10	16	75	1	JDMT070208 EDMT070220TR	M1.8X4	T6
10D10d120L2T	10	10	20	120	2			
11D10d120L2T	11	10	20	120	2			
12D10d120L2T	12	10	25	120	2			
12D12d120L2T	12	12	25	120	2			
13D12d120L2T	13	12	25	120	2			
14D12d120L3T	14	12	25	120	3			
16D16d160L4T	16	16	50	160	4			
17D16d160L4T	17	16	50	160	4			

适用刀片INSERTS:日立 HITACHI

**ASM07** 小径高速直角锁牙式立铣刀 MILLING TOOLS

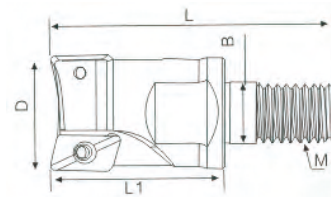

型号 Designation	尺寸Size(mm)						刀片型号 Inserts	刀片螺丝 Inserts Screw	扳手 Wrench
	D	L1	L	B	M	刃数 Teeth			
<b>ASM07</b> 8 - M 4 - 1 T	8	20	34.5	4.5	4	1	JDMT070208R EDMT070220R	1.8X4	T6
9 - M 4 - 1 T	9	20	34.5	4.5	4	1			
10 - M 5 - 2 T	10	20	34.5	5.5	5	2			
10 - M 6 - 2 T	10	20	34.5	6.5	6	2			
11 - M 5 - 2 T	11	20	34.5	5.5	5	2			
11 - M 6 - 2 T	11	20	34.5	6.5	6	2			
12 - M 6 - 2 T	12	20	34.5	6.5	6	2			
13 - M 6 - 2 T	13	20	34.5	6.5	6	2			
16 - M 8 - 4 T	16	28	46	8.5	8	4			
17 - M 8 - 4 T	17	28	46	8.5	8	4			

适用刀片INSERTS:日立 HITACHI

**ARX2.5R** 小径圆角立铣刀 MILLING TOOLS



型号 Designation	尺寸Size(mm)					刀片型号 Inserts	刀片螺丝 Inserts Screw	扳手 Wrench
	D	d	L1	L	刃数 Teeth			
<b>ARX2.5R</b> 10D10d120L2T	10	10	20	120	2	RDMW0517MOE	M2X4.5	T6
11D10d120L2T	11	10	20	120	2			
12D10d120L2T	12	10	20	120	2			
12D12d120L2T	12	12	20	120	2			
13D12d120L2T	13	12	20	120	2			

适用刀片INSERTS:三菱 MITSUBISHI

**TAP300R** 锁牙式立铣刀 MILLING TOOLS

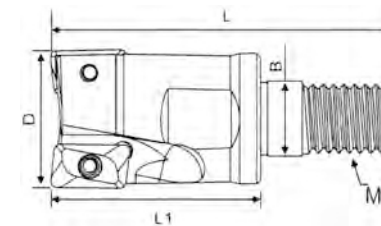

型号 Designation	尺寸Size(mm)						刀片型号 Inserts	刀片螺丝 Inserts Screw	扳手 Wrench
	D	L1	L	B	M	刃数 Teeth			
<b>TAP300R</b> 16 - M 8 - 2 T	16	28	46	8.5	8	2	APMT1135PDER	M2.5X6	T8
17 - M 8 - 2 T	17	28	46	8.5	8	2			
20 - M 10 - 2 T	20	30	49	10.5	10	2			
21 - M 10 - 2 T	21	30	49	10.5	10	2			
25 - M 12 - 3 T	25	35	57	12.5	12	3			
26 - M 12 - 3 T	26	35	57	12.5	12	3			

适用刀片INSERTS:三菱 MITSUBISHI

**TAP300R**

## 直角台阶立铣刀

MILLING TOOLS



型号 Designation	尺寸Size(mm)					刀片型号 Inserts	刀片螺丝 Inserts Screw	扳手 Wrench
	D	d	L1	L	刃数 Teeth			
<b>TAP300R</b> 10D10d100L1T	10	10	25	100	1	APMT1135PDER	M2.5X6	T8
11D10d130L1T	11	10	25	130	1			
12D12d130L1T	12	12	25	130	1			
13D12d130L1T	13	12	25	130	1			
16D15d120L2T	16	15	40	120	2			
16D15d160L2T	16	15	40	160	2			
16D15d200L2T	16	15	40	200	2			
16D15.6d160L2T	16	15.6	50	160	2			
16D15.6d200L2T	16	15.6	50	200	2			
16D16d120L2T	16	16	40	120	2			
16D16d160L2T	16	16	50	160	2			
16D16d200L2T	16	16	60	200	2			
16D16d250L2T	16	16	60	250	2			
17D16d120L2T	17	16	30	120	2			
17D16d160L2T	17	16	30	160	2			
17D16d200L2T	17	16	30	200	2			
17D16d250L2T	17	16	30	250	2			
20D19d160L2T	20	19	35	160	2			
20D19d200L2T	20	19	35	200	2			
20D20d120L2T	20	20	50	120	2			
20D20d160L2T	20	20	60	160	2			
20D20d200L2T	20	20	70	200	2			
20D20d250L2T	20	20	70	250	2			
21D20d160L2T	21	20	35	160	2			
21D20d200L2T	21	20	35	200	2			
21D20d250L2T	21	20	35	250	2			
25D25d150L3/4T	25	25	40	150	3/4			
25D25d200L3/4T	25	25	70	200	3/4			
26D25d150L3/4T	26	25	40	150	3/4			
26D25d200L3/4T	26	25	40	200	3/4			
30D25d150L3/4T	30	25	40	150	3/4			
30D25d200L3/4T	30	25	40	200	3/4			
30D25d250L3/4T	30	25	40	250	3/4			

适用刀片INSERTS:三菱 MITSUBISHI

**TAP400R**

## 直角台阶立铣刀

MILLING TOOLS



型号 Designation	尺寸Size(mm)					刀片型号 Inserts	刀片螺丝 Inserts Screw	扳手 Wrench
	D	d	L1	L	刃数 Teeth			
<b>TAP400R</b> 25D24d150L2T	25	24	50	150	2	APMT1604PDER	M4X8	T15
25D24d200L2T	25	24	50	200	2			
25D24d250L2T	25	24	50	250	2			
25D25d150L2T	25	25	70	150	2			
25D25d200L2T	25	25	70	200	2			
25D25d250L2T	25	25	80	250	2			
26D25d150L2T	26	25	50	150	2			
26D25d200L2T	26	25	50	200	2			
26D25d250L2T	26	25	50	250	2			
26D25d300L2T	26	25	50	300	2			
30D25d150L2T	30	25	40	150	2			
30D25d200L2T	30	25	40	200	2			
30D25d250L2T	30	25	40	250	2			
32D25d150L2T	32	25	40	150	2			
32D25d200L2T	32	25	40	200	2			
32D25d250L2T	32	25	40	250	2			
32D32d150L3T	32	32	48	150	3			
32D32d200L3T	32	32	48	200	3			
32D32d250L3T	32	32	48	250	3			
32D32d300L3T	32	32	48	300	3			
35D32d150L3T	35	32	60	150	3			
35D32d200L3T	35	32	60	200	3			
35D32d250L3T	35	32	60	250	3			
35D32d300L3T	35	32	60	300	3			
40D32d200L3T	40	32	60	200	3			
40D32d250L3T	40	32	60	250	3			
40D32d300L3T	40	32	60	300	3			

适用刀片INSERTS:三菱 MITSUBISHI

**TAP400R**

锁牙式立铣刀头

MILLING TOOLS

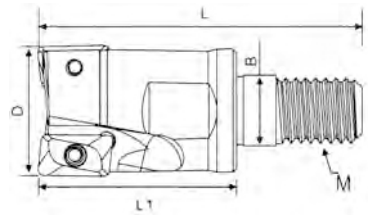

型号 Designation	尺寸Size(mm)						刀片型号 Inserts	刀片螺丝 Inserts Screw	扳手 Wrench
	D	L1	L	B	M	刃数 Teeth			
<b>TAP400R</b> 25-M12-2T	25	35	57	12.5	12	2	APMT160PDER	M4.0X9	T15
26-M12-2T	26	35	57	12.5	12	2			
30-M12-2T	30	35	57	12.5	12	2			
32-M16-3T	32	40	63	17	16	3			
35-M16-3T	35	40	63	17	16	3			
40-M16-3T	40	40	63	17	16	3			

适用刀片INSERTS:三菱 MITSUBISHI

**RAP400R**

平面铣刀盘

MILLING TOOLS

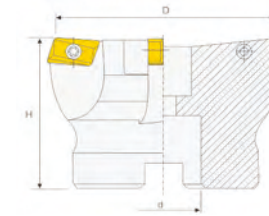

型号 Designation	尺寸Size(mm)				刀片型号 Inserts	刀片螺丝 Inserts Screw	扳手 Wrench
	D	d	L	刃数 Teeth			
<b>RAP400R</b> 63D22d50L4T	63	22	50	4	APMT1604PDER	M4X9	T15
80D27d50L5T	80	27	50	5			
100D32d50L6T	100	32	50	6			
125D40d63L7T	125	40	63	7			
160D40d63L8T	160	40	63	8			

适用刀片INSERTS:三菱 MITSUBISHI

**TAP400R**

直角平面铣刀盘

MILLING TOOLS

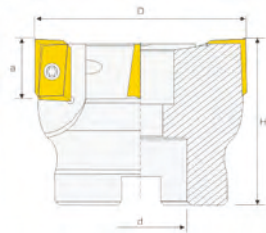

型号 Designation	尺寸Size(mm)				刀片型号 Inserts	刀片螺丝 Inserts Screw	扳手 Wrench
	D	d	L	刃数 Teeth			
<b>TAP400R</b> 50D22d50L4T	50	22	50	4	APMT1604PDER	M4X9	T15
63D22d50L4T	63	22	50	4			
80D27d50L5T	80	27	50	5			
100D32d50L6T	100	32	50	6			
125D40d63L8T	125	40	63	8			
160D40d63L8T	160	40	63	8			

适用刀片INSERTS:三菱 MITSUBISHI

**ERP4R**

锁牙式立铣刀头

MILLING TOOLS

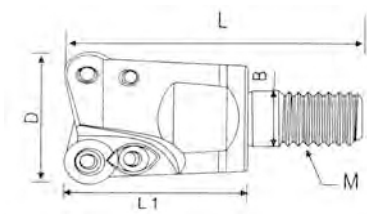

型号 Designation	尺寸Size(mm)						刀片型号 Inserts	刀片螺丝 Inserts Screw	扳手 Wrench	压板 Clamp	压板螺丝 Clamp Screw
	D	L1	L	B	M	刃数 Teeth					
<b>ERP4R</b> 16-M8-2T	16	28	46	8.5	8	2	RPMT08T2MOE	M3.0X6	T8	Y-4R	M3X6
17-M8-2T	17	28	46	8.5	8	2					
20-M10-2T	20	30	49	10.5	10	2					
21-M10-2T	21	30	49	10.5	10	2					
25-M12-3T	25	35	57	12.5	12	3					
26-M12-3T	26	35	57	12.5	12	3					

适用刀片INSERTS:三菱 MITSUBISHI

EMR4R/ERP4R

圆弧立铣刀

MILLING TOOLS

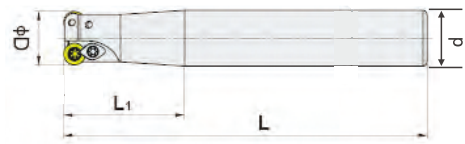

型号 Designation	尺寸Size(mm)					刀片型号 Inserts	刀片螺丝 Inserts Screw	压板 Clamp	扳手 Wrench	压板螺丝 Clamp Screw
	D	d	L1	L	刃数 Teeth					
<b>EMR4R</b> 12D12d130L1T	12	12	30	130	1	RPMW0802MOE	M3X6	Y-4R	T8	M3X6
13D12d130L1T	13	12	30	130	1					
16D16d160L2T	16	16	40	160	2					
16D16d200L2T	16	16	40	200	2					
16D15d160L2T	16	15	40	160	2					
16D15d200L2T	16	15	40	200	2					
17D16d160L2T	17	16	40	160	2					
17D16d200L2T	17	16	40	200	2					
20D19d160L2T	20	19	60	160	2					
20D19d200L2T	20	19	70	200	2					
20D20d160L2T	20	20	60	160	2					
20D20d200L2T	20	20	70	200	2					
21D20d160L2T	21	20	60	160	2					
21D20d200L2T	21	20	70	200	2					
<b>ERP4R</b> 12D12d130L1T	12	12	30	130	1	RPMW08T2MOE	M3X6	Y-4R	T8	M3X6
13D12d130L1T	13	12	30	130	1					
16D16d160L2T	16	16	40	160	2					
16D16d200L2T	16	16	40	200	2					
16D15d160L2T	16	15	40	160	2					
16D15d200L2T	16	15	40	200	2					
17D16d160L2T	17	16	40	160	2					
17D16d200L2T	17	16	40	200	2					
20D19d160L2T	20	19	60	160	2					
20D19d200L2T	20	19	70	200	2					
20D20d160L2T	20	20	60	160	2					
20D20d200L2T	20	20	70	200	2					
21D20d160L2T	21	20	60	160	2					
21D20d200L2T	21	20	70	200	2					

适用刀片INSERTS:三菱 MITSUBISHI

EMR5R/ERP6R

圆弧立铣刀

MILLING TOOLS

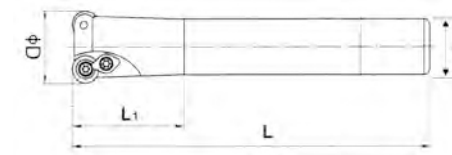

型号 Designation	尺寸Size(mm)					刀片型号 Inserts	刀片螺丝 Inserts Screw	压板 Clamp	扳手 Wrench	压板螺丝 Clamp Screw
	D	d	L1	L	刃数 Teeth					
<b>EMR5R</b> 20D20d160L2T	20	20	60	160	2	RPMW1003MOE	M4X9	Y-5R	T15	M3.5X9
20D20d200L2T	20	20	70	200	2					
21D20d160L2T	21	20	60	160	2					
21D20d200L2T	21	20	70	200	2					
25D20d150L2T	25	20	40	150	2					
25D20d200L2T	25	20	40	200	2					
25D24d160L2T	25	24	60	160	2					
25D24d200L2T	25	24	70	200	2					
25D24d250L2T	25	24	80	250	2					
25D25d160L2T	25	25	60	160	2					
25D25d200L2T	25	25	70	200	2					
25D25d250L2T	25	25	80	250	2					
26D25d160L2T	26	25	60	160	2					
26D25d200L2T	26	25	70	200	2					
26D25d250L2T	26	25	80	250	2					
30D3/4d110L2T	30	3/4	30	110	2					
30D20d110L2T	30	20	30	110	2					
30D25d160L2T	30	25	35	160	2					
30D25d200L2T	30	25	35	200	2					
30D25d250L2T	30	25	35	250	2					
35D32d160L3T	35	32	48	160	3					
35D32d200L3T	35	32	48	200	3					
35D32d250L3T	35	32	48	250	3					
35D32d300L3T	35	32	48	300	3					
<b>ERP6R</b> 30D25d160L2T	30	25	42	160	2	RPMW1204MOE	M4X9	Y-6R	T15	M3.5X9
30D25d200L2T	30	25	42	200	2					
30D25d250L2T	30	25	42	250	2					
32D25d160L2T	32	25	42	160	2					
32D25d200L2T	32	25	42	200	2					
32D25d250L2T	32	25	42	250	2					
32D32d160L2T	32	32	40	160	2					
32D32d200L2T	32	32	60	200	2					
32D32d250L2T	32	32	80	250	2					
35D32d150L3T	35	32	48	150	3					
35D32d200L3T	35	32	48	200	3					
35D32d250L3T	35	32	48	250	3					
40D32d160L3T	40	32	48	160	3					
40D32d200L3T	40	32	48	200	3					
40D32d250L3T	40	32	48	250	3					
40D32d300L3T	40	32	48	300	3					

适用刀片INSERTS:三菱 MITSUBISHI



**EMR5R** 锁牙式立铣刀头 MILLING TOOLS

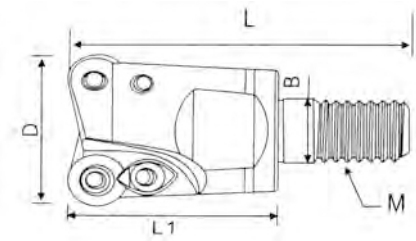

型号 Designation	尺寸Size(mm)					刀片型号 Inserts	刀片螺丝 Inserts Screw	扳手 Wrench	压板 Clamp	压板螺丝 Clamp Screw
	D	L1	L	B	M					
<b>EMR5R</b> 20-M10-2T	20	30	49	10.5	10	RPMW1003MOE	M4.0x10	T15	Y-5R	M4X10
21-M10-2T	21	30	49	10.5	10					
25-M12-2T	25	35	57	12.5	12					
26-M12-2T	26	35	57	12.5	12					
30-M12-2T	30	35	57	12.5	12					
32-M16-3T	32	35	57	12.5	16					
35-M16-3T	35	40	63	17.0	16					
40-M16-3T	40	40	63	17.0	16					

适用刀片INSERTS:三菱 MITSUBISHI

**EMR5R/ERP6R** 平底圆角面铣刀盘 MILLING TOOLS

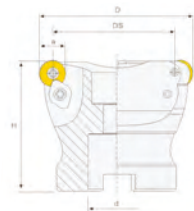

型号 Designation	尺寸Size(mm)				刀片型号 Inserts	刀片螺丝 Inserts Screw	压板 Clamp	扳手 Wrench	压板螺丝 Clamp Screw
	D	d	L	刃数 Teeth					
<b>EMR5R</b> 50D22d50L4T	50	22	50	4	RPMW1003	M4X10	Y-5R	T15	M4X10
63D22d50L4T	63	22	50	4					
80D27d50L6T	80	27	50	6					
100D32d50L6T	100	32	50	6					
125D40d63L7T	125	40	63	7					
160D40d63L8T	160	40	63	8					
<b>ERP6R</b> 50D22d50L4T	50	22	50	4	RPMT1204	M4X10	Y-6R	T15	M4X10
63D22d50L4T	63	22	50	4					
80D27d50L5T	80	27	50	5					
100D32d50L6T	100	32	50	6					
125D40d63L7T	125	40	63	7					
160D40d63L8T	160	40	63	8					

适用刀片INSERTS:三菱 MITSUBISHI

**EJX** 大进给立铣刀 MILLING TOOLS

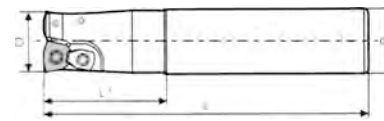

型号 Designation	尺寸Size(mm)					刀片型号 Inserts	刀片螺丝 Inserts Screw	压板 Clamp	扳手 Wrench	压板螺丝 Clamp Screw
	D	d	L1	L	刃数 Teeth					
<b>EJX06R</b> 16D16d110L2T	16	16	30	110	2	JOMC06T5215ZZSR-JIM-CC	M2.5X6	/	T8	/
16D16d150L2T	16	16	70	150	2					
16D16d200L2T	16	16	80	200	2					
17D16d120L2T	17	16	25	120	2					
17D16d150L2T	17	16	25	150	2					
17D16d200L2T	17	16	25	200	2					
<b>EJX08R</b> 20D20d130L2T	20	20	50	130	2	JOMC080320ZZSR-CC	M3X7	/	T8	/
20D20d160L2T	20	20	80	160	2					
20D20d200L2T	20	20	100	200	2					
21D20d160L2T	21	20	40	160	2					
21D20d200L2T	21	20	40	200	2					
22D20d130L2T	22	20	30	130	2					
22D20d160L2T	22	20	30	160	2					
22D20d200L2T	22	20	30	200	2					
<b>EJX09R</b> 25D25d150L2T	25	25	80	150	2	JDMC09T320ZDSR-CC	M3.5X9	EJX09	T15	M3.5X9
25D25d200L2T	25	25	120	200	2					
26D25d150L2T	26	25	40	150	2					
26D25d200L2T	26	25	40	200	2					
28D25d160L2T	28	25	40	160	2					
28D25d200L2T	28	25	40	200	2					
<b>EJX12R</b> 32D32d160L2T	32	32	70	160	2	JDMC120420ZDSR-CC	M4X10	EJX12	T15/T20	M5X11
32D32d200L2T	32	32	120	200	2					
32D32d250L2T	32	32	130	250	2					
33D32d150L2T	33	32	50	150	2					
33D32d200L2T	33	32	50	200	2					
33D32d250L2T	33	32	50	250	2					
35D32d160L2T	35	32	70	160	2					
35D32d200L2T	35	32	70	200	2					
35D32d250L2T	35	32	70	250	2					
40D32d200L3T	40	32	70	200	3					
40D32d250L3T	40	32	70	250	3					

适用刀片INSERTS:三菱 MITSUBISHI

**EJX** 大进给锁牙式立铣刀 MILLING TOOLS

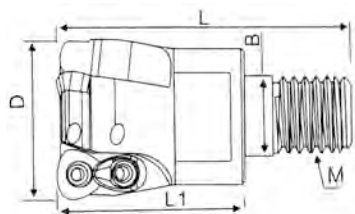

型号 Designation	尺寸Size(mm)						刀片型号 Inserts	刀片螺丝 Inserts Screw	扳手 Wrench	压板 Clamp	压板螺丝 Clamp Screw
	D	L1	L	B	M	刃数 Teeth					
<b>EJX</b> 16-M8-2T	16	28	46	8.5	8	2	JOMT06T215ZZSR-JM	M2.5x6	T8	/	/
17-M8-2T	17	28	46	8.5	8	2					
20-M10-2T	20	30	49	10.5	10	2	JOMT080320ZZSR	M3X7	T8	/	/
21-M10-2T	21	30	49	10.5	10	2					
25-M12-2T	25	35	57	12.5	12	2	JDMW09T320ZDSR	M3.5X9	T15	EJX09	M3.5X9
26-M12-2T	26	35	57	12.5	12	2					
32-M16-2T	32	40	63	17.0	16	2	JDMW120420ZDSR	M4X10	T15	EJX12	M5X11
33-M16-2T	33	40	63	17.0	16	2					
35-M16-2T	35	40	63	17.0	16	2					
40-M16-3T	40	40	63	17.0	16	3					

适用刀片INSERTS:三菱 MITSUBISHI

**EPX3000R** 高强度台阶立铣刀 MILLING TOOLS

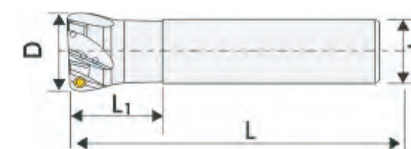

型号 Designation	尺寸Size(mm)						刀片型号 Inserts	刀片螺丝 Inserts Screw	扳手 Wrench
	D	d	L1	L	刃数 Teeth				
<b>EPX3000R</b> 12D16d85L1T	12	16	25	85	1	AOMT123608PEER-M	M2.5X6	T8	
14D16d85L1T	14	16	25	85	1				
16D16d85L2T	16	16	25	85	2				
16D16d160L2T	16	16	30	160	2				
16D16d180L2T	16	16	40	180	2				
17D16d90L2T	17	16	25	90	2				
17D16d120L2T	17	16	30	120	2				
17D16d160L2T	17	16	30	160	2				
17D16d200L2T	17	16	40	200	2				
18D16d120L2T	18	16	25	120	2				
20D20d100L3T	20	20	30	100	3				
20D20d150L2T	20	20	35	150	2				
20D20d200L2T	20	20	45	200	2				
25D25d120L3T	25	25	35	120	3				
25D25d120L4T	25	25	35	120	4				
25D25d160L3T	25	25	35	160	3				
25D25d160L4T	25	25	35	160	4				
26D25d120L3T	26	25	35	120	3				
26D25d120L4T	26	25	35	120	4				
26D25d160L3T	26	25	35	160	3				
26D25d160L4T	26	25	35	160	4				
26D25d200L3T	26	25	45	200	3				
26D25d200L4T	26	25	45	200	4				
28D25d170L3T	28	25	45	170	3				
30D25d120L4T	30	25	45	120	4				
30D32d125L4T	30	32	45	125	4				
32D32d125L3T	32	32	45	125	3				
32D32d125L4T	32	32	45	125	4				
32D32d125L5T	32	32	45	125	5				
40D32d125L3T	40	32	45	125	3				
40D32d125L4T	40	32	45	125	4				
40D32d125L5T	40	32	45	125	5				

适用刀片INSERTS:三菱 MITSUBISHI

**EJX** 大进给平面铣削刀盘 MILLING TOOLS

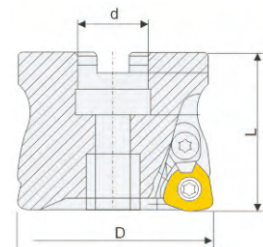

型号 Designation	尺寸Size(mm)				刀片型号 Inserts	刀片螺丝 Inserts Screw	压板 Clamp	扳手 Wrench	压板螺丝 Clamp Screw
	D	d	L	刃数 Teeth					
<b>EJX12R</b> 50D22d4T	50	22	50	4	JDMW 120420 ZDSR-FT	M4X10	EJX12	T15	M5X11
63D22d4T	63	22	50	4					
<b>EJX14R</b> 63D22d4T	63	22	50	4	JDMW 140520 ZDSR-FT	M5X11	EJX14	T20	M5X11
80D27d4T	80	27	50	4					
100D32d5T	100	32	50	5					

适用刀片INSERTS:三菱 MITSUBISHI

**R390** 直角台阶立铣刀 MILLING TOOLS

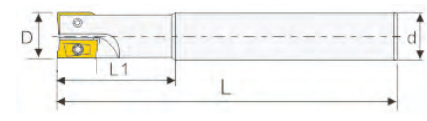

型号 Designation	尺寸Size(mm)					刀片型号 Inserts	刀片螺丝 Inserts Screw	扳手 Wrench
	D	d	L1	L	刃数 Teeth			
<b>R390</b> 16D15d160L2T	16	15	25	160	2	R390-11T308	M2.5X6	T8
16D15d200L2T	16	15	25	200	2			
16D15.6d160L2T	16	15.6	25	160	2			
16D15.6d200L2T	16	15.6	25	200	2			
16D16d160L2T	16	16	25	160	2			
16D16d200L2T	16	16	25	200	2			
20D19d160L2T	20	19	25	160	2			
20D19d200L2T	20	19	25	200	2			
20D20d160L2T	20	20	25	160	2			
20D20d200L2T	20	20	25	200	2			
25D24d160L2T	25	24	50	160	2			
25D24d200L2T	25	24	50	200	2			
25D24d250L2T	25	24	50	250	2			
25D25d160L2T	25	25	60	160	2			
25D25d200L2T	25	25	60	200	2			
25D25d250L2T	25	25	60	250	2			
26D25d160L2T	26	25	50	160	2			
26D25d200L2T	26	25	50	200	2			
26D25d250L2T	26	25	50	250	2			
32D32d160L3T	32	32	48	160	2			
32D32d200L3T	32	32	48	200	2			
32D32d250L3T	32	32	48	250	2			
33D32d160L2T	33	32	50	160	2			
33D32d200L2T	33	32	50	200	2			
33D32d250L2T	33	32	50	250	2			
35D32d160L3T	35	32	60	160	2			
35D32d200L3T	35	32	60	200	2			
35D32d250L3T	35	32	60	250	2			
35D32d300L3T	35	32	60	300	2			

适用刀片INSERTS:山特维克 SANDVIK

**R390** 锁牙式立铣刀头 MILLING TOOLS

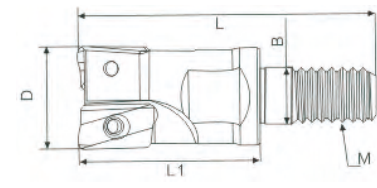

型号 Designation	尺寸Size(mm)						刀片型号 Inserts	刀片螺丝 Inserts Screw	扳手 Wrench
	D	L1	L	B	M	刃数 Teeth			
<b>R390</b> 16 - M 8 - 2 T	16	28	46	8.5	8	2	R390-11T308	M2.5X6	T8
17 - M 8 - 2 T	17	28	46	8.5	8	2			
20 - M 10 - 2 T	20	30	49	10.5	10	2			
21 - M 10 - 2 T	21	30	49	10.5	10	2			
25 - M 12 - 3 T	25	35	57	12.5	12	3			
26 - M 12 - 3 T	26	35	57	12.5	12	3			
25 - M 12 - 2 T	25	35	57	12.5	12	2	R390-170408	M3.5X8	T15
26 - M 12 - 2 T	26	35	57	12.5	12	2			
32 - M 16 - 2 T	32	40	63	17.0	16	3			
35 - M 16 - 2 T	35	40	63	17.0	16	3			

适用刀片INSERTS:山特维克 SANDVIK

**AHU** 锁牙式立铣刀头 MILLING TOOLS

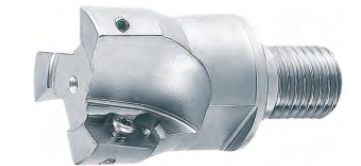
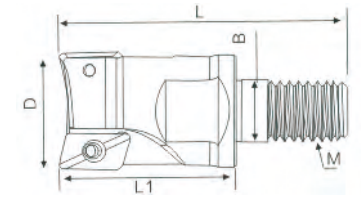

型号 Designation	尺寸Size(mm)						刀片型号 Inserts	刀片螺丝 Inserts Screw	扳手 Wrench
	D	L1	L	B	M	刃数 Teeth			
<b>AHU</b> 16-M8-2T	16	28	46	8.5	8	2	JDMT1003□□R	M2.5X6	T8
17-M8-2T	17	28	46	8.5	8	2			
20-M10-2T	20	30	49	10.5	10	2			
21-M10-2T	21	30	49	10.5	10	2			
25-M12-3T	25	35	57	12.5	12	3			
26-M12-3T	26	35	57	12.5	12	3			
32-M16-3T	32	40	63	17	16	3	JDMT1505□□R	M4X9	T15
35-M16-3T	35	40	63	17	16	3			
40-M16-3T	40	40	63	17	16	3			

适用刀片INSERTS:日立 HITACHI

AHU

超快削立铣刀

MILLING TOOLS

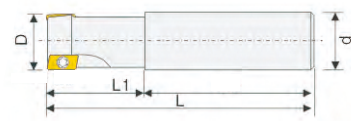

型号 Designation	尺寸Size(mm)					刀片型号 Inserts	刀片螺丝 Inserts Screw	扳手 Wrench
	D	d	L1	L	刃数 Teeth			
<b>AHU10R</b> 10D10d100L1T	10	10	25	100	1	JDMT1003008	M2.5X6	T8
12D12d130L1T	12	12	25	130	1			
13D12d130L1T	13	12	25	130	1			
16D16d120L2T	16	16	40	120	2			
16D16d160L2T	16	16	50	160	2			
16D16d200L2T	16	16	60	200	2			
16D15d120L2T	16	15	40	120	2			
16D15d160L2T	16	15	40	160	2			
16D15d200L2T	16	15	40	200	2			
17D16d120L2T	17	16	50	120	2			
17D16d160L2T	17	16	50	160	2			
17D16d200L2T	17	16	50	200	2			
20D19d160L2T	20	19	50	160	2			
20D19d200L2T	20	19	50	200	2			
20D20d120L2T	20	20	50	120	2			
20D20d160L2T	20	20	60	160	2			
20D20d200L2T	20	20	70	200	2			
21D20d160L2T	21	20	50	160	2			
21D20d200L2T	21	20	50	200	2			
<b>AHU15R</b> 25D25d160L2T	25	25	70	160	2	JDMT150508	M4X9	T15
25D25d200L2T	25	25	70	200	2			
25D25d250L2T	25	25	80	250	2			
25D24d160L2T	25	24	50	160	2			
25D24d200L2T	25	24	50	200	2			
25D24d250L2T	25	24	50	250	2			
26D25d160L2T	26	25	50	160	2			
26D25d200L2T	26	25	50	200	2			
26D25d250L2T	26	25	50	250	2			
32D32d160L3T	32	32	48	160	3			
32D32d200L3T	32	32	48	200	3			
32D32d250L3T	32	32	48	250	3			
35D32d160L3T	35	32	60	160	3			
35D32d200L3T	35	32	60	200	3			
35D32d250L3T	35	32	60	250	3			
35D32d300L3T	35	32	60	300	3			

适用刀片INSERTS:日立 HITACHI

TRS

快削型圆弧铣刀

MILLING TOOLS

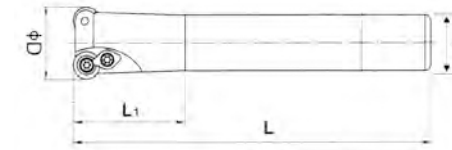

型号 Designation	尺寸Size(mm)					刀片型号 Inserts	刀片螺丝 Inserts Screw	压板 Clamp	扳手 Wrench	压板螺丝 Clamp Screw
	D	d	L1	L	刃数 Teeth					
<b>TRS4R</b> 12D12d130L1T	12	12	35	130	1	RDMT0802MO	M3X6	Y-4R	T8	M3X7
13D12d130L1T	13	12	35	130	1					
16D16d160L2T	16	16	50	160	2					
16D16d200L2T	16	16	50	200	2					
16D15d160L2T	16	15	50	160	2					
16D15d200L2T	16	15	50	200	2					
17D16d160L2T	17	16	50	160	2					
17D16d200L2T	17	16	50	200	2					
20D20d160L2T	20	20	60	160	2					
20D20d200L2T	20	20	70	200	2					
20D19d160L2T	20	19	60	160	2					
20D19d200L2T	20	19	70	200	2					
21D20d160L2T	21	20	60	160	2					
21D20d200L2T	21	20	70	200	2					
<b>TRS5R</b> 21D20d160L2T	21	20	60	160	2	RDMT10T3MOTN	M4X9	Y-5R	T15	M3.5X9
21D20d200L2T	21	20	70	200	2					
20D20d160L2T	20	20	60	160	2					
20D20d200L2T	20	20	70	200	2					
25D20d150L2T	25	20	40	150	2					
25D20d200L2T	25	20	40	200	2					
25D25d150L2T	25	25	60	150	2					
25D25d200L2T	25	25	70	200	2					
25D25d250L2T	25	25	80	250	2					
25D24d150L2T	25	24	60	150	2					
25D24d200L2T	25	24	70	200	2					
25D24d250L2T	25	24	80	250	2					
26D25d150L2T	26	25	60	150	2					
26D25d200L2T	26	25	70	200	2					
30D25d150L2T	30	25	40	150	2					
30D25d200L2T	30	25	40	200	2					
30D25d250L2T	30	25	40	250	2					
35D32d150L3T	35	32	48	150	3					
35D32d200L3T	35	32	48	200	3					
35D32d250L3T	35	32	48	250	3					
35D32d300L3T	35	32	48	300	3					

适用刀片INSERTS:日立 HITACHI



TRS4R

锁牙式立铣刀头

MILLING TOOLS

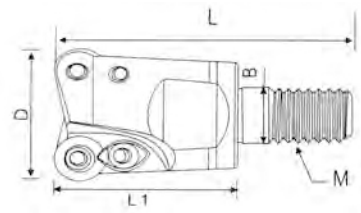

型号 Designation	尺寸Size(mm)						刀片型号 Inserts	刀片螺丝 Inserts Screw	扳手 Wrench	压板 Clamp	压板螺丝 Clamp Screw
	D	L1	L	B	M	刃数 Teeth					
TRS4R 16-M8-2T	16	28	46	8.5	8	2	RDMT0802T2MOE	M3.0X6	T8	Y-4R	M3X6
17-M8-2T	17	28	46	8.5	8	2					
20-M10-2T	20	30	49	10.5	10	2					
21-M10-2T	21	30	49	10.5	10	2					
25-M12-3T	25	35	57	12.5	12	3					
26-M12-3T	26	35	57	12.5	12	3					

适用刀片INSERTS:日立 HITACHI

TRS5R

锁牙式立铣刀头

MILLING TOOLS

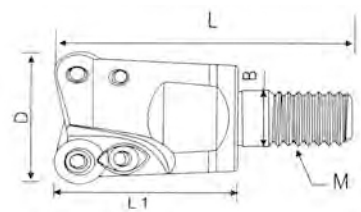

型号 Designation	尺寸Size(mm)						刀片型号 Inserts	刀片螺丝 Inserts Screw	扳手 Wrench	压板 Clamp	压板螺丝 Clamp Screw
	D	L1	L	B	M	刃数 Teeth					
TRS5R 20-M10-2T	20	30	49	10.5	10	2	RDMT10T3MOE	M4.0x10	T15	Y-5R	M4X10
21-M10-2T	21	30	49	10.5	10	2					
25-M12-2T	25	35	57	12.5	12	2					
26-M12-2T	26	35	57	12.5	12	2					
30-M12-2T	30	35	57	12.5	12	3					
32-M16-3T	32	35	57	12.5	16	3					
35-M16-3T	35	40	63	17.0	16	3					
40-M16-3T	40	40	63	17.0	16	3					

适用刀片INSERTS:日立 HITACHI

TRS

圆刀刀平面铣刀盘

MILLING TOOLS

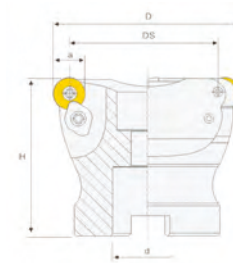

型号 Designation	尺寸Size(mm)				刀片型号 Inserts	刀片螺丝 Inserts Screw	压板 Clamp	扳手 Wrench	压板螺丝 Clamp Screw
	D	d	L	刃数 Teeth					
TRS5R 50D22d50L4T	50	22	50	4	RDMT10T3	M4X10	Y-5R	T15	M4X10
63D22d50L4T	63	22	50	4					
80D27d50L6T	80	27	50	6					
100D32d50L6T	100	32	50	6					
125D40d63L7T	125	40	63	7					
160D40d63L8T	160	40	63	8					
TRS6R 50D22d50L4T	50	22	50	4	RDMT1204	M4X10	Y-6R	T15	M4X10
63D22d50L4T	63	22	50	4					
80D27d50L5T	80	27	50	5					
100D32d50L6T	100	32	50	6					
125D40d63L7T	125	40	63	7					
160D40d63L8T	160	40	63	8					

适用刀片INSERTS:日立 HITACHI

ASR

锁牙式立铣刀

MILLING TOOLS

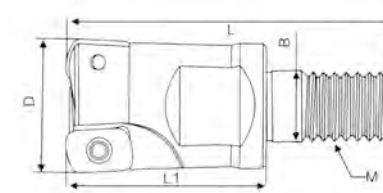

型号 Designation	尺寸Size(mm)						刀片型号 Inserts	刀片螺丝 Inserts Screw	扳手 Wrench
	D	L1	L	B	M	刃数 Teeth			
ASR 16-M8-2T	16	28	46	8.5	8	2	EPNW0603TN-8 EPNW0603TN-8 EPNW0603TN-8LF	M2.5X6	T8
17-M8-2T	17	28	46	8.5	8	2			
20-M10-2T	20	30	49	10.5	10	2			
21-M10-2T	21	30	49	10.5	10	2			
25-M12-3T	25	35	57	12.5	12	3			
26-M12-3T	26	35	57	12.5	12	3			
32-M16-3T	32	40	63	17.0	16	3			
35-M16-4T	35	40	63	17.0	16	4			
40-M16-4T	40	40	63	17.0	16	4			

适用刀片INSERTS:日立 HITACHI

**ASR** 大进给立铣刀 MILLING TOOLS

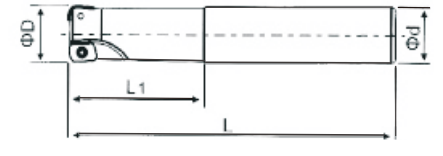
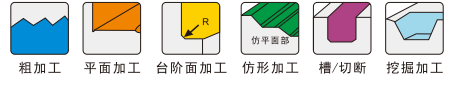

型号 Designation	尺寸Size(mm)					刀片型号 Inserts	刀片螺丝 Inserts Screw	扳手 Wrench
	D	d	L1	L	刃数 Teeth			
<b>ASR06R</b> 16D16d120L2T	16	16	40	120	2	EPNW0603TN-8 EPMT0603TN-8 EPMT0603EN-8LF	M2.5X6	T8
16D16d160L2T	16	16	50	160	2			
17D16d120L2T	17	16	27	120	2			
17D16d160L2T	17	16	27	160	2			
20D20d160L2T	20	20	50	160	2/3			
20D20d200L2T	20	20	50	200	2/3			
21D20d160L2T	21	20	27	160	2/3			
21D20d200L2T	21	20	27	200	2/3			
25D25d160L3T	25	25	60	160	3/4			
25D25d200L3T	25	25	70	200	3/4			
26D25d150L3T	26	25	40	150	3/4			
26D25d200L3T	26	25	50	200	3/4			
32D32d160L4T	32	32	70	160	4			
32D32d200L4T	32	32	70	200	4			
33D32d160L4T	33	32	60	160	4			
33D32d200L4T	33	32	70	200	4			
35D32d160L4T	35	32	50	160	4			
35D32d200L4T	35	32	50	200	4			
40D32d160L4T	40	32	50	160	4			
40D32d200L4T	40	32	50	200	4			

适用刀片INSERTS:日立 HITACHI

**ASR06R** 日立快进给平面铣刀盘 MILLING TOOLS

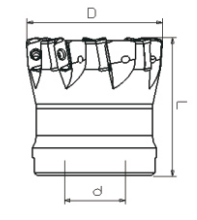

型号 Designation	尺寸Size(mm)				刀片型号 Inserts	刀片螺丝 Inserts Screw	压板 Clamp	扳手 Wrench	压板螺丝 Clamp Screw
	D	d	L	刃数 Teeth					
<b>ASR06R</b> 50D22d50L6T	50	22	50	6	EPNW0603	M2.5X6	-	T8	-
63D22d50L6T	63	22	50	6					

适用刀片INSERTS:日立 HITACHI

**ASRF12/15** 日立快进给平面铣刀盘 MILLING TOOLS

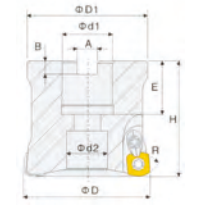

型号 Designation	尺寸Size(mm)				刀片型号 Inserts	刀片螺丝 Inserts Screw	压板 Clamp	扳手 Wrench	压板螺丝 Clamp Screw
	D	d	L	刃数 Teeth					
<b>ASRF12R</b> 50D22d50L4T	50	22	50	4	SDNW1205	M4X10	Y-5R	T15	M4X10
63D22d50L4T	63	22	50	4					
80D27d50L5T	80	27	50	5					
<b>ASRF15R</b> 63D22d50L4T	63	22	50	4	SDNW1505	M5X11	Y-6R	T20	M5X11
80D27d50L5T	80	27	50	5					
100D32d50L6T	100	32	50	6					
125D40d63L6T	125	40	63	6					
160D40d63L8T	160	40	63	8					

适用刀片INSERTS:日立 HITACHI

**TJU**

平底直角钻铣刀(过中心)

MILLING TOOLS

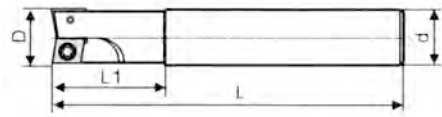

型号 Designation	尺寸Size(mm)					刀片型号 Inserts	刀片螺丝 Inserts Screw	扳手 Wrench
	D	d	L1	L	刃数 Teeth			
<b>TJU</b> 8D8d100L1T	8	8	30	100	1	CCMT060204	M2.5	T8
10D10d100L1T	10	10	30	100	1			
10D10d130L1T	10	10	30	130	1			
12D12d130L1T	12	12	30	130	1	CCMT080204Z	M2.5	T8
16D16d120L2T	16	16	35	120	2	CCMT060204 CCMT080204Z	M2.5	T8
16D16d160L2T	16	16	35	160	2			
16D16d200L2T	16	16	40	200	2			
17D16d120L2T	17	16	40	120	2			
17D16d160L2T	17	16	50	160	2			
17D16d200L2T	17	16	60	200	2			
20D20d160L2T	20	20	50	160	2	CCMT060204 CCMT090204Z	M2.5	T8
20D20d200L2T	20	20	60	200	2			
21D20d150L2T	21	20	40	150	2			
21D20d200L2T	21	20	50	200	2	CCMT090308 CCMT120308Z	M3.5	T15
25D25d160L2T	25	25	60	160	2			
25D25d200L2T	25	25	70	200	2			
25D25d250L2T	25	25	80	250	2			
26D25d150L2T	26	25	40	150	2			
26D25d200L2T	26	25	50	200	2			
26D25d250L2T	26	25	60	250	2	CCMT120408 CCMT160408Z	M4	T15
32D32d160L2T	32	32	60	160	2			
32D32d200L2T	32	32	60	200	2			
32D32d250L2T	32	32	70	250	2			
32D32d300L2T	32	32	80	300	2	CCMT160408Z CCMT190408Z	M5	T20
40D32d200L2T	40	32	50	200	2			
40D32d250L2T	40	32	50	250	2			
40D32d300L2T	40	32	50	300	2			

适用刀片INSERTS:日立 HITACHI

**ASJ**

钻铣共用型铣刀(长刃型)

MILLING TOOLS



型号 Designation	横刃 Cross teeth	竖刃 Vertical teeth	尺寸Size(mm)				刀片螺丝 Inserts Screw	扳手 Wrench	横刀片 Cross insert	竖刀片 Vertical insert
			D	d	L1	L				
<b>ASJ</b> 17D16d160L	1	3	17	16	35	160	M2.5	T8	ADMT 100308L	ACMT 100308R
20D20d160L	1	3	20	20	35	160				
20D20d200L	1	3	20	20	35	200				
20D20d250L	1	3	20	20	35	250				
21D20d160L	1	3	21	20	35	160				
21D20d200L	1	3	21	20	35	200				
25D25d160L	1	3	25	25	40	160	M3	T8	ADMT 12T308L	APMT 12T308R
25D25d200L	1	3	25	25	40	200				
25D25d250L	1	3	25	25	40	250				
26D25d160L	1	3	26	25	40	160				
26D25d200L	1	3	26	25	40	200				
26D25d250L	1	3	26	25	40	250				
32D32d160L	1	3	32	32	50	160	M4	T15	APMT 160408L	APTM 150408R
32D32d200L	1	3	32	32	50	200				
32D32d250L	1	3	32	32	50	250				
32D32d300L	1	3	32	32	50	300				
35D32d160L	1	3	35	32	50	160	M4	T15	APMT 170408L	APMT 105408R
35D32d200L	1	3	35	32	50	200				
35D32d250L	1	3	35	32	50	250				
35D32d300L	1	3	35	32	50	300				
40D40d160L	1	4	40	40	55	160	M4	T15	APMT 190508L	APMT 105408R
40D40d200L	1	4	40	40	55	200				
40D40d300L	1	4	40	40	55	300				

适用刀片INSERTS:日立 HITACHI

**KM** 高速平面铣刀盘 MILLING TOOLS

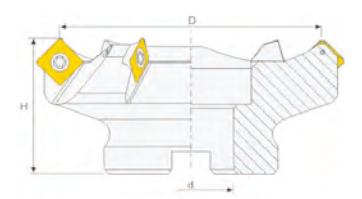

型号 Designation	尺寸Size(mm)				刀片型号 Inserts	刀片螺丝 Inserts Screw	扳手 Wrench
	D	d	L	刃数 Teeth			
<b>KM</b> 50D22d50L4T	50	22	50	4	SEKT1204	M5X11	T20
63D22d50L5T	63	22	50	5			
80D27d50L5T	80	27	50	5			
100D32d50L6T	100	32	50	6			
125D40d63L6T	125	40	63	6			
160D40d63L8T	160	40	63	8			

适用刀片INSERTS: 克洛伊 KORLOY

**SKS** 大进给平面铣削刀盘 MILLING TOOLS

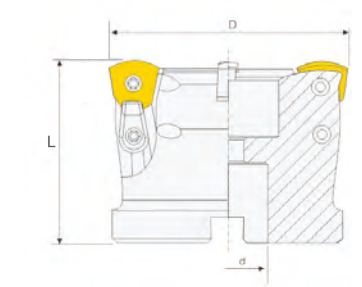

型号 Designation	尺寸Size(mm)				刀片型号 Inserts	刀片螺丝 Inserts Screw	压板 Clamp	扳手 Wrench	压板螺丝 Clamp Screw
	D	d	L	刃数 Teeth					
<b>SKS08R</b> 50D22d50L4T	50	22	50	4	WDMW080520ZTR	M4.5X10	SKS08	T20	M5X11
63D22d50L4T	63	22	50	4					
80D27d50L5T	80	27	50	5					
100D32d50L6T	100	32	50	6					
<b>SKS10R</b> 63D22d50L4T	63	22	50	4	WDMW10X620ZTR	M4.5X10	SKS10	T20	M5X11
80D27d50L5T	80	27	50	5					
100D32d50L6T	100	32	50	6					

适用刀片INSERTS: 黛杰 DIJET

**SSP45°** 定位倒角刀 MILLING TOOLS

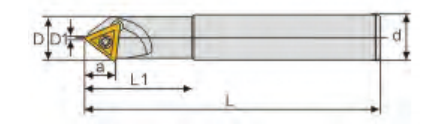

型号 Designation	尺寸Size(mm)					刀片型号 Inserts	刀片螺丝 Inserts Screw	扳手 Wrench	压板螺丝 Clamp Screw
	D	d	L	刃数 Teeth	倒角范围 CFR				
<b>SSP45°</b> 20-C20-130	20	20	130	1	0-20	TCMX16T308EZR	M4	T15	-

适用刀片INSERTS: 斯特拉姆, RAMBO, STEELRAM

**SSK45°** 舍弃式倒角刀 MILLING TOOLS

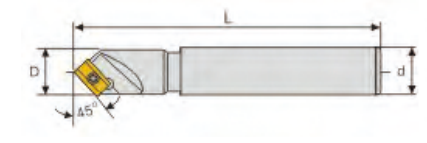

型号 Designation	尺寸Size(mm)					刀片型号 Inserts	刀片螺丝 Inserts Screw	扳手 Wrench	压板螺丝 Clamp Screw
	D	d	L	刃数 Teeth	倒角范围 CFR				
<b>SSK45°</b> 20-C20-130	20	20	130	1	0-20	ADNT160308	M4	T15	-

适用刀片INSERTS: 日立, RAMBO, HITACHI

**TCM45°** 倒角刀 MILLING TOOLS

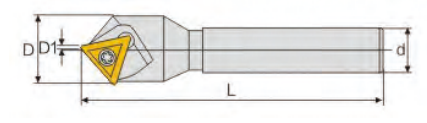

型号 Designation	尺寸Size(mm)					刀片型号 Inserts	刀片螺丝 Inserts Screw	扳手 Wrench	压板螺丝 Clamp Screw
	D	d	L	刃数 Teeth	倒角范围 CFR				
<b>TCM45°</b> 20-C16-110	20	16	110	1	-	TCMT16T304	M4	T15	-
25-C20-110	25	20	110	1	-	TCMT16T304	M4	T15	-

适用刀片INSERTS: 三菱, RAMBO, MITSUBISHI



TP

舍弃式直角铣刀

MILLING TOOLS

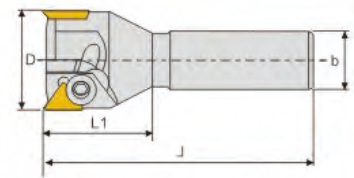

型号 Designation	尺寸Size(mm)					刀片型号 Inserts	刀片螺丝 Inserts Screw	扳手 Wrench	压板螺丝 Clamp Screw
	D	d	L	刃数 Teeth	倒角范围 CFR				
TP 20-C20-90	20	20	90	2	/	TPMN110204	M5	L3	/
25-C20-100	25	20	100	2	/	TPMN110304	M6	L3	/
32-C20-130	32	20	130	2	/	TPMN110308	M6	L4	/
35-C20-130	35	20	130	2	/	TPMN160308	M6	L4	/
35-C20-160	35	25	160	2	/				/
35-C20-200	35	25	200	2	/				/
35-C25-160	35	25	160	2	/				/
35-C25-200	35	25	200	2	/				/
35-C32-160	35	32	160	2	/				/
35-C32-200	35	32	200	2	/				/
40-C20-160	40	20	160	2	/				TPMN160308
40-C25-130	40	25	130	2	/	/			
40-C25-160	40	25	160	2	/	/			
40-C25-200	40	25	200	2	/	/			
40-C32-160	40	32	160	2	/	/			
40-C32-200	40	32	200	2	/	/			
50-C20-160	50	20	160	2	/	TPMN160308	M6	L4	/
50-C25-160	50	25	160	2	/				/
50-C25-200	50	25	200	2	/				/
50-C32-160	50	32	160	2	/				/
50-C32-200	50	32	200	2	/				/
63-C20-160	63	20	160	2	/	TPMN220412	M8	L5	/
63-C25-160	63	25	160	2	/				/
63-C32-160	63	32	160	2	/				/
63-C20-200	63	32	200	2	/				/

适用刀片INSERTS: 三菱, RAMBO, MITSUBISHI

直杆

锁牙式抗震钨钢刀杆

MILLING TOOLS

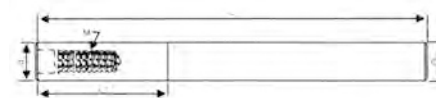

型号 Designation	M	D	d	L
8-M4-100	4	8	8	100
10-M5-100	5	10	10	100
10-M5-150	5	10	10	150
12-M6-100	6	12	12	100
12-M6-150	6	12	12	150
12-M6-200	6	12	12	200
15-M8-100	8	15	15	100
15-M8-150	8	15	15	150
15-M8-200	8	15	15	200
15.6-M8-100	8	15.6	15.6	100
15.6-M8-150	8	15.6	15.6	150
15.6-M8-200	8	15.6	15.6	200
15.6-M8-250	8	15.6	15.6	250
16-M8-100	8	16	16	100
16-M8-150	8	16	16	150
16-M8-200	8	16	16	200
16-M8-250	8	16	16	250
16-M8-300	8	16	16	300
19-M10-150	10	19	19	150
19-M10-200	10	19	19	200

型号 Designation	M	D	d	L
19-M10-250	10	19	19	250
20-M10-100	10	20	20	100
20-M10-150	10	20	20	150
20-M10-200	10	20	20	200
20-M10-250	10	20	20	250
20-M10-300	10	20	20	300
24-M12-150	12	24	24	150
24-M12-200	12	24	24	200
24-M12-250	12	24	24	250
24-M12-300	12	24	24	300
25-M12-150	12	25	25	150
25-M12-200	12	25	25	200
25-M12-250	12	25	25	250
25-M12-300	12	25	25	300
32-M16-150	16	32	32	150
32-M16-200	16	32	32	200
32-M16-250	16	32	32	250
32-M16-300	16	32	32	300
32-M16-350	16	32	32	350
32-M16-400	16	32	32	400

特殊尺寸可定制

SB

新型倒角刀

MILLING TOOLS

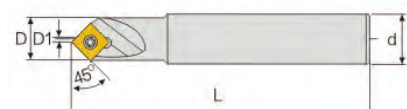

型号 Designation	尺寸Size(mm)					刀片型号 Inserts	刀片螺丝 Inserts Screw	扳手 Wrench	压板螺丝 Clamp Screw
	D	d	L	刃数 Teeth	倒角范围 CFR				
SB 16-C16-120	16	16	120	1	1.5-16	SPMW090304	M4	T15	-

适用刀片INSERTS: 三菱, RAMBO, MITSUBISHI

**BT** 可转位锁牙立铣刀柄 MILLING TOOLS

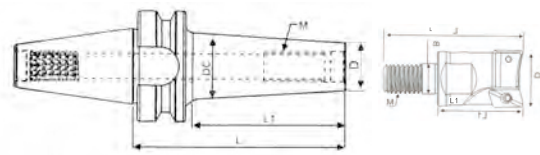

型号 Designation	M	D	DC	L	L2	L1
BT30-M6-50L	6	12	17	50	/	30
BT30-M6-100L	6	12	17	100	/	80
BT30-M8-45L	8	15	17	45	/	25
BT30-M8-50L	8	15	17	50	/	30
BT30-M8-100L	8	15	17	100	/	80
BT30-M10-45L	10	19	21	45	/	25
BT30-M10-50L	10	19	21	50	/	30
BT30-M10-100L	10	19	21	100	/	80
BT30-M12-60L	12	24	25	60	/	40
BT30-M12-100L	12	24	26	100	/	80
BT30-M16-45L	16	30	33	45	/	30
BT30-M16-60L	16	30	33	60	/	40
BT30-M16-100L	16	30	32	100	/	80
BT40-M8-70L	8	15	17	70	/	45
BT40-M8-100L	8	15	17	100	/	75
BT40-M8-150L	8	15	22	150	50	125
BT40-M8-200L	8	15	22	200	70	175
BT40-M10-70L	10	19	20	70	/	45
BT40-M10-100L	10	19	25	100	/	75
BT40-M10-150L	10	19	25	150	/	125
BT40-M10-200L	10	19	31	200	70	175
BT40-M12-70L	12	24	26	70	/	45
BT40-M12-100L	12	24	32	100	/	75
BT40-M12-150L	12	24	37	150	50	125
BT40-M12-200L	12	24	68	200	/	175
BT40-M16-70L	16	30	32	70	/	45
BT40-M16-100L	16	30	36	100	30	75
BT40-M16-150L	16	30	41	150	/	125
BT40-M16-200L	16	30	46	200	70	175

**EAF/EBF** 快速可转位钻头(带水孔) MILLING TOOLS

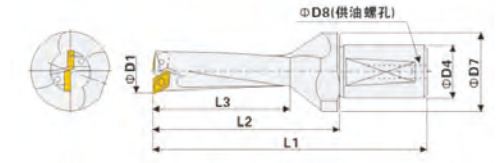
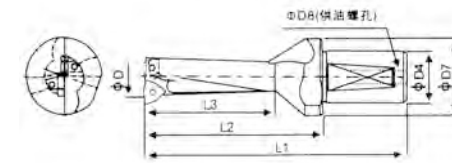

型号	直径 ( $\varnothing D$ )	钻削 深度	刃数	有效 槽长 L3	颈长 L2	全长 L1	柄径 D4	刀头凸 盘直径 D7	冷却孔 D8	刀片型号	刀片螺丝	扳手
EAF/EBFS1700F25	17	2D	2	41	59	109	25	34	PT1/8	WCMT030208-M01 GPMT070204-u $\odot$	M2.5X3.5X6	T8
EAF/EBFM1700F25	17	3D	2	58	76	126	25	34	PT1/8			
EAF/EBFL1700F25	17	4D	2	75	93	143	25	34	PT1/8			
EAF/EBFS1800F25	18	2D	2	43	61	111	25	34	PT1/8			
EAF/EBFM1800F25	18	3D	2	61	79	129	25	34	PT1/8			
EAF/EBFL1800F25	18	4D	2	79	97	147	25	34	PT1/8			
EAF/EBFS1900F25	19	2D	2	46	63	113	25	34	PT1/8			
EAF/EBFM1900F25	19	3D	2	65	82	132	25	34	PT1/8			
EAF/EBFL1900F25	19	4D	2	84	101	151	25	34	PT1/8			
EAF/EBFS2000F25	20	2D	2	48	65	115	25	34	PT1/8			
EAF/EBFM2000F25	20	3D	2	68	85	135	25	34	PT1/8			
EAF/EBFL2000F25	20	4D	2	88	105	155	25	34	PT1/8			
EAF/EBFS2100F25	21	2D	2	50	67	117	25	34	PT1/8	WCMT040208-M01 GPMT090304-u $\odot$	M2.5X3.5X6	T8
EAF/EBFM2100F25	21	3D	2	71	88	138	25	34	PT1/8			
EAF/EBFL2100F25	21	4D	2	92	109	159	25	34	PT1/8			
EAF/EBFS2200F25	22	2D	2	53	69	119	25	34	PT1/8			
EAF/EBFM2200F25	22	3D	2	75	91	141	25	34	PT1/8			
EAF/EBFL2200F25	22	4D	2	97	113	163	25	34	PT1/8			
EAF/EBFS2300F25	23	2D	2	55	71	121	25	34	PT1/8			
EAF/EBFM2300F25	23	3D	2	78	94	144	25	34	PT1/8			
EAF/EBFL2300F25	23	4D	2	101	117	167	25	34	PT1/8			
EAF/EBFS2400F25	24	2D	2	58	73	123	25	34	PT1/8			
EAF/EBFM2400F25	24	3D	2	82	97	147	25	34	PT1/8			
EAF/EBFL2400F25	24	4D	2	106	121	171	25	34	PT1/8			
EAF/EBFS2500F25	25	2D	2	60	75	130	32	41	PT1/8	WCMT050308-M01 GPMT11T308-u $\odot$	M3X4X6	T15
EAF/EBFM2500F25	25	3D	2	85	100	155	32	41	PT1/8			
EAF/EBFL2500F25	25	4D	2	110	125	180	32	41	PT1/8			
EAF/EBFS2600F25	26	2D	2	62	77	132	32	41	PT1/8			
EAF/EBFM2600F25	26	3D	2	88	103	158	32	41	PT1/8			
EAF/EBFL2600F25	26	4D	2	114	129	184	32	41	PT1/8			
EAF/EBFS2700F25	27	2D	2	65	79	134	32	41	PT1/8			
EAF/EBFM2700F25	27	3D	2	91	106	161	32	41	PT1/8			
EAF/EBFL2700F25	27	4D	2	119	133	188	32	41	PT1/8			
EAF/EBFS2800F25	28	2D	2	67	81	136	32	41	PT1/8			
EAF/EBFM2800F25	28	3D	2	95	109	164	32	41	PT1/8			
EAF/EBFL2800F25	28	4D	2	123	137	192	32	41	PT1/8			
EAF/EBFS2900F25	29	2D	2	70	83	138	32	44	PT1/8			
EAF/EBFM2900F25	29	3D	2	99	112	167	32	44	PT1/8			
EAF/EBFL2900F25	29	4D	2	128	141	196	32	44	PT1/8			
EAF/EBFS3000F25	30	2D	2	72	90	155	32	44	PT1/8			
EAF/EBFM3000F25	30	3D	2	102	120	185	32	44	PT1/8			
EAF/EBFL3000F25	30	4D	2	132	150	215	32	44	PT1/8			



型号	直径 ( $\varnothing$ D)	钻削 深度	刃 数	有效 槽长 L3	颈长 L2	全长 L1	柄径 D4	刀头凸 盘直径 D7	冷却孔 D8	刀片型号	刀片螺丝	扳手
EAF/EBFS3100F32	31	2D	2	74	92	157	32	44	PT1/8	WCMT06T308-M01 GPMT140408	M3.5X5.5X8	T15
EAF/EBFM3100F32	31	3D	2	105	123	188	32	44	PT1/8			
EAF/EBFL3100F32	31	4D	2	136	154	219	32	44	PT1/8			
EAF/EBFS3200F32	32	2D	2	77	94	159	32	44	PT1/8			
EAF/EBFM3200F32	32	3D	2	109	126	191	32	44	PT1/8			
EAF/EBFL3200F32	32	4D	2	141	158	223	32	44	PT1/8			
EAF/EBFS3300F32	33	2D	2	79	96	161	32	44	PT1/8			
EAF/EBFM3300F32	33	3D	2	112	129	194	32	44	PT1/8			
EAF/EBFL3300F32	33	4D	2	145	162	227	32	44	PT1/8			
EAF/EBFS3400F32	34	2D	2	82	98	163	32	44	PT1/8			
EAF/EBFM3400F32	34	3D	2	116	132	197	32	44	PT1/8			
EAF/EBFL3400F32	34	4D	2	150	166	231	32	44	PT1/8			
EAF/EBFS3500F32	35	2D	2	84	100	165	32	44	PT1/8			
EAF/EBFM3500F32	35	3D	2	119	135	200	32	44	PT1/8			
EAF/EBFL3500F32	35	4D	2	154	170	235	32	44	PT1/8			
EAF/EBFS3600F32	36	2D	2	86	102	167	32	44	PT1/8			
EAF/EBFM3600F32	36	3D	2	122	138	203	32	44	PT1/8			
EAF/EBFL3600F32	36	4D	2	158	174	239	32	44	PT1/8			
EAF/EBFS3700F32	37	2D	2	89	104	169	32	44	PT1/8			
EAF/EBFM3700F32	37	3D	2	126	141	206	32	44	PT1/8			
EAF/EBFL3700F32	37	4D	2	162	178	243	32	44	PT1/8			
EAF/EBFS3800F32	38	2D	2	91	106	171	32	44	PT1/8			
EAF/EBFM3800F32	38	3D	2	129	144	209	32	44	PT1/8			
EAF/EBFL3800F32	38	4D	2	166	182	247	32	44	PT1/8			
EAF/EBFS3900F32	39	2D	2	94	108	173	32	50	PT1/8			
EAF/EBFM3900F32	39	3D	2	133	147	212	32	50	PT1/8			
EAF/EBFL3900F32	39	4D	2	171	186	251	32	50	PT1/8			
EAF/EBFS4000F40	40	2D	2	96	110	175	40	50	PT1/4			
EAF/EBFM4000F40	40	3D	2	136	150	215	40	50	PT1/4			
EAF/EBFL4000F40	40	4D	2	176	190	255	40	50	PT1/4			
EAF/EBFS4100F40	41	2D	2	98	112	177	40	50	PT1/4			
EAF/EBFM4100F40	41	3D	2	139	153	218	40	50	PT1/4			
EAF/EBFL4100F40	41	4D	2	180	194	259	40	50	PT1/4			
EAF/EBFS4200F40	42	2D	2	101	114	179	40	50	PT1/4			
EAF/EBFM4200F40	42	3D	2	143	156	221	40	50	PT1/4			
EAF/EBFL4200F40	42	4D	2	185	198	263	40	50	PT1/4			
EAF/EBFS4300F40	43	2D	2	103	116	181	40	50	PT1/4			
EAF/EBFM4300F40	43	3D	2	146	159	224	40	50	PT1/4			
EAF/EBFL4300F40	43	4D	2	189	202	267	40	50	PT1/4			
EAF/EBFS4400F40	44	2D	2	106	118	183	40	50	PT1/4			
EAF/EBFM4400F40	44	3D	2	150	162	227	40	50	PT1/4			
EAF/EBFL4400F40	44	4D	2	194	206	271	40	50	PT1/4			
EAF/EBFS4500F40	45	2D	2	108	120	185	40	54	PT1/4			
EAF/EBFM4500F40	45	3D	2	153	165	230	40	54	PT1/4			
EAF/EBFL4500F40	45	4D	2	198	210	275	40	54	PT1/4			
EAF/EBFS4600F40	46	2D	2	110	122	187	40	54	PT1/4			
EAF/EBFM4600F40	46	3D	2	156	168	233	40	54	PT1/4			
EAF/EBFL4600F40	46	4D	2	202	214	279	40	54	PT1/4			
EAF/EBFS4700F40	47	2D	2	113	124	189	40	54	PT1/4			
EAF/EBFM4700F40	47	3D	2	160	171	236	40	54	PT1/4			
EAF/EBFL4700F40	47	4D	2	207	218	283	40	54	PT1/4			
EAF/EBFS4800F40	48	2D	2	115	126	191	40	54	PT1/4			
EAF/EBFM4800F40	48	3D	2	163	174	239	40	54	PT1/4			
EAF/EBFL4800F40	48	4D	2	211	222	287	40	54	PT1/4			
EAF/EBFS4900F40	49	2D	2	118	133	198	40	58	PT1/4			
EAF/EBFM4900F40	49	3D	2	167	182	247	40	58	PT1/4			
EAF/EBFL4900F40	49	4D	2	216	231	296	40	58	PT1/4			
EAF/EBFS4600F40	46	2D	2	110	122	187	40	54	PT1/4			
EAF/EBFM4600F40	46	3D	2	156	168	233	40	54	PT1/4			
EAF/EBFL4600F40	46	4D	2	202	214	279	40	54	PT1/4			
EAF/EBFS4700F40	47	2D	2	113	124	189	40	54	PT1/4			
EAF/EBFM4700F40	47	3D	2	160	171	236	40	54	PT1/4			
EAF/EBFL4700F40	47	4D	2	207	218	283	40	54	PT1/4			
EAF/EBFS4800F40	48	2D	2	115	126	191	40	54	PT1/4			
EAF/EBFM4800F40	48	3D	2	163	174	239	40	54	PT1/4			
EAF/EBFL4800F40	48	4D	2	211	222	287	40	54	PT1/4			
EAF/EBFS4900F40	49	2D	2	118	133	198	40	58	PT1/4			
EAF/EBFM4900F40	49	3D	2	167	182	247	40	58	PT1/4			
EAF/EBFL4900F40	49	4D	2	216	231	296	40	58	PT1/4			

# 焊刃刀具

## BRAZED CARBIDE TOOLS

焊刃式合金刀具的钨钢原料  
是由日本三菱提供





**SWE2** 螺旋焊刃式超微粒钨钢铣刀-2刃过中心

BRAZED CARBIDE TOOLS

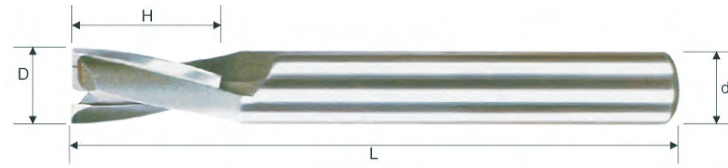

标准型

型号 Designation	外径 D <sub>±0.03</sub>	刃长 H	柄径 d(h7)	全长 L	齿数 T
<b>SWE2</b> 12X30H	12	30	12	80	2
14X35H	14	35	16	90	2
16X40H	16	40	16	95	2
18X40H	18	40	20	100	2
20X45H	20	45	20	110	2
25X50H	25	50	25	120	2

**SWEL2** 螺旋焊刃式超微粒钨钢铣刀-2刃过中心

BRAZED CARBIDE TOOLS

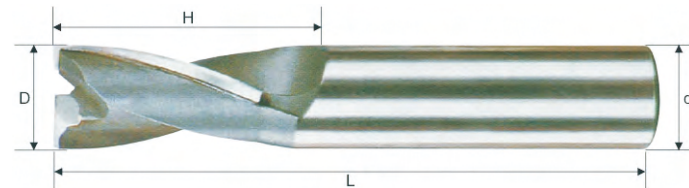

加长型

型号 Designation	外径 D <sub>±0.03</sub>	刃长 H	柄径 d(h7)	全长 L	齿数 T
<b>SWEL2</b> 12X40H	12	40	12	90	2
14X45H	14	45	12	115	2
16X50H	16	50	16	120	2
18X60H	18	60	20	120	2
20X75H	20	75	20	150	2
25X100H	25	100	25	180	2

**SWE4** 螺旋焊刃式超微粒钨钢铣刀-4刃

BRAZED CARBIDE TOOLS

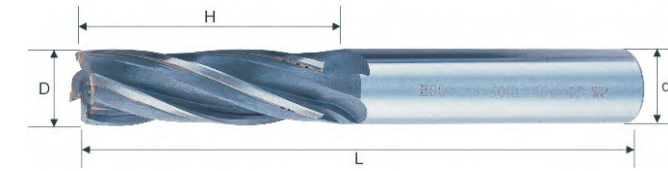

标准型

型号 Designation	外径 D <sub>±0.03</sub>	刃长 H	柄径 d(h7)	全长 L	齿数 T
<b>SWE4</b> 12X30H	12	30	12	80	4
14X35H	14	35	16	90	4
16X40H	16	40	16	95	4
18X40H	18	40	20	100	4
20X45H	20	45	20	110	4
25X50H	25	50	25	120	4
30X55H	30	55	25	125	4
32X60H	32	60	32	145	4
35X65H	35	65	32	150	4
40X65H	40	65	32	150	4
45X70H	45	70	32	160	4
50X70H	50	70	32	160	4

**SWEL4** 螺旋焊刃式超微粒钨钢铣刀-4刃

BRAZED CARBIDE TOOLS

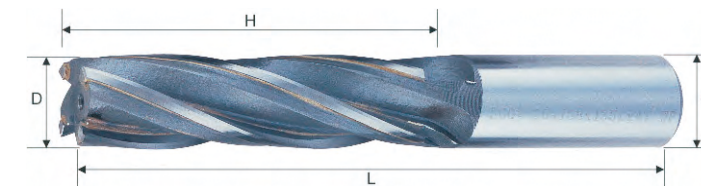

加长型

型号 Designation	外径 D <sub>±0.03</sub>	刃长 H	柄径 d(h7)	全长 L	齿数 T
<b>SWEL4</b> 12X40H	12	40	12	90	4
14X45H	14	45	16	105	4
16X50H	16	50	16	120	4
18X60H	18	60	20	120	4
20X75H	20	75	20	135	4
25X85H	25	85	25	175	4
30X100H	30	100	25	195	4
32X105H	32	105	32	205	4
35X105H	35	105	32	205	4
40X105H	40	105	32	205	4
45X105H	45	105	32	205	4
50X125H	50	125	32	240	4



**SWEXL4** 螺旋焊刃式超微粒钨钢铣刀-4刃

**BRAZED CARBIDE TOOLS**

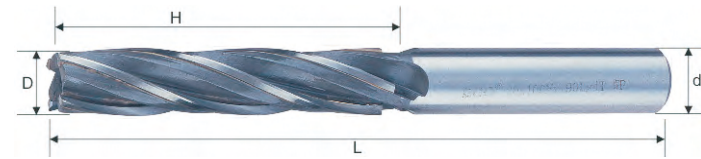

型号 Designation	外径 D <sub>±0.03</sub>	刃长 H	柄径 d(h7)	全长 L	齿数 T
<b>SWEXL4</b> 20X100H	20	100	20	180	4
25X120H	25	120	25	210	4
30X120H	30	120	25	210	4
32X120H	32	120	32	210	4
35X150H	35	150	32	250	4
40X150H	40	150	32	250	4
40X200H	40	200	32	305	4
45X150H	45	150	32	250	4
45X200H	45	200	32	305	4
50X150H	50	150	32	250	4
50X200H	50	200	32	305	4

**SWER** 螺旋焊刃式超微粒钨钢粗铣刀-4刃

**BRAZED CARBIDE TOOLS**

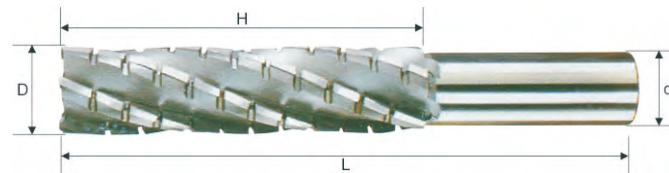

型号 Designation	外径 D <sub>±0.05</sub>	刃长 H	柄径 d(h7)	全长 L	齿数 T
<b>SWER4</b> 30X60H	30	60	32	140	4
30X80H	30	80	32	160	4
30X105H	30	105	32	205	4
32X60H	32	60	32	140	4
32X80H	32	80	32	160	4
32X105H	32	105	32	205	4
35X60H	35	60	32	140	4
35X80H	35	80	32	160	4
35X105H	35	105	32	205	4
40X60H	40	60	32	140	4
40X80H	40	80	32	160	4
40X105H	40	105	32	205	4
50X105H	50	105	42	205	5
50X125H	50	125	42	225	5
50X150H	50	150	42	250	5
50X205H	50	205	42	305	5

**SWERT** 螺旋焊刃式超微粒钨钢筒状铣刀

**BRAZED CARBIDE TOOLS**



型号 Designation	外径 D <sub>±0.05</sub>	孔径 d(H7)	刃高 H	全长 L	齿数 T
<b>SWERT</b> 60X55H	60	1"	55	70	6
60X80H	60	1"	80	95	6
75X70H	75	1"1/4	70	85	8
75X80H	75	1"1/4	80	95	8
75X100H	75	1"1/4	100	115	8

**SWET** 螺旋焊刃式超微粒钨钢筒状铣刀

**BRAZED CARBIDE TOOLS**

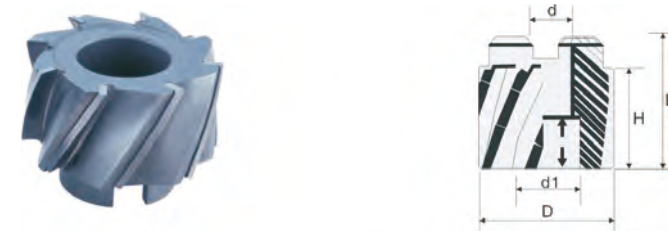

型号 Designation	外径 D <sub>±0.05</sub>	孔径 d(H7)	刃高 H	全长 L	齿数 T
<b>SWET</b> 60X48H	60	1"	48	65	6
60X70H	60	1"	70	85	6
75X48H	75	1"1/4	48	65	8
75X70H	75	1"1/4	70	85	8
75X100H	75	1"1/4	100	115	8

**SWEFT** 焊刃式超微粒钨钢筒状平面铣刀

**BRAZED CARBIDE TOOLS**



型号 Designation	外径 D <sub>±0</sub>	孔径 d(H7)	刃高 H	底盘直径 d1	总高度 L	齿数 T
<b>SWEFT</b> 75X15H	75	1"	15	46	55	8
100X15H	100	1"1/4	15	60	55	10
125X15H	125	1"1/4	15	70	55	14
150X15H	150	2"	15	80	55	16

**SWT** 焊刃式超微粒钨钢T型铣刀(平齿刃)

**BRAZED CARBIDE TOOLS**

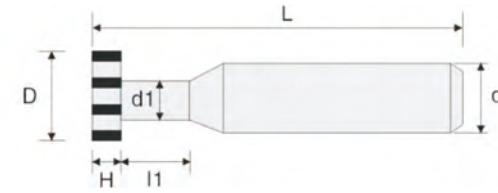

型号 Designation	外径 D	刃高 H	头径 d1	头长 l1	柄径 d(h7)	全长 L	齿数 T
<b>SWT</b> 16X(3~12)H	16	3/4/5/6/8/10/12	7	15	12	100	4
20X(3~12)H	20	3/4/5/6/8/10/12	10	15	12	100	4
25X(3~12)H	25	3/4/5/6/8/10/12	13	15	16	120	6
30X(3~12)H	30	3/4/5/6/8/10/12	15	15	16	120	6
32X(3~12)H	32	3/4/5/6/8/10/12	15	15	16	120	6
35X(3~12)H	35	3/4/5/6/8/10/12	15	15	16	120	6
40X(3~12)H	40	3/4/5/6/8/10/12	21	15	25	140	6
45X(3~12)H	45	3/4/5/6/8/10/12	23	15	25	140	6
50X(3~12)H	50	3/4/5/6/8/10/12	24.5	15	25	140	8
60X(3~12)H	60	3/4/5/6/8/10/12	30	20	32	140	10

**SWD** 焊刃式超微粒钨钢鸠尾槽铣刀-45°

**BRAZED CARBIDE TOOLS**

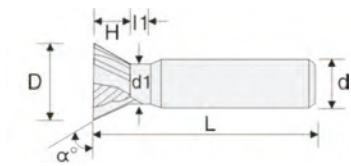

型号 Designation	外径 D $\pm 0.010$	刃高 H	头径 d1	头长 l1	单边角度 $\alpha^\circ$	柄径 d(h7)	全长 L	齿数 T
<b>SWD45°</b> 20	20	6	9	15	45°	12	95	4
25	25	7	10	15	45°	12	95	4
30	30	8	11	15	45°	16	100	4
35	35	10	13	15	45°	16	100	4
40	40	12	13	15	45°	20	100	6
45	45	13	17	15	45°	20	100	6
50	50	15	17	15	45°	25	105	6
60	60	18	21	15	45°	25	110	6
65	65	20	21	20	45°	25	110	6

**SWTS** 焊刃式超微粒钨钢T型铣刀(千鸟刃)

**BRAZED CARBIDE TOOLS**

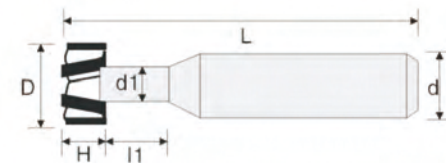

型号 Designation	外径 D	刃高 H	头径 d1	头长 l1	柄径 d(h7)	全长 L	齿数 T
<b>SWTS</b> 16X(6~12)H	16	6/8/10/12	7	15	12	100	4
20X(6~12)H	20	6/8/10/12	10	15	12	100	4
25X(6~12)H	25	6/8/10/12	13	15	16	120	6
30X(6~12)H	30	6/8/10/12	15	15	16	120	6
32X(6~12)H	32	6/8/10/12	15	15	16	120	6
35X(6~12)H	35	6/8/10/12	15	15	16	120	6
40X(6~12)H	40	6/8/10/12	21	15	25	140	6
45X(6~12)H	45	6/8/10/12	23	15	25	140	6
50X(8~12)H	50	6/8/10/12	24.5	15	25	140	8
60X(8~12)H	60	6/8/10/12	30	20	32	140	10

**SWD** 焊刃式超微粒钨钢鸠尾槽铣刀-60°

**BRAZED CARBIDE TOOLS**

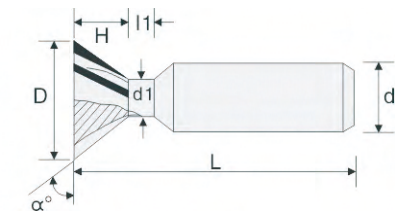
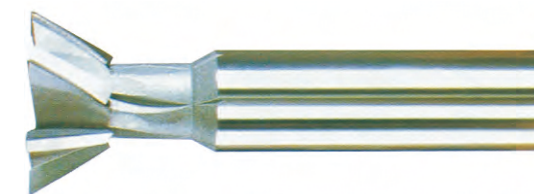

型号 Designation	外径 D $\pm 0.010$	刃高 H	头径 d1	头长 l1	单边角度 $\alpha^\circ$	柄径 d(h7)	全长 L	齿数 T
<b>SWD60°</b> 20	20	8	9	15	60°	12	95	4
25	25	11	10	15	60°	12	95	4
30	30	14	11	15	60°	20	100	4
35	35	15	15	15	60°	20	100	6
40	40	17	17	20	60°	20	105	6
45	45	20	19	20	60°	20	105	6
50	50	22	22	20	60°	25	110	6
55	55	26	22	20	60°	25	110	6
60	60	28	25	20	60°	32	120	6
65	65	32	25	20	60°	32	120	6

**SWA** 焊刃式超微粒钨钢倒角铣刀-45°

**BRAZED CARBIDE TOOLS**

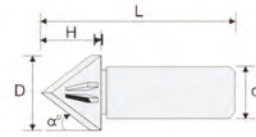
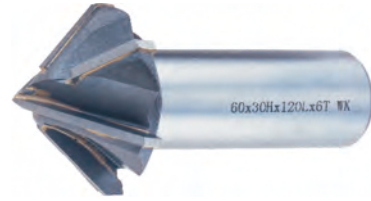

型号 Designation	外径 D <sub>+0.05</sub>	刃高 H	单边角度 α°	柄径 d(h7)	全长 L	齿数 T
<b>SWA45°20</b>	20	10	45°	16	90	2
25	25	12	45°	16	90	2
30	30	15	45°	20	100	2
35	35	17	45°	20	100	2
40	40	20	45°	25	100	2
50	50	25	45°	32	110	4
60	60	30	45°	32	120	6

**SWDT** 焊刃式超微粒钨钢鸠尾槽筒状铣刀-60°

**BRAZED CARBIDE TOOLS**

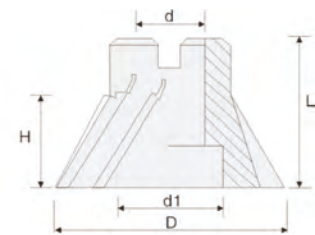

型号 Designation	外径 D <sub>+0.05</sub>	刃高 H	孔径 d(H7)	底盘直径 d1	总高度 L	齿数 T
<b>SWDT60° 80</b>	80	30	1"	42	50	8
100	100	40	1"	50	60	10
100	100	40	1"1/4	50	60	10
125	125	50	1"1/4	60	70	10
150	150	55	1"1/2	80	75	12

**SWST** 焊刃式超微粒钨钢筒状侧铣刀

**BRAZED CARBIDE TOOLS**

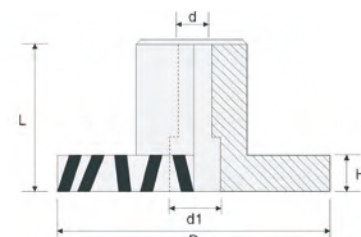

型号 Designation	外径 D <sub>+0.05</sub>	刃高 H	孔径 d(H7)	底盘直径 d1	总高度 L	齿数 T
<b>SWST 100X16H</b>	100	16	1"1/4	55	60	14
125X18H	125	18	1"1/4	60	60	16
150X20H	150	20	1"1/4	70	60	18

焊刃式超微粒钨钢侧铣刀

**BRAZED CARBIDE TOOLS**

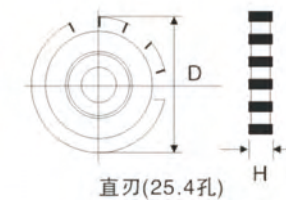

直刃(25.4孔)

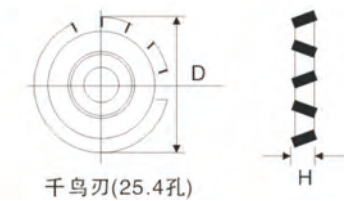

千鸟刃(25.4孔)

型号 Designation	外径 D <sub>+0.05</sub>	刀厚 H	齿数 T
<b>SWS 75X3H</b>	75	3	14
75X4H	75	4	14
75X5H	75	5	14
75X6H	75	6	14
75X7H	75	7	14
100X3H	100	3	16
100X4H	100	4	16
100X5H	100	5	16
100X6H	100	6	16
100X7H	100	7	16
125X3H	125	3	18
125X4H	125	4	18
125X5H	125	5	18
125X6H	125	6	18
125X7H	125	7	18
150X3H	150	3	20
150X4H	150	4	20
150X5H	150	5	20
150X6H	150	6	20
150X7H	150	7	20
175X5H	175	5	20
175X6H	175	6	20
175X7H	175	7	20
200X5H	200	5	24
200X6H	200	6	24
200X7H	200	7	24

型号 Designation	外径 D <sub>+0.05</sub>	刀厚 H	齿数 T
<b>SWSS 75X8H</b>	75	8	14
75X9H	75	9	14
75X10H	75	10	14
75X11H	75	11	14
75X12H	75	12	14
100X8H	100	8	16
100X9H	100	9	16
100X10H	100	10	16
100X11H	100	11	16
100X12H	100	12	16
125X8H	125	8	18
125X9H	125	9	18
125X10H	125	10	18
125X11H	125	11	18
125X12H	125	12	18
150X8H	150	8	20
150X9H	150	9	20
150X10H	150	10	20
150X11H	150	11	20
150X12H	150	12	20
175X8H	175	8	20
175X9H	175	9	20
175X10H	175	10	20
175X11H	175	11	20
175X12H	175	12	20
200X8H	200	8	24
200X9H	200	9	24
200X10H	200	10	24
200X11H	200	11	24
200X12H	200	12	24



SWRMT

螺旋焊刃式超微粒钨钢左旋机械铰刀-莫氏锥柄

BRAZED CARBIDE TOOLS

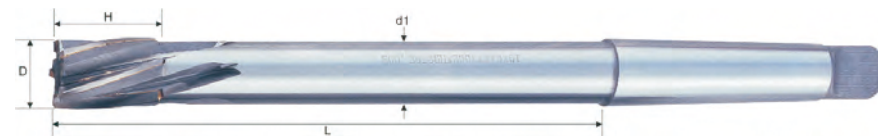

型号 Designation	外径 D(H7)	刃长 H	工作长 L	头径 d1	锥柄 MT	齿数 T
SWRMT 12	12	20	150	11	2#	4
14	14	20	150	13	2#	4
15	15	25	150	14	3#	4
16	16	25	150	15	3#	4
17	17	25	150	16	3#	4
18	18	35	200	17	3#	5
19	19	35	200	18	3#	5
20	20	35	200	19	3#	5
22	22	35	200	20	3#	5
23	23	35	200	21	3#	5
24	24	35	200	22	3#	5
25	25	35	200	22	3#	5
28	28	35	230	25	4#	6
30	30	35	230	26	4#	6
32	32	35	230	28	4#	6
35	35	35	230	31	4#	6
40	40	40	260	34	4#	6
42	42	40	260	36	4#	6
45	45	40	260	38	4#:5#	6
50	50	50	300	44	4#:5#	6
55	55	50	300	46	4#:5#	8
60	60	50	300	50	4#:5#	8

SWRM

螺旋焊刃式超微粒钨钢左旋机械铰刀-直柄

BRAZED CARBIDE TOOLS

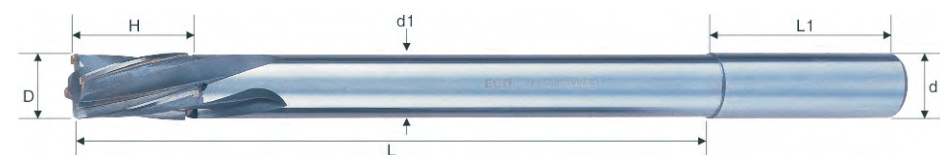

型号 Designation	外径 D(H7)	刃长 H	工作长 L	柄径 d(h7)	柄长 L1	齿数 T
SWRM 12	12	120	11	12	50	4
14	14	150	13	16	60	4
15	15	150	14	16	60	4
16	16	150	15	16	60	4
20	20	200	19	20	60	5
25	25	200	20	20	60	5

GF

西德极超微粒整体钨钢合金刀

BRAZED CARBIDE TOOLS

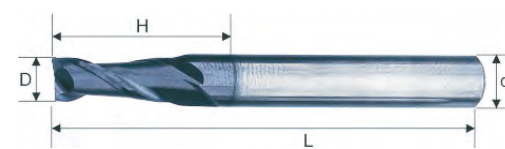

2刃平底(标准型) 产品编号GF-2ES

型号	刃径(D)	柄径(d)	刃长(H)	全长(L)
GF-2ES1D4d150L	1	4	3	50
GF-2ES1.5D4d50L	1.5	4	4	50
GF-2ES2D4d50L	2	4	6	50
GF-2ES2.5D4d50L	2.5	4	8	50
GF-2ES3D3d50L	3	3	8	50
GF-2ES3D4d50L	3	4	8	50
GF-2ES4D4d50L	4	4	11	50
GF-2ES4D6d50L	4	6	11	50
GF-2ES5D5d50L	5	5	13	50
GF-2ES5D6d50L	5	6	13	50
GF-2ES6D6d50L	6	6	16	50
GF-2ES8D8d60L	8	8	20	60
GF-2ES10D10d72L	10	10	22	72
GF-2ES12D12d75L	12	12	26	75

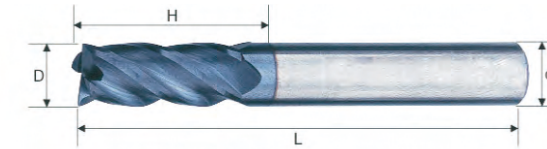

4刃平底(标准型) 产品编号GF-4ES

型号	刃径(D)	柄径(d)	刃长(H)	全长(L)
GF-4ES1D4d50L	1	4	3	50
GF-4ES1.5D4d50L	1.5	4	4	50
GF-4ES2D4d50L	2	4	6	50
GF-4ES2.5D4d50L	2.5	4	8	50
GF-4ES3D3d50L	3	3	8	50
GF-4ES3D4d50L	3	4	8	50
GF-4ES4D4d50L	4	4	11	50
GF-4ES4D6d50L	4	6	11	50
GF-4ES5D5d50L	5	5	13	50
GF-4ES5D6d50L	5	6	13	50
GF-4ES6D6d50L	6	6	16	50
GF-4ES8D8d60L	8	8	20	60
GF-4ES10D10d72L	10	10	22	72
GF-4ES12D12d75L	12	12	26	75
GF-4ES16D16d100L	16	16	38	100

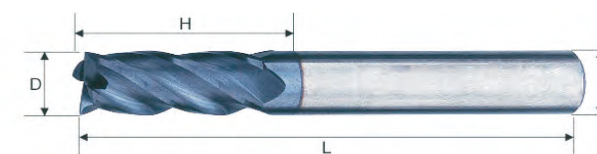

4刃平底(加长型) 产品编号GF-4EL

型号	刃径(D)	柄径(d)	刃长(H)	全长(L)
GF-4EL4D4d70L	4	4	12	70
GF-4EL6D6d80L	6	6	20	80
GF-4EL8D8d90L	8	8	25	90
GF-4EL10D10d100L	10	10	30	100
GF-4EL12D12d110L	12	12	35	110
GF-4EL16D16d140L	16	16	40	140

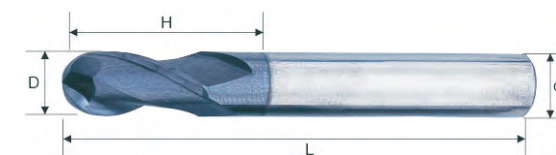

2刃球刀(标准型) 产品编号GF-2BS

型号	刃径(D)	柄径(d)	刃长(H)	全长(L)
GF-2BS0.5R4d50L	0.5R	4	2	50
GF-2BS0.75R4d50L	0.75R	4	3	50
GF-2BS1R4d50L	1R	4	4	50
GF-2BS1.5R3d50L	1.5R	3	6	50
GF-2BS1.5R4d50L	1.5R	4	6	50
GF-2BS2R4d50L	2R	4	8	50
GF-2BS2R6d50L	2R	6	8	50
GF-2BS2.5R5d50L	2.5R	5	10	50
GF-2BS2.5R6d50L	2.5R	6	10	50
GF-2BS3R6d50L	3R	6	12	50
GF-2BS4R8d60L	4R	8	16	60
GF-2BS5R10d72L	5R	10	20	72
GF-2BS6R12d75L	6R	12	24	75
GF-2BS8R16d100L	8R	16	32	100

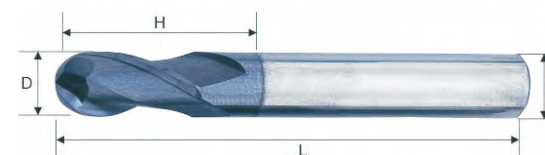

2刃球头(加长型) 产品编号GF-2BL

型号	刃径(D)	柄径(d)	刃长(H)	全长(L)
GF-2BL2R4d70L	2R	4	8	70
GF-2BL3R6d80L	3R	6	12	80
GF-2BL4R8d90L	4R	8	16	90
GF-2BL5R10d100L	5R	10	20	100
GF-2BL6R12d110L	6R	12	24	110
GF-2BL8R16d140L	8R	16	32	140



**GTX** 西德极超微粒整体钨钢合金刀

**BRAZED CARBIDE TOOLS**

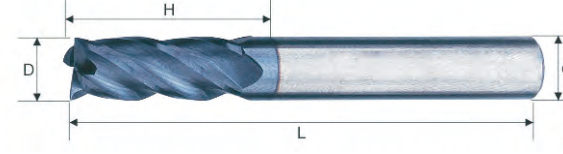
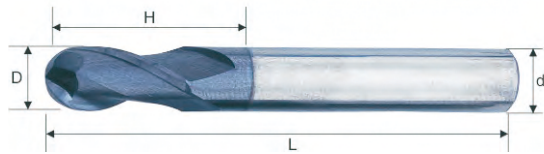

2刃球形立铣刀 产品编号**GTX-2BS**

型号	半径(D)	刃长(H)	柄径(d)	全长(L)	刃数(T)
GTX-2BS0.5R4d50L	0.5R	1	4	50	2
GTX-2BS0.75R4d50L	0.75R	3	4	50	2
GTX-2BS1R4d50L	1R	4	4	50	2
GTX-2BS1.25R4d50L	1.25R	5	4	50	2
GTX-2BS1.5R4d50L	1.5R	6	4	50	2
GTX-2BS2R4d50L	2R	6	4	50	2
GTX-2BS2.5R6d50L	2.5R	10	6	50	2
GTX-2BS3R6d50L	3R	12	6	50	2
GTX-2BS4R8d50L	4R	16	8	60	2
GTX-2BS5R10d75L	5R	20	10	75	2
GTX-2BS6R12d75L	6R	24	12	75	2

4刃平底立铣刀 产品编号**GTX-4ES**

型号	直径(D)	刃长(H)	柄径(d)	全长(L)	刃数(T)
GTX-4ES1D4d50L	1	3	4	50	4
GTX-4ES1.5D4d50L	1.5	4	4	50	4
GTX-4ES2D4d50L	2	6	4	50	4
GTX-4ES2.5D4d50L	2.5	8	4	50	4
GTX-4ES3D4d50L	3	8	4	50	4
GTX-4ES4D4d50L	4	11	4	50	4
GTX-4ES3D6d50L	3	8	6	50	4
GTX-4ES4D6d50L	4	11	6	50	4
GTX-4ES5D6d50L	5	13	6	50	4
GTX-4ES6D6d50L	6	16	6	50	4
GTX-4ES8D8d60L	8	20	8	60	4
GTX-4ES10D10d75L	10	30	10	75	4
GTX-4ES12D12d75L	12	32	12	75	4

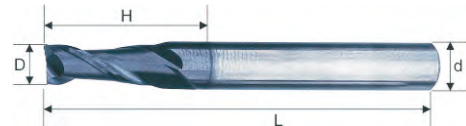

2刃平底立铣刀 产品编号**GTX-2ES**

型号	直径(D)	刃长(H)	柄径(d)	全长(L)	刃数(T)
GTX-2ES1D4d50L	1	3	4	50	2
GTX-2ES1.5D4d50L	1.5	4	4	50	2
GTX-2ES2D4d50L	2	6	4	50	2
GTX-2ES2.5D4d50L	2.5	8	4	50	2
GTX-2ES3D4d50L	3	8	4	50	2
GTX-2ES4D4d50L	4	11	4	50	2
GTX-2ES3D6d50L	3	8	6	50	2
GTX-2ES4D6d50L	4	11	6	50	2
GTX-2ES5D6d50L	5	13	6	50	2
GTX-2ES6D6d50L	6	16	6	50	2
GTX-2ES8D8d60L	8	20	8	60	2
GTX-2ES10D10d75L	10	30	10	75	2
GTX-2ES12D12d75L	12	32	12	75	2

**BT-SK** 铣削夹持具

MILLING TOOLS



**BT-SK 高速刀柄** 预设动平衡、精度高, 适合高速旋转 最高转速40000MIN<sup>-1</sup>

型号 Cat.No	夹持范围 Clamping range	尺寸 Size				最高旋转数 MAX. min-1	SK筒夹 collet
		L	L1	C	GNO		
<b>BT30</b> -SK6-60 -SK6-90	2~6.0	60	38	19	SK6	40,000	SK6
		90	68				
-SK10-60 -SK10-90	2~10.0	60	38	27	SK10	40,000	SK10
		90	68				
-SK16-60 -SK16-90	3~16.0	60	38	40	SK16	30,000	SK16
		90	68				
<b>BT40</b> -SK6-60 -SK6-90	2~6.0	60	33	19	SK6	30,000	SK6
		90	63				
-SK10-60 -SK10-90	2~10.0	60	33	27	SK10	30,000	SK10
		90	63				
-SK16-60 -SK16-90	3~16.0	60	33	40	SK16	25,000	SK16
		90	63				
-SK25-90	6~25.4	90	63	55	SK25	20,000	SK25
<b>BT50</b> -SK10-105 -SK16-105	2~10.0	105	67	27	SK10	20,000	SK10
-SK16-105 -SK25-105	3~16.0	105	67	40	SK16	20,000	SK16
-SK25-105	6~25.4	105	67	55	SK25	15,000	SK25

- 1、不带锁紧扳手如需要请另订购
- 2、不附带拉丁



**SK型扳手**

样式 Pattern	型号 Cat.No	D	重量 weight(KG)
标准型	SK6-SP	19.5	0.2
	SK10-SP	27.5	0.27
	SK16-SP	40	0.39
	SK25-SP	55	0.45

**特点**

- 1、表面硬度HV220的滑动旋转, 不会损伤, 无影响
- 2、面与面接触, 微米跳动切削力提高, 刀具使用寿命延长
- 3、同心度高, 稳定的震动精度, 提高精加工面粗度



**SK高速螺帽**

样式 Pattern	型号 Cat.No	D
标准型	SK6-SP	19.5
	SK10-SP	27.5
	SK16-SP	40
	SK25-SP	55

**BT-ER** 铣削夹持具 MILLING TOOLS



BT-ER弹性刀柄

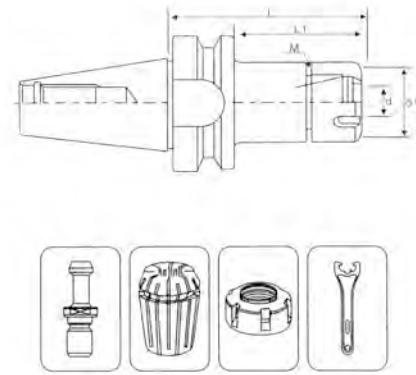

型号 Specification	把握直径 Chuking dia d	d1	d2	L	L1	M	螺帽 Nut	筒夹 Collet	扳手 spanner	重量 weight(KG)
<b>BT30</b> -ER16-70	3-10	28	28	70	48	M22X1.5	ER16A	ER16	ER16A	0.55
				100	78					0.80
-ER20-70	3-13	34	34	70	48	M25X1.5	ER20A	ER20	ER20A	0.75
				100	78					0.85
-ER25-70	3-16	42	40	70	48	M32X1.5	ER25UM	ER25	ER25UM	0.70
				100	78					1.45
-ER32-70	3-20	50	48	70	48	M40X1.5	ER32UM	ER32	ER32UM	0.95
				100	78					1.05
-ER16-70	3-10	28	28	70	43	M22X1.5	ER16A	ER16	ER16A	1.20
				100	73					1.30
-ER16-100	3-10	28	28	150	123	M22X1.5	ER16A	ER16	ER16A	1.35
				150	123					1.35
-ER20-70	3-13	34	34	70	43	M25X1.5	ER20A	ER20	ER20A	1.40
				100	73					1.50
-ER20-100	3-13	34	34	150	123	M25X1.5	ER20A	ER20	ER20A	1.70
				150	123					1.70
-ER25-70	3-16	42	40	70	43	M32X1.5	ER25UM	ER25	ER25UM	1.30
				100	73					1.65
-ER25-100	3-16	42	40	150	123	M32X1.5	ER25UM	ER25	ER25UM	2.25
				150	123					2.25
-ER32-70	3-20	50	48	80	43	M40X1.5	ER32UM	ER32	ER32UM	1.30
				100	73					1.70
-ER32-100	3-20	50	48	150	123	M40X1.5	ER32UM	ER32	ER32UM	2.50
				150	123					2.50
-ER40-100	6-26	63	58	100	73	M50X1.5	ER40UM	ER40	ER40UM	2.05
				150	123					3.10
-ER16-100	3-10	28	28	100	62	M22X1.5	ER16A	ER16	ER16A	4.30
				150	112					4.50
-ER20-100	3-13	34	34	100	62	M25X1.5	ER20A	ER20	ER20A	4.30
				150	112					4.70
-ER25-100	3-16	42	40	100	62	M32X1.5	ER25UM	ER25	ER25UM	4.40
				150	112					5.50
-ER32-100	3-20	50	50	100	62	M40X1.5	ER32UM	ER32	ER32UM	4.80
				150	112					5.30
-ER40-100	6-26	63	60	100	62	M50X1.5	ER40UM	ER40	ER40UM	4.40
				150	112					5.50

特点

- 1、螺帽预设动平衡设计
- 2、刀柄精度0.003MM

**BT** 铣削夹持具 MILLING TOOLS

- 1、本体
- 2、同心扣环
- 3、垫片
- 4、平面油封
- 5、轴承钢
- 6、滚丁
- 7、螺帽
- 8、垫片
- 9、平面油封
- 10、同心扣环

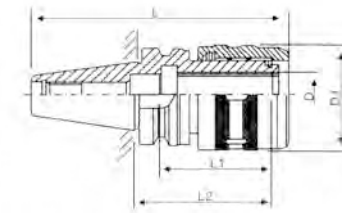
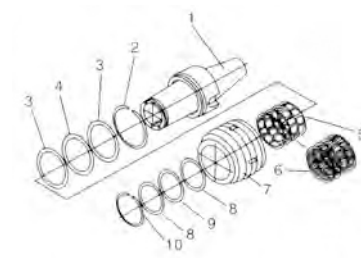

采用直型筒夹，精度高。



BT强力型刀柄

型号 Cat.No	尺寸 Size					扳手 suitable spanner	SK筒夹 suitable collet	重量 weight(KG)
	D	L2	L1	L	D1			
<b>BT30</b> -C20-80	20	80	70	128.4	53	C20-BS	C20	1.80
	-C25-80	25	80	73	128.4			60
<b>BT30</b> -C20-105	20	105	70	170.4	53	C20-BS	C20	2.60
	-C25-105	25	105	73	170.4			60
-C32-105	32	105	76	170.4	70	C32-BS	C32	2.80
	-C32-135	32	135	76	200.4			70
-C32-165	32	165	76	230.4	70	C32-BS	C32	3.50
	<b>BT30</b> -C20-105	20	105	70	206.8			53
-C25-105	25	105	73	206.8	60	C25-BS	C25	4.60
	-C32-105		105		206.8			
-C32-135	32	135	95	236.8	70	C32-BS	C32	5.90
	-C32-165		165		266.8			
-C42-115	42	115	38	216.8	92	C42-BS	C42	6.10
	-C42-135	42	135	38	236.8			92
-C42-165	42	165	38	266.8	92	C42-BS	C42	7.40

特点

- 1、刀柄内孔分割6槽以防止滑动，并加大夹持力
- 2、采用雨线装置为使当滑动至针锥面滚动摩擦及脱落至最小
- 3、刀具置入筒夹需超出筒夹有效夹持长度，以避免因非完全夹持，导致筒夹损坏、变形或脱刀情形发生
- 4、夹持部加厚设计，提高刚性，防止振动
- 5、加持力强，跳动精度高。

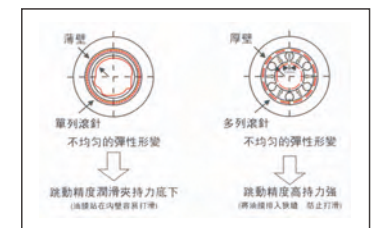

尖头的加厚设计，可以增加刚性，以承受立铣刀的重切削。而采用独特的夹持结构可以使夹持部分均匀变化，以获得强大的夹持力及稳定的跳动精度。



BT-FMB

平面铣刀柄

MILLING TOOLS

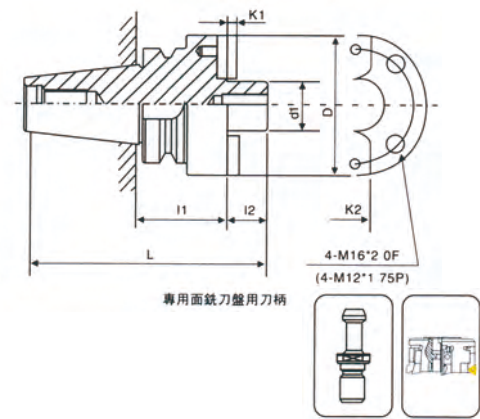

BT-FMB平面铣刀柄(公制)

型号 Cat.No	尺寸 Size							重量 weight(KG)	
	d1	D	L1	L2	L	K1	K2		
BT30	-FMB22-45	22	48	45	18	111.4	4.8	10	0.85
	-FMB27-45	27	60	45	20	113.4	5.8	12	1.20
	-FMB32-45	32	78	45	22	115.4	6.8	14	1.35
BT40	-FMB22-45			45		128.4			1.45
	-FMB22-60			60		143.4			1.70
	-FMB22-100			100		183.4			2.10
	-FMB22-120	22	48	120	18	205.4	4.8	10	2.30
	-FMB22-150			150		233.4			3.10
	-FMB22-200			200		283.4			3.80
	-FMB22-250			250		283.4			4.50
BT50	-FMB22-300			300		333.4			5.10
	-FMB27-60	27	68	45	20	128.4	5.8	12	1.60
	-FMB32-60	32	78	45	22	128.4	6.8	14	1.70
	-FMB40-60	40	80	45	25	128.4	8.3	16	2.10
	-FMB22-45			45		164.8			4.50
	-FMB22-100			100		201.8			5.20
	-FMB22-150	22	48	150	18	269.8	4.8	10	6.80
	-FMB22-200			200		319.8			7.00
	-FMB22-250			250		369.8			8.00
	-FMB27-60			60		176.8			5.20
-FMB27-100	27	60	100	20	201.8	5.8	12	6.50	
-FMB27-150			150		269.8			7.50	
-FMB27-200			200		319.8			9.50	
-FMB32-60			60		176.8			5.20	
-FMB32-100	32	78	100	22	201.8	6.8	14	6.20	
-FMB32-150			150		269.8			7.00	
-FMB40-60			60		176.8			5.20	
-FMB40-100	40	89	100	25	201.8	8.3	16	7.20	
-FMB40-150			150		269.8			7.80	
-FMB60-60	60	140	60	26	161.8	12.5	25.4	8.50	

- 1、整支通孔，利于出水及抗震。
- 2、附带紧固螺丝。
- 3、使用中心内冷时，请另外订购有孔的紧固螺丝。

銑削用刀片型號編制說明

記號 Symbol	頂角 Nose Angle	形狀 Inserts Shape	記號 Symbol	後角 Relief Angle	記號 Symbol	刀尖高度公差 Nose Height	厚度公差 Thickness	內接圓公差 Inscribed Circle	記號 Symbol	孔 Hole	孔的形狀 Fixing	斷屑槽 chip Breaker	形狀 Figure	
H	120		A	3	A	±0.005	±0.025	±0.025	N	無 NI	—	無 NI		
O	135		B	5	F	±0.005	±0.025	±0.013	R	無 NI	—	單面 One Side		
P	108		C	7	C	±0.013	±0.025	±0.025	F	無 NI	—	兩面 Both Sided		
R			D	15	H	±0.013	±0.025	±0.013	A	圓柱孔 Cylindrical Hole	無 NI	無 NI		
S	90		E	20	E	±0.025	±0.025	±0.025	M	單面40-60 40-60Countersink on one side	單面 One Side	無 NI		
T	60		F	25	G	±0.025	±0.13	±0.025	G	兩面40-60 40-60Countersink on both side	兩面 Both Sided	無 NI		
C	80		G	30	J	±0.05	±0.025	±0.05~±0.13	W	單面70-90 70-90Countersink on one side	單面 One Side	無 NI		
D	55		N	0	K※	±0.013	±0.025	±0.05~±0.13	T	有孔 With hole	兩面40-60 40-60Countersink on both side	兩面 Both Sided	無 NI	
E	75		P	11	L※	±0.025	±0.025	±0.05~±0.13	Q	無 NI	—	無 NI		
M	86		O	其它Other	M※	±0.08~±0.18	±0.13	±0.05~±0.13	B	單面70-90 70-90Countersink on one side	單面 One Side	無 NI		
F	50				N※	±0.08~±0.18	±0.025	±0.05~±0.13	H	無 NI	—	無 NI		
V	35				U※	±0.13~±0.38	±0.13	±0.08~±0.25	C	兩面70-90 70-90Countersink on both side	兩面 Both Sided	無 NI		
L	90								J	無 NI	—	兩面 Both Sided		
A	85								X	—	—	—		
B	82													
K	55													
W	80													



內接圓 (mm) Inscribed Circle	5.切削刃長度 Cutting Edge Length							6.厚度 Thickness		7.主切削刃主偏角 Main cutting edge cutting edge angle	8.修光刃後角 Cutting edge angle	9.切削刃標識 Cutting edge identity	10.切削方向 Cutting direction
	T	S	C	D	V	R	W	厚度 Thickness	記號 Symbol				
3.97	06	03	03	04				1.59	01		A=3° B=5° C=7° D=15° E=20° Z=特殊	F E T S 非強制信息	R 右旋 L 左旋 N 中性 (右旋與左旋)
4.76	08	04	04	05			2.38	02					
5.56	09	05	05	06			2.78	T2					
6.0							3.18	03					
6.35	11	06	06	07		04	3.97	T3					
7.94	13	07	08	09		05	4.76	04					
8.0						08	6.35	06					
9.525	16	09	09	11	16	09	7.94	07					
10.0						10	9.52	09					
12.0						12							
12.70	22	12	12	15	19	12							
15.875	27	15	16	19		15							
16.0						16							
19.05	33	19	19	23		19							
20.0						20							
22.225	38	22	22	27									
25.0						25							
25.40	44	25	25	31		25							
31.75	53	31	32	38		31							
						32							