

## Product Specification Sheet

# HIGH VELOCITY 1" S.S. AIR KNIFE

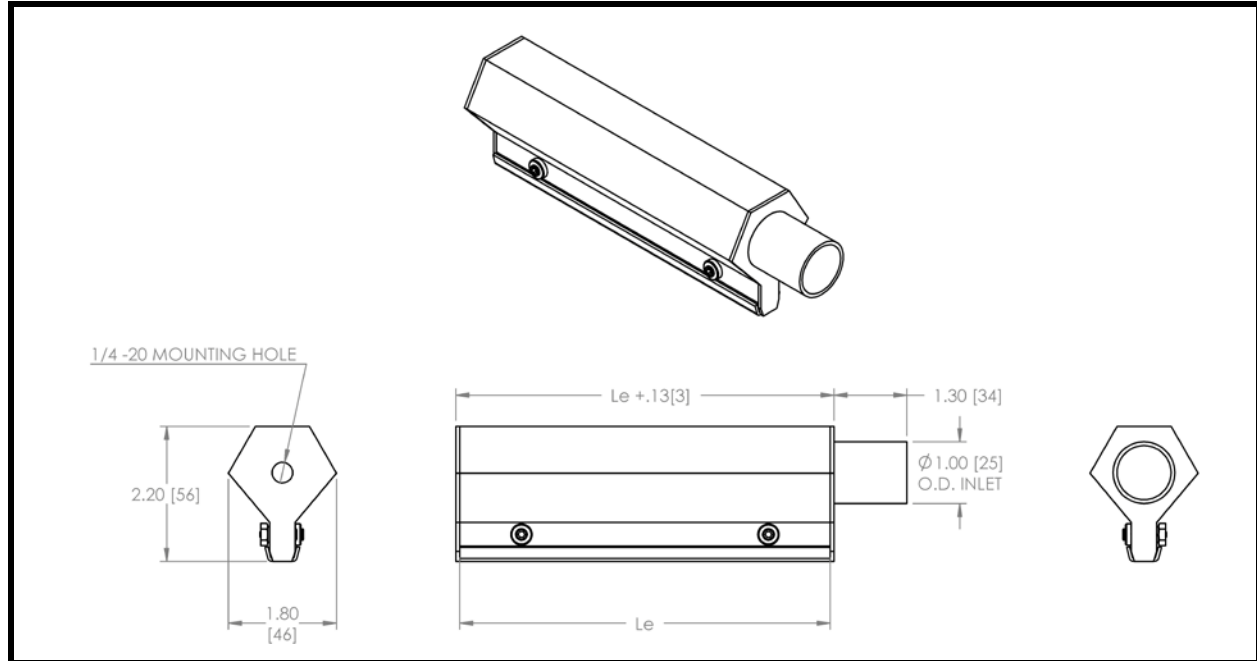

Dimensions in brackets ( ) are in millimeters

<b>Description</b>	Air Knife-1" X %% " LG 300 Series SS
<b>Sonic Part Number</b>	Custom
<b>Standard Slot Lengths (L<sub>e</sub>) [in (mm)]</b>	2.0 (51), 6.0 (153), 12.0 (305), 18.0 (458), 20.0 (508), 24.0 (610)
<b>Maximum Custom Slot Length (L<sub>e</sub>)</b>	48.0 inches (1,220 mm)
<b>Air Knife Inlet Orientations</b>	<a href="#">View Orientations</a>
<b>Air Flow Rate</b>	3.5 cfm/in (65.0 lps/m) to 16.9 cfm/in (314.0 lps/m)
<b>Maximum Air Discharge Velocity</b>	38,000 fpm (11,580 mpm)
<b>Temperature Range</b>	-40°F (-40°C) to 275°F (135°C)
<b>Material</b>	300 Series Stainless Steel
<b>Finish</b>	Electropolish
<b>Approximate Weight</b>	1.5 lbs/ft (2.3 kg/m)

<sup>(1)</sup>%% denotation effective slot length



## Product Specification Sheet

# HIGH VELOCITY 1.5" S.S. AIR KNIFE

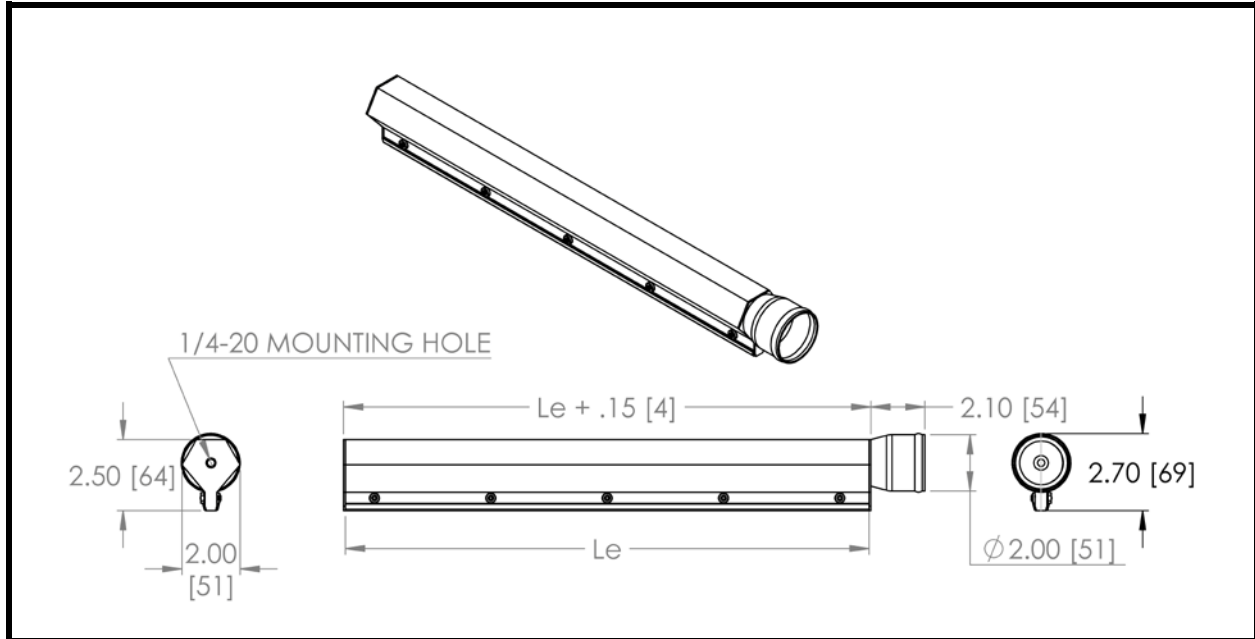

Dimensions in brackets ( ) are in millimeters

<b>Description</b>	Air Knife-1.5" X %%" LG 300 Series SS
<b>Sonic Part Number</b>	Custom
<b>Standard Slot Lengths (<math>L_e</math>) [in (mm)]</b>	2.0 (51), 6.0 (153), 12.0 (305), 18.0 (458), 20.0 (508), 24.0 (610)
<b>Maximum Custom Slot Length (<math>L_e</math>)</b>	48.0 inches (1,220 mm)
<b>Air Knife Inlet Orientations</b>	<a href="#">View Orientations</a>
<b>Air Flow Rate</b>	3.5 cfm/in (65.0 lps/m) to 16.9 cfm/in (314.0 lps/m)
<b>Maximum Air Discharge Velocity</b>	38,000 fpm (11,580 mpm)
<b>Temperature Range</b>	-40°F (-40°C) to 275°F (135°C)
<b>Material</b>	300 Series Stainless Steel
<b>Finish</b>	Elecpolish
<b>Approximate Weight</b>	1.5 lbs/ft (2.3 kg/m)

<sup>(1)</sup>%% denotation effective slot length



**Product Specification Sheet**

**AIR KNIFE - 2" S.S. XE**  
300 SERIES STAINLESS STEEL

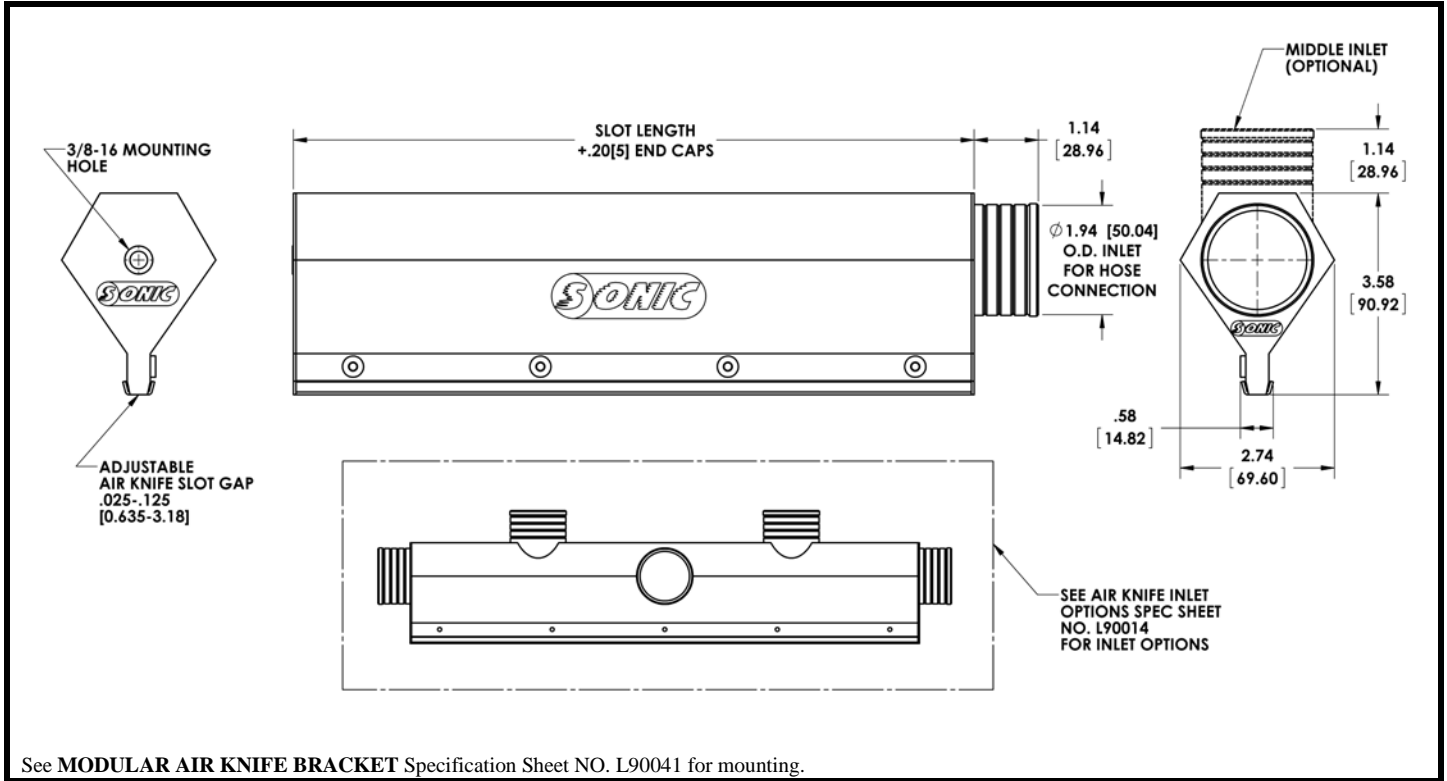
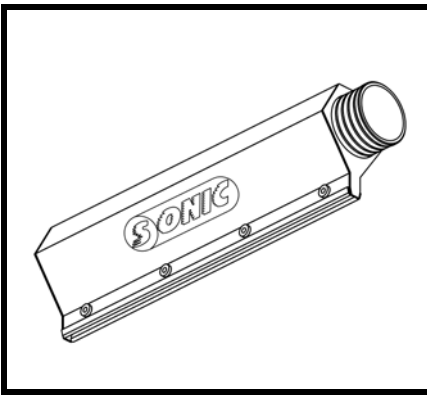

Dimensions in Inches, [ ] are in millimeters

<b>Description</b>	Air Knife-2" X %%" LG 300 Series SS
<b>Sonic Part Number</b>	CALL SONIC
<b>Standard Slot Lengths</b>	12.0 [305], 18.0 [458] 24.0 [610]
<b>Custom Slot Lengths</b>	3.0 to 48.0in [76.2 to 1219.0mm]
<b>Air Flow Rate</b>	3.5 cfm/in to 16.9 cfm/in (65.0 lps/m to 314.0 lps/m)
<b>Maximum Air Discharge Velocity</b>	38,000 fpm (11,582 mpm)
<b>Temperature Range</b>	-40°F to 800°F (-40°C to 427°C)
<b>Material</b>	Body - 16 Gauge 300 Series S.S. End Cap/ Inlet Cap/ Hardware - 300 Series S.S.
<b>Finish</b>	Electropolish
<b>Weight (Approx.)</b>	1.90 lbs/ft (2.83 g/mm)



**Product Specification Sheet**

**AIR KNIFE - 3" S.S. XE**  
300 SERIES STAINLESS STEEL

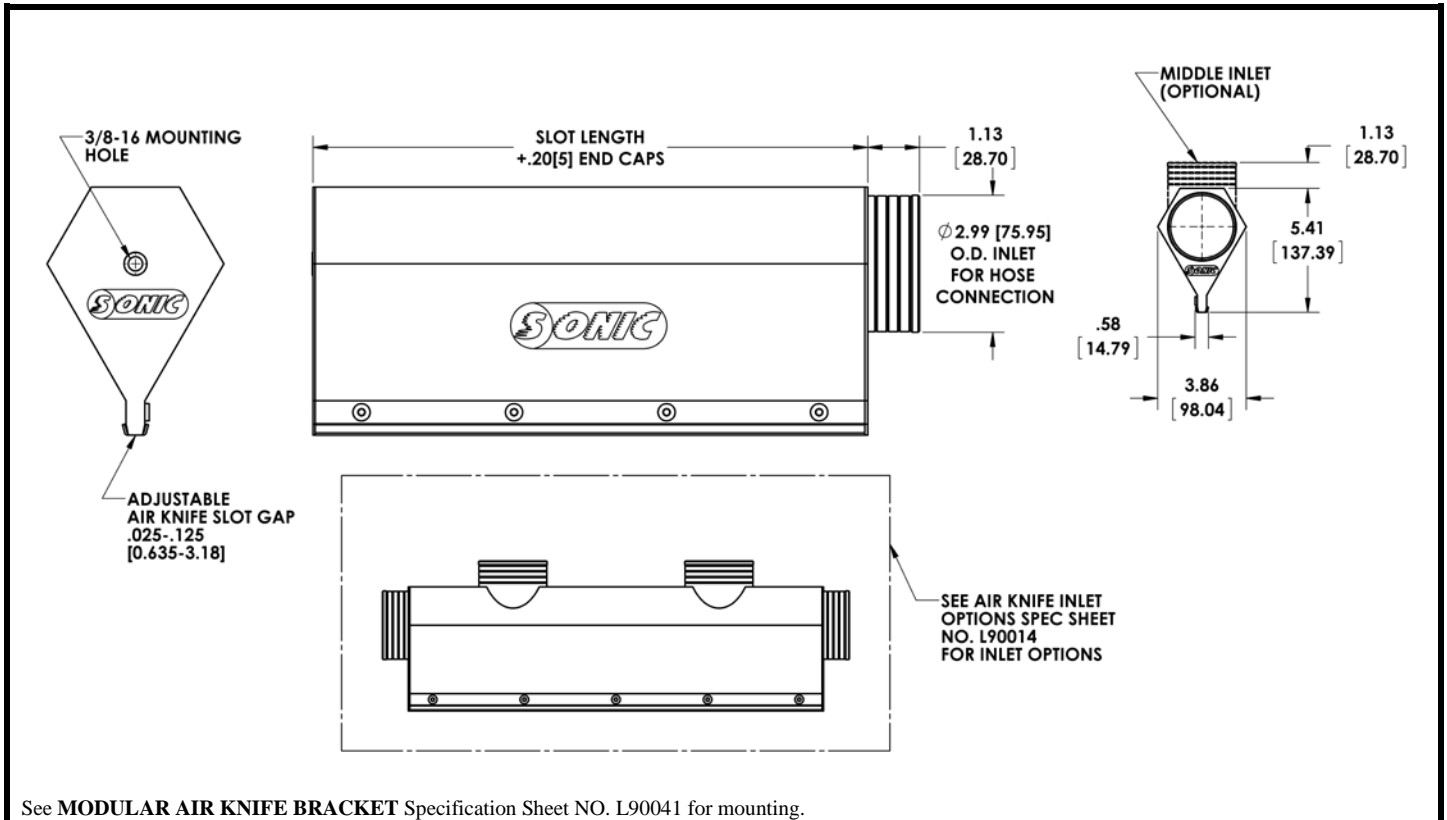
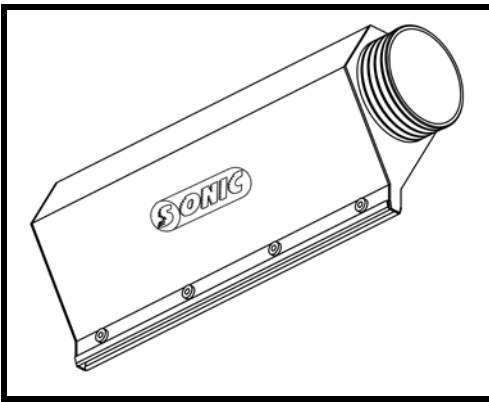

See MODULAR AIR KNIFE BRACKET Specification Sheet NO. L90041 for mounting.

Dimensions in Inches, [ ] are in millimeters

<b>Description</b>	Air Knife-3" X %%" LG 300 Series S.S.	
<b>Sonic Part Number</b>	CALL SONIC	
<b>Standard Slot Lengths</b>	2.0 [51], 6.0 [153], 12.0 [305], 18.0 [458], 24.0 [610], 30.0 [762], 36.0 [915]	
<b>Custom Slot Lengths</b>	3.0 to 100.0in [76.2 to 2540.0mm]	
<b>Air Flow Rate</b>	3.5 cfm/in to 16.9 cfm/in (65.0 lps/m to 314.0 lps/m)	
<b>Maximum Air Discharge Velocity</b>	38,000 fpm (11,582 mpm)	
<b>Temperature Range</b>	-40°F to 800°F (-40°C to 427°C)	
<b>Material</b>	Body - 16 Gauge 300 Series S.S.	End Cap/ Inlet Cap/Hardware - 300 Series S.S.
<b>Finish</b>	Electropolish	
<b>Weight (Approx.)</b>	2.75 lbs/ft (4.09 g/mm)	



**Product Specification Sheet**

**AIR KNIFE - 4" XE**  
**CARBON STEEL OR STAINLESS STEEL**

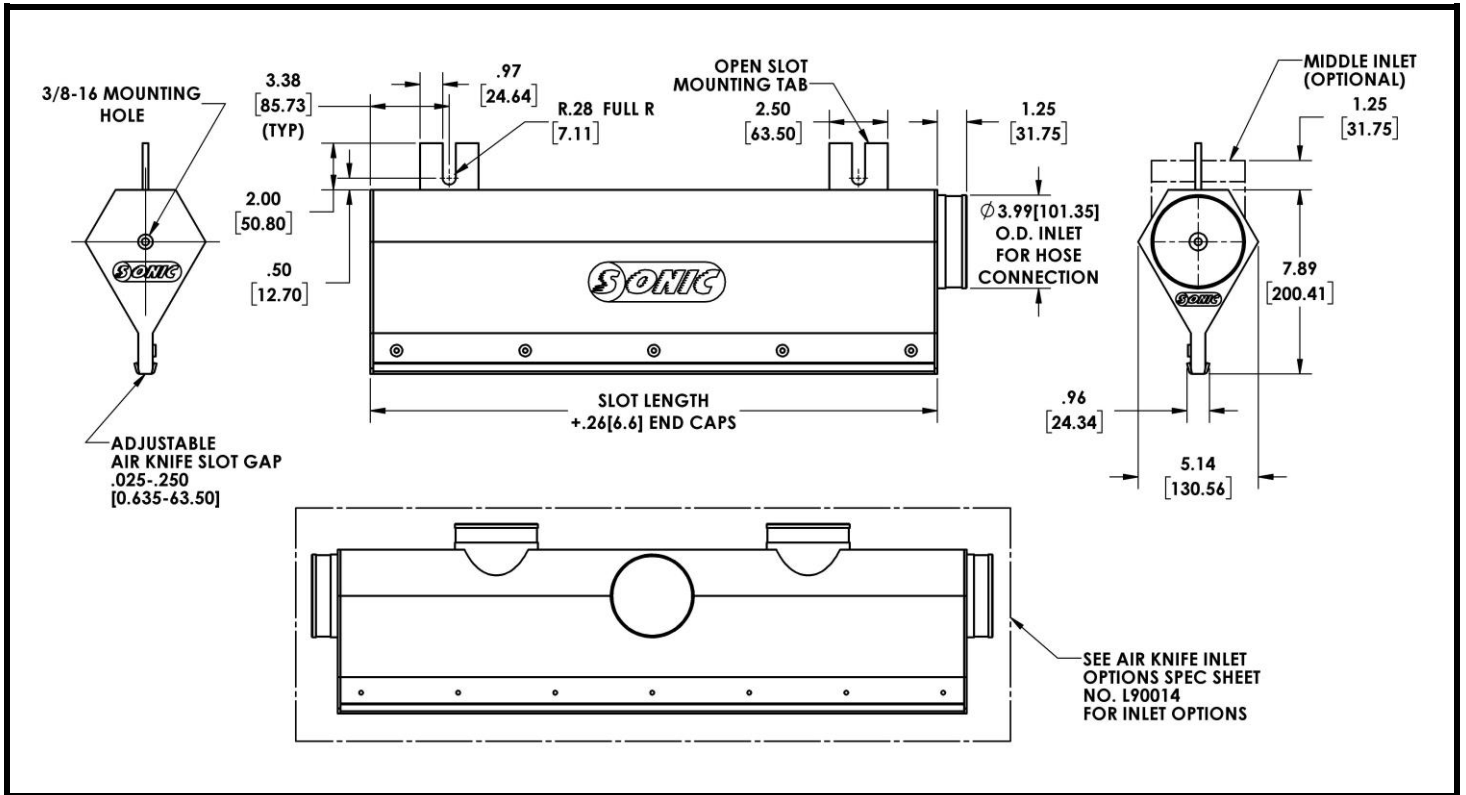
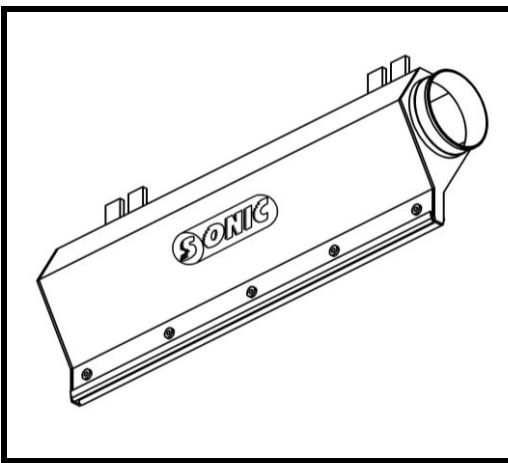

Dimensions in Inches, [ ] are in millimeters

Description	Air Knife-4" X %%" LG Steel	Air Knife-4" X %%" LG S.S.
<b>Sonic Part Number</b>	CALL SONIC	CALL SONIC
<b>Custom Slot Lengths</b>	36.0 to 100.0in [914.4 to 2540.0mm]	36.0 to 100.0in [914.4 to 2540.0mm]
<b>Air Flow Rates</b>	16 cfm/in to 50 cfm/in (297 lps/m to 929 lps/m)	16 cfm/in to 50 cfm/in (297 lps/m to 929 lps/m)
<b>Temperature Range</b>	-40°F to 250°F (-40°C to 120°C)	800°F (427° C)
<b>Material</b>	Body-11 Gauge Carbon Steel Hardware -300 Series S.S.	Body-11 Gauge 300 Series S.S. Hardware -300 Series S.S.
<b>Finish</b>	Powder Painted	Electropolish
<b>Weight (Approx.)</b>	10.5 lbs/ft (15.62 g/mm)	10.5 lbs/ft (15.62 g/mm)



**Product Specification Sheet**

**AIR KNIFE - 6" XE**  
**CARBON STEEL OR STAINLESS STEEL**

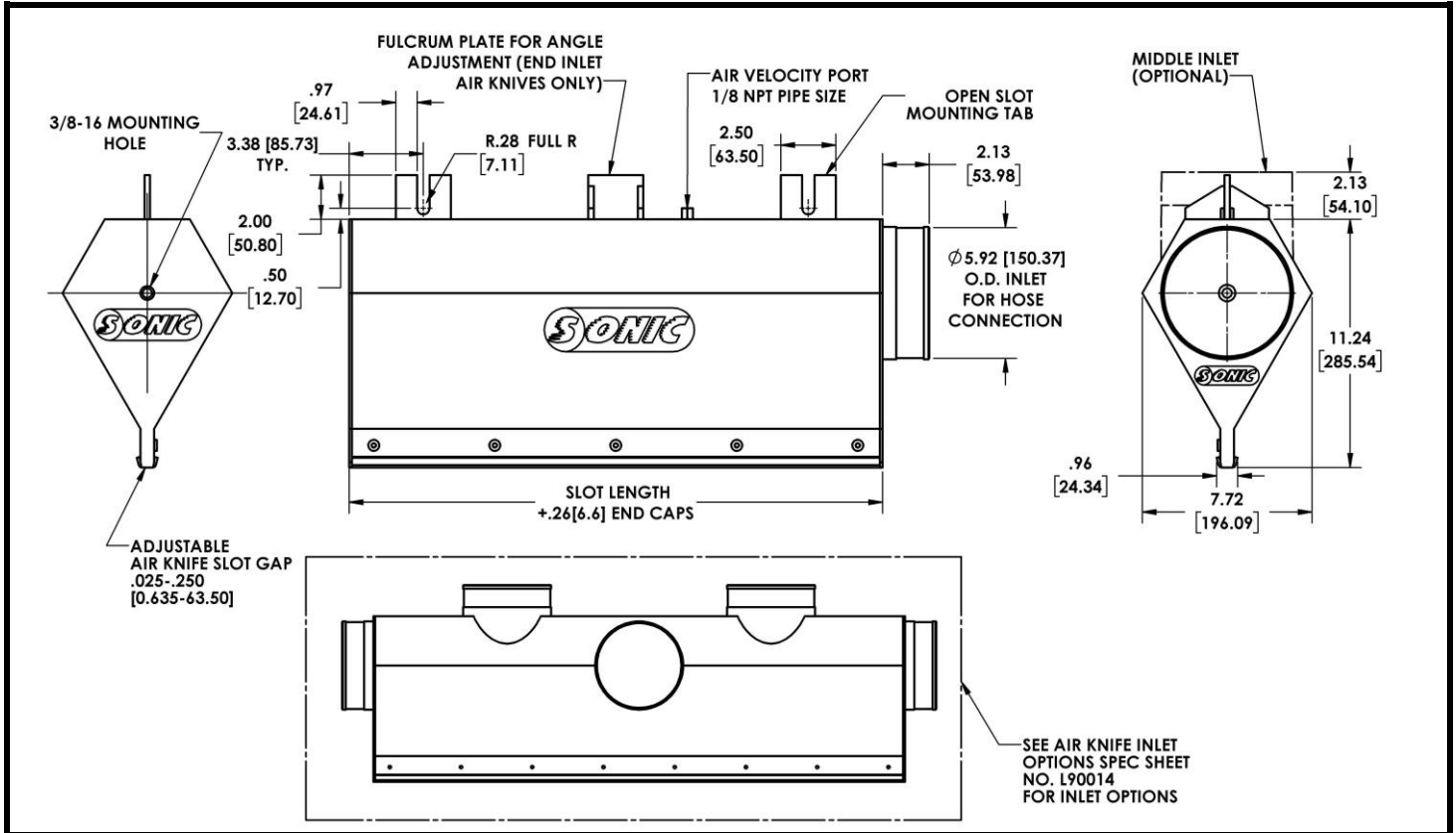
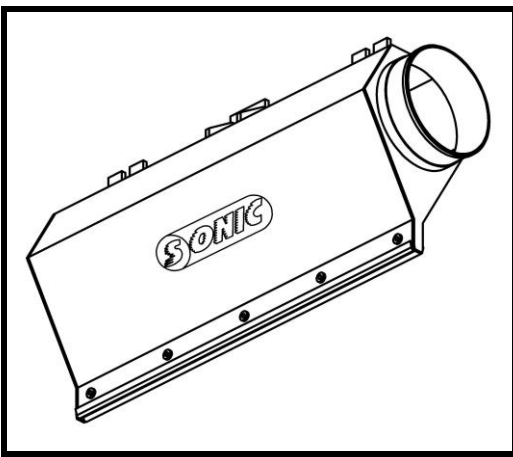

Dimensions in Inches, [ ] are in millimeters

Description	Air Knife-6" X %%" LG Steel	Air Knife-6" X %%" LG S.S.
<b>Sonic Part Number</b>	CALL SONIC	CALL SONIC
<b>Custom Slot Lengths</b>	12.0 to 120.0in [304.8 to 3,048mm]	12.0 to 120.0in [304.8 to 3,048mm]
<b>Air Flow Rates</b>	16 cfm/in to 50 cfm/in (297 lps/m to 929 lps/m)	16 cfm/in to 50 cfm/in (297 lps/m to 929 lps/m)
<b>Temperature Range</b>	-40°F to 400°F (-40°C to 204°C)	800°F (427°C)
<b>Material</b>	Body-11 Gauge Carbon Steel Hardware -300 Series S.S.	Body-11 Gauge 300 Series S.S. Hardware -300 Series S.S.
<b>Finish</b>	Powder Painted	Electropolish
<b>Weight (Approx.)</b>	12.5 lbs/ft (18.60 g/mm)	12.5 lbs/ft (18.60 g/mm)